

US-LT30(A)(B)(BL) SERIES SCREWDRIVERS

EXPLODED VIEW

Optional Silencers



#84 408-088-2
Silencer
Assembly

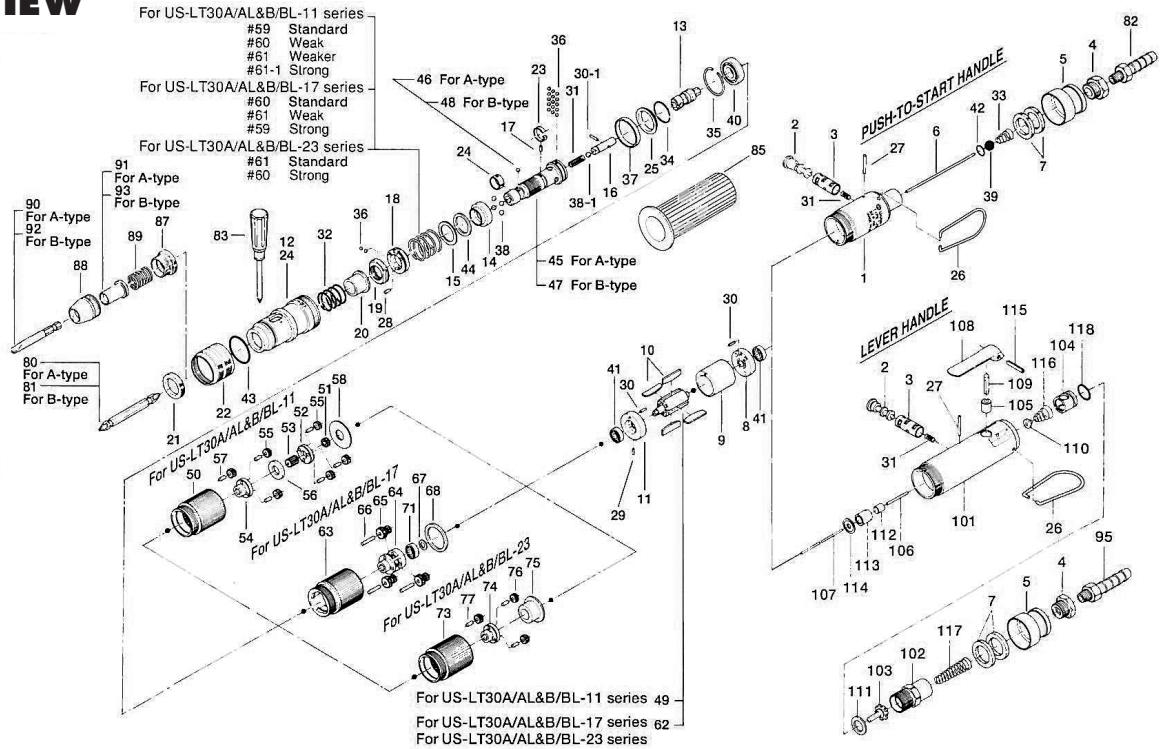

PARTS LIST — FOR REFERENCE ONLY

Index Number	Part Number	Description	Qty.
US-LT30 SERIES PUSH-TO-START HANDLE			
1	471-025-8	Casing	1
2	893-056-1	Reverse Valve (Locking)	1
3	471-211-7	Reverse Valve Bushing	1
4	480-091-8	Air Inlet Bushing	1
5	408-782-1	Exhaust Deflector	1
6	471-104-7	Valve Rod	1
7	471-835-5	Filter (K100)	2
26	401-790-1	Suspension Ring	1
27	972-020-0	Roller Pin (2 x 19.8)	1
31	976-058-0	Spring (4.5 x 11)	2
33	977-157-0	Cone Spring (7 x 11 x 20)	1
39	981-208-0	Ball (5/16)	1
42	990-004-0	O-Ring (P-6)	1
12	471-369-7	Clutch Casing	1

Index Number	Part Number	Description	Qty.
US-LT30L SERIES LEVER HANDLE			
101	469-025-5	Casing	1
4	480-091-8	Air Inlet Bushing	1
102	461-097-6	Air Inlet Connector	1
103	259-100-0	Valve	1
104	461-102-6	Valve Bushing	1
105	553-103-1	Valve Rod Bushing	1
106	970-105-0	Pin (H) (2 x 24)	1
107	462-104-7	Valve Rod	1
108	466-107-5	Valve Lever	1
109	469-114-5	Valve Pin	1
110	259-254-0	Shut-Off Valve	1
111	996-424-0	Packing	1
112	444-106-8	Valve Rod Cap	1
113	461-567-6	Bushing	1
2	893-056-1	Reverse Valve (Locking)	1
3	471-211-7	Reverse Valve Bushing	1
5	408-782-1	Exhaust Deflector	1
7	471-835-5	Filter (K100)	2
114	469-291-5	Rear Plate Spacer	1
26	401-790-1	Suspension Ring	1
27	972-020-0	Roller Pin (2 x 19.8)	1
115	973-118-0	Roll Pin (3 x 18)	1
31	976-058-0	Spring (4.5 x 11)	2
116	977-071-0	Cone Spring (5.5 x 11.5 x 15)	1
117	977-155-0	Cone Spring (7 x 10 x 35)	1
118	990-911-0	O-Ring (SNS-12)	1
24	462-369-7	Clutch Casing	1
37	462-397-7	Gear Casing Flange	1

Index Number	Part Number	Description	Qty.
COMMON PARTS			
8	471-285-7	Rear Plate	1
9	471-286-7	Cylinder	1
10	471-288-0	Blade	4
11	471-289-7	Front Plate	1
13	471-346-5	Cam	1
14	471-375-8	Cam Ring	1
15	471-164-8	Spring Setter	1
16	471-318-5	Pilot Pin	1
17	471-764-7	Notch Pin	1
18	471-562-7	Retainer	1
19	471-257-7	Regulating Screw	1
20	471-351-6	Bit Sleeve	1
21	471-567-6	Bushing	1
22	471-370-7	Clutch Casing Sleeve	1
23	471-670-7	Band	1
24	471-356-7	Bit Band	1
25	462-334-7	Anvil Spacer	1
28	970-091-0	Pin (H) (2 x 4.5)	1
29	973-001-0	Roll Pin (1.5 x 6)	1
30	973-003-0	Roll Pin (1.5 x 8)	2
30-1	969-470-0	Pin (2 x 8)	1
32	976-450-0	Spring (18.5 x 10)	1
34	978-185-0	Snap Ring (19 x 1)	1
35	978-229-0	Snap Ring (23 x 1)	1
36	981-001-0	Ball (3/32)	17
38	981-003-0	Ball (5/32)	4
38-1	981-004-0	Ball (3/16)	1
40	982-901-0	Ball Bearing (6900)	1
41	987-041-0	Mini. Ball Bearing (R1350ZZ)	2
43	990-919-0	O-Ring (SNS-22)	1
44	944-016-0	Back-up Ring (P-16)	1

Index Number	Part Number	Description	Qty.
PARTS FOR US-LT30A & 30AL SERIES			
45	471-319-5	Anvil	1
46	981-003-0	Ball (5/32)	1

Index Number	Part Number	Description	Qty.
PARTS FOR US-LT30B & 30BL SERIES			
47	471-319-2	Anvil	1
48	981-002-0	Ball (1/8)	1

Index Number	Part Number	Description	Qty.
PARTS FOR US-LT30A/AL-11 & 30B/BL-11			
49	471-287-7	Rotor	1
50	471-029-7	Gear Casing	1
51	471-460-7	Rotor Gear	1
52	471-480-7	First Gear Cage	1

Index Number	Part Number	Description	Qty.
53	471-445-7	Middle Gear	1
54	471-485-7	Second Gear Cage	1
55	471-471-7	Second Planet Gear	6
56	471-483-7	Gear Cage Spacer	1
57	972-033-0	Roller Pin (2.5 x 8)	6
58	975-178-0	Spacer (26 x 10 x 1.5)	1
59	976-472-0	Spring (20.6 x 22) Standard	1
60	976-493-0	Spring (20.8 x 22) Weak	1
61	976-471-0	Spring (19.4 x 22) Weaker	1
61-1	976-504-0	Spring (21 x 22) Strong	1

Index Number	Part Number	Description	Qty.
PARTS FOR US-LT30A/AL-17 & 30B/BL-17			
62	471-287-5	Rotor	1
63	471-029-5	Gear Casing	1
64	471-480-5	Gear Cage	1
65	471-470-6	Planet Gear	3
66	972-036-0	Roller Pin (2.5 x 15.8)	3
67	975-009-0	Spacer (9 x 5.2 x 0.3)	1
68	975-188-0	Spacer (26 x 20 x 1.5)	1
71	987-013-0	Mini. Ball Bearing (R1350)	1
60	976-493-0	Spring (20.8 x 22) Standard	1
61	976-471-0	Spring (19.4 x 22) Weak	1
59	976-472-0	Spring (20.6 x 22) Strong	1
62	471-287-5	Rotor	1

Index Number	Part Number	Description	Qty.
PARTS FOR US-LT30A/AL-23 & 30B/BL-23			
73	471-029-7	Gear Casing	1
74	471-480-3	Gear Cage	1
75	471-483-3	Gear Cage Spacer	1
76	471-470-3	Planet Gear	3
77	972-033-0	Roller Pin (2.5 x 8)	3
61	976-471-0	Spring (19.4 x 22) Standard	1
60	976-493-0	Spring (20.8 x 22) Strong	1

Index Number	Part Number	Description	Qty.
ACCESSORIES			
83	939-402-0	Manual Driver No. 2	1
84	408-088-2	Silencer Assembly	1
85	471-083-7	Casing Protector	1

Index Number	Part Number	Description	Qty.
For Slotted Head Bit and Finder (Remove #21 471-567-6 Bushing and use following)			
87	471-082-7	Bit Casing Set Screw	1
88	471-057-7	Bit Casing	1
89	976-330-0	Spring (13.8 x 18 x 0.8)	1
91	917-299-0	Finder for A-type	1
93	917-350-0	Finder for B-type	1

FOOTNOTES

When ordering spare parts, please specify tool type, part number, and description.



10000 SE PINE
PORTLAND, OR 97216
503-254-6600
FAX 503-255-2615