

# UXR-2400SMC OIL-PULSE TOOLS

## EXPLODED VIEW

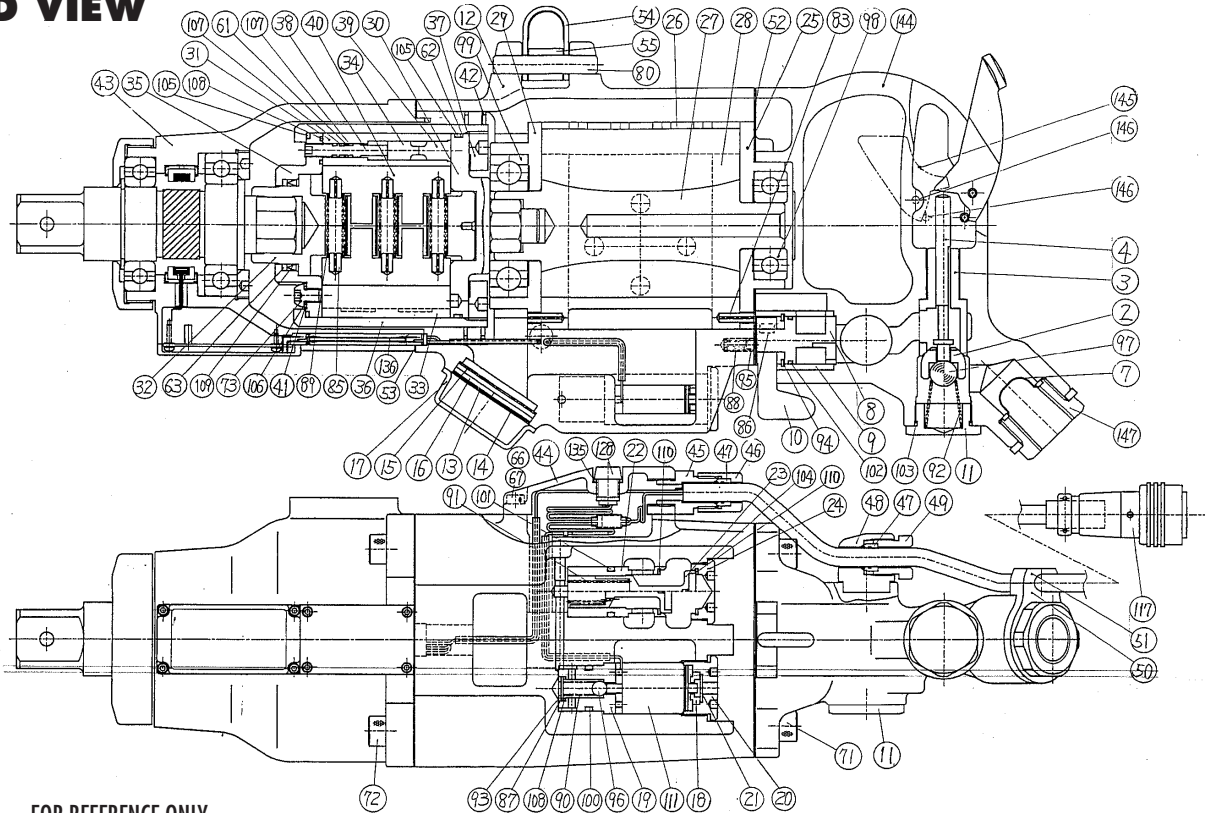

## PARTS LIST — FOR REFERENCE ONLY

| Index Number | Part Number | Description            | Qty. | Index Number | Part Number | Description                           | Qty. | Index Number | Part Number | Description                          | Qty. |
|--------------|-------------|------------------------|------|--------------|-------------|---------------------------------------|------|--------------|-------------|--------------------------------------|------|
| 1            | 166-010-0   | Handle (Out)           | 1    | 44           | 166-035-0   | Casing Connector                      | 1    | 87           | 975-594-0   | Round Plate                          | 1    |
| 2            | 116-100-0   | Valve                  | 1    | 45           | 149-079-2   | Connector                             | 1    | 88           | 976-076-0   | Spring (5 x 19)                      | 1    |
| 3            | 116-103-0   | Valve Rod Bushing      | 1    | 46           | 149-018-2   | Cap                                   | 1    | 89           | 976-798-0   | Spring (7.3 x 56) (0.9) (WPC)        | 3    |
| 4            | 166-104-0   | Valve Rod              | 1    | 47           | 149-562-2   | Stopper                               | 2    | 90           | 976-114-0   | Spring (6 x 18)                      | 1    |
| 5            | 109-107-1   | Throttle Trigger (Out) | 1    | 48           | 166-278-0   | Handle Connector                      | 1    | 91           | 976-509-0   | Spring (10 x 38) (1.0) SUS           | 1    |
| 6            | 518-091-6   | Air Inlet Bushing      | 1    | 49           | 166-082-0   | Connecting Screw                      | 1    | 92           | 977-257-0   | Cone Spring (10 x 15 x 25)           | 1    |
| 7            | 573-835-9   | Filter                 | 1    | 50           | 166-718-0   | Mounting Fixture                      | 1    | 93           | 979-003-0   | Inner Snap Ring (10)                 | 1    |
| 8            | 176-210-5   | Reverse Valve          | 1    | 51           | 166-965-0   | Mounting Plate                        | 1    | 94           | 979-015-0   | Inner Snap Ring (22)                 | 1    |
| 9            | 176-211-5   | Reverse Valve Bushing  | 1    | 52           | 103-850-0   | Rear Packing                          | 1    | 95           | 981-005-0   | Ball (7/32)                          | 1    |
| 10           | 103-212-0   | Reverse Lever          | 1    | 53           | 166-867-0   | Front Casing Packing                  | 1    | 96           | 981-029-0   | Ball (1/4)                           | 1    |
| 11           | 103-243-0   | Regulator Valve Cover  | 2    | 54           | 195-790-9   | Suspension Ring                       | 1    | 97           | 981-032-0   | Ball (7/16)                          | 1    |
| 12           | 166-025-0   | Casing                 | 1    | 55           | 173-796-3   | Suspension Bushing                    | 1    | 98           | 982-204-0   | Ball Bearing (6204)                  | 1    |
| 13           | 194-021-9   | Exhaust Mesh Plate     | 1    | 56           | 116-896-0   | Dead Handle Assembly                  | 1    | 99           | 982-206-0   | Ball Bearing (6206)                  | 1    |
| 14           | 194-042-9   | Silencer               | 1    | 57           | 116-720-0   | Dead Handle                           | 1    | 100          | 990-016-0   | O-Ring (P16)                         | 1    |
| 15           | 194-099-9   | Punch Plate            | 1    | 58           | 116-722-0   | Dead Handle Connector                 | 1    | 101          | 990-016-0   | O-Ring (P16)                         | 1    |
| 16           | 194-835-9   | Filter                 | 2    | 59           | 166-924-0   | Metal Tag                             | 1    | 102          | 990-916-0   | O-Ring (SNS-18)                      | 1    |
| 17           | 103-782-0   | Exhaust Cover          | 1    | 60           | 940-035-0   | Air Hose Nipple (1/2 x 1/2)           | 1    | 103          | 990-918-0   | O-Ring (SNS-20)                      | 2    |
| 18           | 166-120-0   | Valve Packing Spacer   | 1    | 61           | 944-005-0   | Support Ring (4.2 x 6 x 1)            | 1    | 104          | 990-919-0   | O-Ring (SNS-22)                      | 1    |
| 19           | 166-147-0   | Stop Valve Bushing     | 1    | 62           | 944-077-0   | Supporting Ring (77 x 80 x 1)         | 1    | 105          | 990-944-0   | O-Ring (SNS-75)                      | 2    |
| 20           | 166-149-0   | Stop Valve Plug        | 1    | 63           | 944-230-0   | Supporting Ring (33.9 x 39.6 x 1.5)   | 1    | 106          | 990-949-0   | O-Ring (P3) (NOK)                    | 1    |
| 21           | 193-872-6   | Valve Packing          | 1    | 64           | 945-000-0   | Allen Head Bolt (M3 x 8)              | 2    | 107          | 990-972-0   | O-Ring (SNS-4) (NOK)                 | 2    |
| 22           | 166-253-0   | Shut-Off Valve Bushing | 1    | 65           | 945-008-0   | Allen Head Bolt (M4 x 8)              | 4    | 108          | 990-975-0   | O-Ring (SNS-8) (NOK)                 | 2    |
| 23           | 166-254-0   | Shut-Off Valve         | 1    | 66           | 945-010-0   | Allen Head Bolt (M4 x 10)             | 2    | 109          | 995-501-0   | Teflon Seal (P34)                    | 1    |
| 24           | 166-927-0   | Shut-Off Valve Cover   | 1    | 67           | 945-022-0   | Allen Head Bolt (M4 x 22)             | 2    | 110          | 996-436-0   | Urethane Packing (20 x 1.5 x 19)     | 2    |
| 25           | 176-285-5   | Rear Plate             | 1    | 68           | 945-114-0   | Allen Head Bolt (M5 x 14)             | 4    | 111          | 909-967-0   | Solenoid Valve Assembly              | 1    |
| 26           | 176-286-5   | Cylinder               | 1    | 69           | 945-128-0   | Allen Head Bolt (M5 x 28)             | 1    | 117          | 910-256-0   | Joint Cable Assembly                 | 1    |
| 27           | 176-287-5   | Rotor                  | 1    | 70           | 945-318-0   | Allen Head Bolt (M8 x 18)             | 2    | 124          | 909-918-0   | Socket (DF-11-12DC-2C)               | 1    |
| 28           | 176-288-5   | Blade                  | 7    | 71           | 945-322-0   | Allen Head Bolt (M8 x 22)             | 4    | 125          | 909-733-0   | Connector (RF-06)                    | 1    |
| 29           | 176-289-5   | Front Plate            | 1    | 72           | 945-325-0   | Allen Head Bolt (M8 x 25)             | 4    | 126          | 909-707-0   | Shrink Tube (6 x 30)                 | 1    |
| 30           | 176-901-5   | Rear Liner Plate       | 1    | 73           | 945-960-0   | Hexagon Round Head Bolt (M6 x 8)      | 1    | 127          | 909-708-0   | Shrink Tube (8 x 30)                 | 1    |
| 31           | 176-902-5   | Liner                  | 1    | 74           | 952-105-0   | Allen Head Dog Point Screw (M4 x 5)   | 1    | 128          | 909-548-0   | LED Lamp Assembly                    | 1    |
| 32           | 166-319-0   | Anvil                  | 1    | 75           | 953-210-0   | Allen Head Flat Point Screw (M5 x 10) | 1    | 136          | 909-999-0   | Sensor Cable Connector Assembly      | 1    |
| 33           | 176-974-5   | Roller (4.4 x 55)      | 2    | 76           | 961-014-0   | Flat Washer (8 mm)                    | 2    | 140          | 909-921-0   | Sensor Cable Assembly (3F5)          | 1    |
| 34           | 176-440-5   | Driving Blade          | 2    | 77           | 965-006-0   | Helix-Sert (M4 x 1.5D)                | 4    | 144          | 166-010-2   | Handle (In)                          | 1    |
| 35           | 176-904-5   | Front Liner Plate      | 1    | 78           | 965-041-0   | Helix-Sert (M8 x 1.5D)                | 8    | 145          | 085-107-1   | Throttle Trigger                     | 1    |
| 36           | 176-905-5   | Liner Casing           | 1    | 79           | 969-465-0   | Pin (G) (6 x 12)                      | 2    | 146          | 973-124-0   | Roll Pin (3 x 24)                    | 2    |
| 37           | 176-906-5   | Liner Casing Setter    | 1    | 80           | 969-481-0   | Pin (C) (8 x 45)                      | 1    | 148          | 940-126-0   | Air Hose Nipple (NPT 1/2 x 1/2)      | 1    |
| 38           | 194-907-8   | Relief Valve Spindle   | 1    | 81           | 970-508-0   | Pin (H) (6 x 8)                       | 4    | 149          | 904-430-0   | Extension Bar 1" (1 x 90)            | 1    |
| 39           | 194-969-9   | Relief Valve Plug      | 1    | 82           | 973-108-0   | Roll Pin (3 x 8)                      | 2    | 150          | 953-408-0   | Allen Head Flat Point Screw (M8 x 8) | 1    |
| 40           | 194-970-8   | Relief Valve           | 1    | 83           | 973-214-0   | Roll Pin (4 x 14)                     | 2    | 151          | 971-435-0   | Pin (5 x 35)                         | 1    |
| 41           | 188-807-1   | Spacer                 | 1    | 84           | 973-222-0   | Roll Pin (4 x 22)                     | 2    |              |             |                                      |      |
| 42           | 166-754-0   | Clip Guide             | 1    | 85           | 973-308-0   | Roll Pin (5 x 8)                      | 6    |              |             |                                      |      |
| 43           | 851-687-1   | Sensor Casing Assembly | 1    | 86           | 974-008-0   | Key (3 x 8)                           | 1    |              |             |                                      |      |

## FOOTNOTES



10000 SE PINE  
PORTLAND, OR 97216  
503-254-6600  
FA x 503-255-2615

When ordering spare parts, please specify  
tool type, part number, and description.