

MODEL NO.	ANGLE HEAD G.C. ASM	MOTOR ASM
AEN32030CF	28283	25425
AEN32040CF	28284	25426

ITEM NO.	PART NUMBER	QTY.	DESCRIPTION
1	27030	1	HOUSING MOTOR/HANDLE ASSY
2	SEE CHART	1	MOTOR ASM., 7-1, 2000 SERIES GEN III
3	25063	1	LED BOARD ASM.
4	25075	2	SCREW, SHC 4-40X.375, STEEL, BLACK OXIDE
5	25429	2	STAND-OFF, LED, 2000 SERIES
6	SEE CHART	1	ANGLE HEAD FLUSH SOCKET GEAR TRAIN ASM.
7	24272	2	ADAPTOR INSERT
8	24324	2	DOWEL PIN 3/32 Dia x 7/8 LONG
9	25847	1	TID BOARD ASM.
10	24934	2	SCREW, FHC 4-40 X .312, STEEL, BLACK OXIDE
11	20132	1	THROTTLE SPRING
12	26532	1	GEN 3 TRIGGER ASSY, CAST
13	20061	2	SCREW, LEVER
14	25072	1	O-RING, LED LIGHT RING COVER
15	20534	1	3000 SERIAL/MODEL LABEL
16	25058	1	LIGHT RING COVER, LED
17	24679	1	RETAINING RING
18	24683	1	SPRING, REV BUTTON
19	24706	1	REV BUTTON SUB-ASSEMBLY
20	24940	10	SCREW, FHSC 4-40 X .25 LG., STEEL, BLACK OXIDE
21	22141	1	SAFETY LABEL
22	25993	1	O-RING, RING GEAR TO MOTOR, GEN 3B 2000 SERIES
23	25796	1	O-RING, TRANSDUCER
24	27027	1	SCREW, SET 5-40X.188,STEEL,BLK OXIDE
25	26102	1	TOOL CONNECTOR ASM., LEVER
26	26084	1	HANDLE COVER, MFB
27	26083	1	HANDLE COVER
28	25104	1	RETAINING RING
29	25103	1	PIN RETAINER RING
30	25745	5	SCREW, BHSC 4-40 STEEL, BLACK OXIDE
31	27659	1	OUTPUT, FLUSH SOCKET

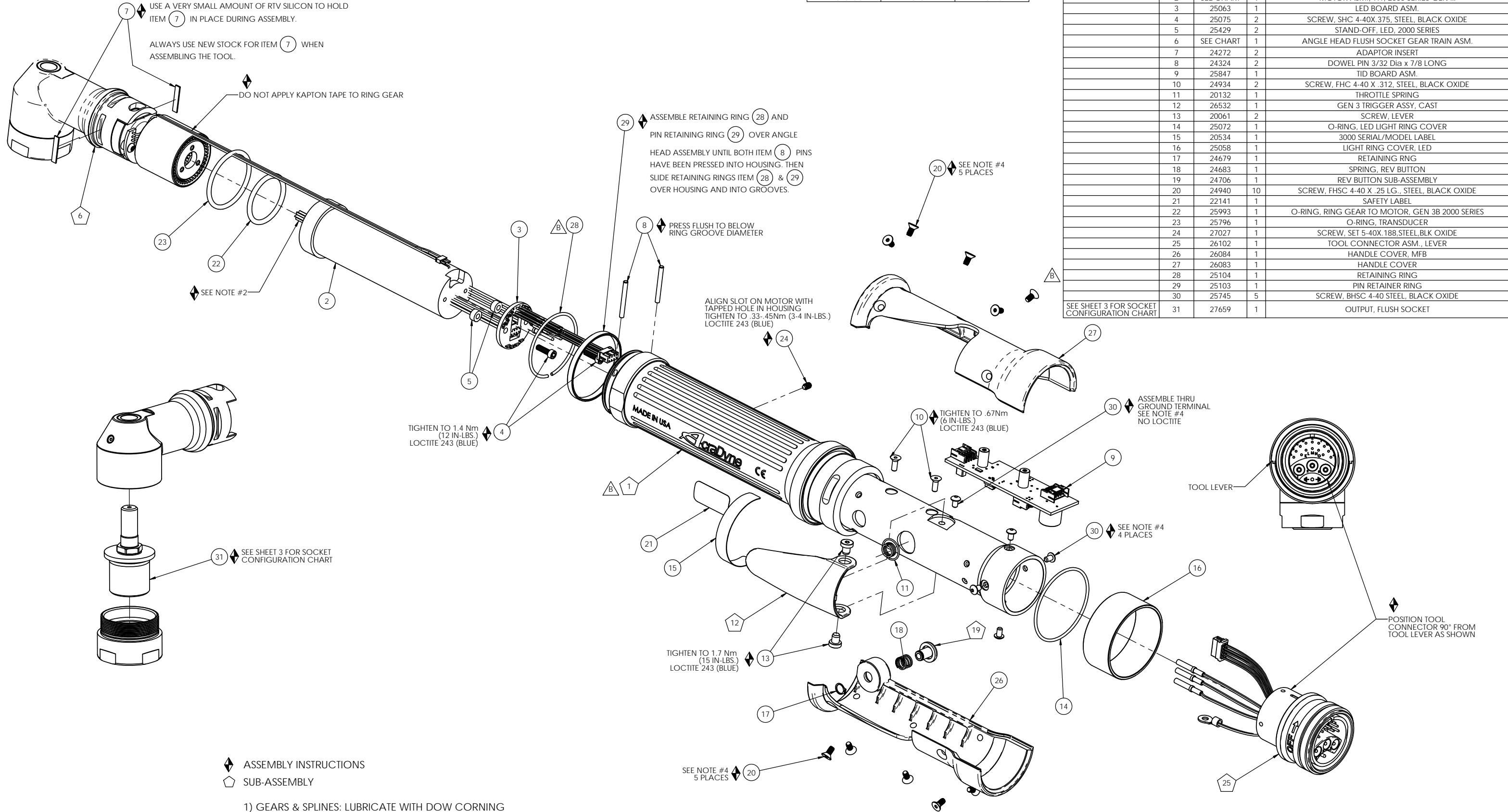

- ◆ ASSEMBLY INSTRUCTIONS
- ◊ SUB-ASSEMBLY

- 1) GEARS & SPLINES: LUBRICATE WITH DOW CORNING MOLYKOTE BR2 PLUS GREASE.
- 2) BEARINGS: LUBRICATE WITH CHEVRON SR1 GREASE
- 3) O-RINGS: LUBRICATE WITH O-RING LUBE
- 4) TIGHTEN TO 1 NM (9 IN-LBS.) LOCTITE 243 (BLUE)

REQUIRED TOOLING
LOCTITE 243 (BLUE)
1/16 HEX WRENCH
5/64 HEX WRENCH
3/32 HEX WRENCH
SNAP RING PLIERS - EXTERNAL TYPE

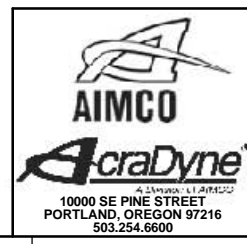

DOCUMENT CONTROL
 PRINTED COPIES OF THIS DOCUMENT ARE CONSIDERED TO BE UNCONTROLLED DOCUMENTS. HOLDERS ARE RESPONSIBLE FOR VERIFYING THE CURRENT REVISION LEVEL WITH PURCHASING OR ENGINEERING PRIOR TO USE OR FABRICATION. THE CONTROLLED VERSION OF THIS DOCUMENT IS ELECTRONICALLY MAINTAINED.

PROPRIETARY AND CONFIDENTIAL
 THIS DRAWING CONTAINS INFORMATION STRICTLY CONFIDENTIAL TO ACRADYNE/AIMCO. IN THE ABSENCE OF EXPRESSED WRITTEN PERMISSION, ACRADYNE/AIMCO HAS LOANED THIS COPY WITH THE MUTUAL UNDERSTANDING THAT (A) IT WILL NOT BE USED FOR ANY PURPOSE OTHER THAN FOR THAT IN WHICH IT WAS PROVIDED, (B) THE DATA CONTAINED HEREIN WILL NOT BE DISCLOSED TO OTHERS, (C) IT WILL NOT BE REPRODUCED, AND (D) IT WILL BE RETURNED TO ACRADYNE/AIMCO IMMEDIATELY UPON DEMAND.

REVISION LEVEL	REVISION RELEASE DATE	DESCRIPTION OF CHANGES MADE TO PART	ECN #	AUTHOR/ APPROVAL

UNLESS OTHERWISE SPECIFIED, DIMENSIONS ARE IN INCHES
 DIMENSIONS AND TOLERANCING PER ANSI Y14.5 SURFACE ROUGHNESS PER ANSI Y14.36

BLOCK TOLERANCING PER DECIMAL:
 .X = ±.030 .XX = ±.010 .XXX = ±.005 .XXXX = ±.0005 ANGLE = ±0°30'

REMOVE BURRS AND SHARP EDGES: R.015 MAX MACHINE SURFACE FINISH: 125 RMS OR BETTER

DRAWINGS AND TECHNICAL DOCUMENTS CONTROLLED BY:
ACRADYNE MECHANICAL ENGINEERING

AEN320_CF FLUSH SOCKET ANGLE NUTRUNNER 2000 SERIES - GEN 3C		
SIZE	PART / DRAWING NUMBER	REVISION
D	AEN320_CF	B
SCALE 1:1	DO NOT SCALE DRAWING	SHEET 1 OF 3

BASE MODEL	DOT	SOCKET BASE	COLUMN 1	SOCKET SIZE	COLUMN 2	EXT.	COLUMN 3	MAGNET	COLUMN 4
AEN32030CF	.	X	DRIVE TYPE	X	HEX SIZE	X	EXTENSION LENGTH	X	MAGNET OPTION
		A	27659 SINGLE HEX	A	10mm	A	0	0	NO MAGNET
		B	27659 DOUBLE HEX	B	11mm	B	3mm	1	WITH MAGNET
		C	27659 SURFACE DRIVE	C	12mm	C	6mm		
				D	13mm	D	9mm		
				E	14mm	E	12mm		
				F	15mm	F	15mm		
				G	16mm	G	18mm		
				H	7/16"	H	21mm		
				I	1/2"	I	24mm		
				J	9/16"	J			
				K	5/8"	K			
				L		L			
				M		M			
				N		N			
				P		P			
				Q		Q			
				R		R			
				S		S			
				T		T			
				U		U			
				V		V			
				W		W			
				X		X			
				Y		Y			
				Z		Z			

****EXAMPLE MODEL NUMBER:** AEN32030CF.CEG0 = SURFACE DRIVE, 14mm HEX, 18mm EXT., NO MAGNET

A

<p>DOCUMENT CONTROL PRINTED COPIES OF THIS DOCUMENT ARE CONSIDERED TO BE UNCONTROLLED DOCUMENTS. HOLDERS ARE RESPONSIBLE FOR VERIFYING THE CURRENT REVISION LEVEL WITH PURCHASING OR ENGINEERING PRIOR TO USE OR FABRICATION. THE CONTROLLED VERSION OF THIS DOCUMENT IS ELECTRONICALLY MAINTAINED.</p> <p>PROPRIETARY AND CONFIDENTIAL THIS DRAWING CONTAINS INFORMATION STRICTLY CONFIDENTIAL TO ACRADYNE/AIMCO. IN THE ABSENCE OF EXPRESSED WRITTEN PERMISSION, ACRADYNE/AIMCO HAS LOANED THIS COPY WITH THE MUTUAL UNDERSTANDING THAT (A) IT WILL NOT BE USED FOR ANY PURPOSE OTHER THAN FOR THAT IN WHICH IT WAS PROVIDED, (B) THE DATA CONTAINED HEREIN WILL NOT BE DISCLOSED TO OTHERS, (C) IT WILL NOT BE REPRODUCED, AND (D) IT WILL BE RETURNED TO ACRADYNE/AIMCO IMMEDIATELY UPON DEMAND.</p>						<p>UNLESS OTHERWISE SPECIFIED, DIMENSIONS ARE IN INCHES DIMENSIONS AND TOLERANCING PER ANSI Y14.5 SURFACE ROUGHNESS PER ANSI Y14.36</p> <p>BLOCK TOLERANCING PER DECIMAL: .X = ±.030 .XX = ±.010 .XXX = ±.005 .XXXX = ±.0005 ANGLE = ±0° 30'</p> <p>REMOVE BURRS AND SHARP EDGES: R.015 MAX MACHINE SURFACE FINISH: 125 RMS OR BETTER</p> <p>DRAWINGS AND TECHNICAL DOCUMENTS CONTROLLED BY: ACRADYNE MECHANICAL ENGINEERING</p>	<p>AEN320__CF FLUSH SOCKET ANGLE NUTRUNNER 2000-SERIES, GEN 3C</p>														
	<table border="1"> <thead> <tr> <th>REVISION LEVEL</th> <th>REVISION RELEASE DATE</th> <th>DESCRIPTION OF CHANGES MADE TO PART</th> <th>ECN #</th> <th>AUTHOR/ APPROVAL</th> </tr> </thead> <tbody> <tr> <td></td> <td></td> <td></td> <td></td> <td></td> </tr> </tbody> </table> <p align="center">REVISION BLOCK</p>	REVISION LEVEL	REVISION RELEASE DATE	DESCRIPTION OF CHANGES MADE TO PART	ECN #		AUTHOR/ APPROVAL						<table border="1"> <tr> <td>SIZE</td> <td>PART / DRAWING NUMBER</td> <td>REVISION</td> </tr> <tr> <td>B</td> <td>AEN320__CF</td> <td>B</td> </tr> </table>	SIZE	PART / DRAWING NUMBER	REVISION	B	AEN320__CF	B	<table border="1"> <tr> <td>SCALE 1:8</td> <td>DO NOT SCALE DRAWING</td> <td>SHEET 3 OF 3</td> </tr> </table>	SCALE 1:8
REVISION LEVEL	REVISION RELEASE DATE	DESCRIPTION OF CHANGES MADE TO PART	ECN #	AUTHOR/ APPROVAL																	
SIZE	PART / DRAWING NUMBER	REVISION																			
B	AEN320__CF	B																			
SCALE 1:8	DO NOT SCALE DRAWING	SHEET 3 OF 3																			

A

10000 SE PINE STREET
PORTLAND, OREGON 97216
503.254.6600

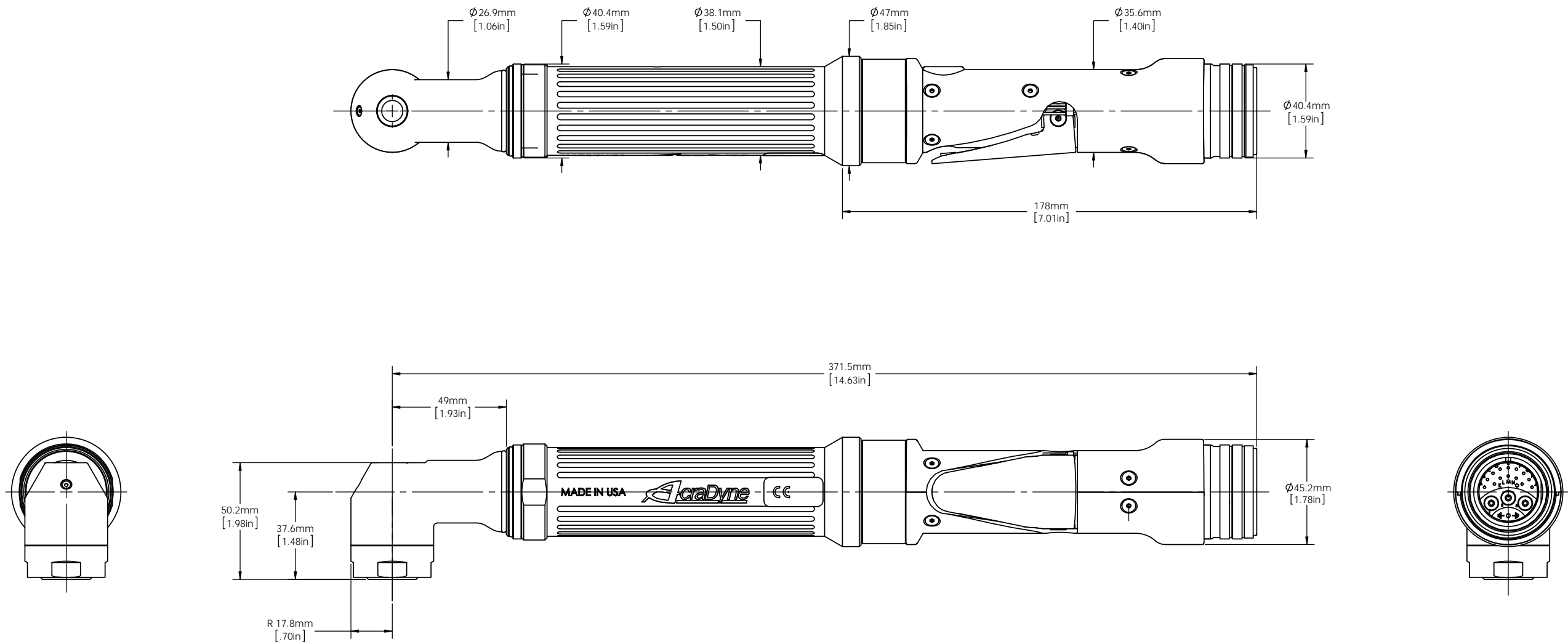

TOOL MODELS
AEN32030CF
AEN32040CF



DOCUMENT CONTROL
 PRINTED COPIES OF THIS DOCUMENT ARE CONSIDERED TO BE UNCONTROLLED DOCUMENTS. HOLDERS ARE RESPONSIBLE FOR VERIFYING THE CURRENT REVISION LEVEL WITH PURCHASING OR ENGINEERING PRIOR TO USE OR FABRICATION. THE CONTROLLED VERSION OF THIS DOCUMENT IS ELECTRONICALLY MAINTAINED.

PROPRIETARY AND CONFIDENTIAL
 THIS DRAWING CONTAINS INFORMATION STRICTLY CONFIDENTIAL TO ACRADYNE/AIMCO. IN THE ABSENCE OF EXPRESSED WRITTEN PERMISSION, ACRADYNE/AIMCO HAS LOANED THIS COPY WITH THE MUTUAL UNDERSTANDING THAT (A) IT WILL NOT BE USED FOR ANY PURPOSE OTHER THAN FOR THAT IN WHICH IT WAS PROVIDED, (B) THE DATA CONTAINED HEREIN WILL NOT BE DISCLOSED TO OTHERS, (C) IT WILL NOT BE REPRODUCED, AND (D) IT WILL BE RETURNED TO ACRADYNE/AIMCO IMMEDIATELY UPON DEMAND.

REVISION LEVEL	REVISION RELEASE DATE	DESCRIPTION OF CHANGES MADE TO PART	ECN #	AUTHOR/ APPROVAL

UNLESS OTHERWISE SPECIFIED, DIMENSIONS ARE IN INCHES
 DIMENSIONS AND TOLERANCING PER ANSI Y14.5
 SURFACE ROUGHNESS PER ANSI Y14.36

BLOCK TOLERANCING PER DECIMAL:
 .X = ±.030 .XX = ±.010 .XXX = ±.005 .XXXX = ±.0005
 ANGLE = ±0° 30'

REMOVE BURRS AND SHARP EDGES: R.015 MAX
 MACHINE SURFACE FINISH: 125 RMS OR BETTER

DRAWINGS AND TECHNICAL DOCUMENTS CONTROLLED BY:
ACRADYNE MECHANICAL ENGINEERING

AEN320_ _CF FLUSH SOCKET ANGLE NUTRUNNER 2000 SERIES - GEN 3C		
SIZE	PART / DRAWING NUMBER	REVISION
D	AEN320_ _CF	B
SCALE 1:1	DO NOT SCALE DRAWING	SHEET 2 OF 3