

| COMMENTS | ITEM NO. | PART NUMBER | QTY. | DESCRIPTION |
|----------|----------|-------------|------|--|
| | 1 | SEE CHART | 1 | CORDLESS PISTOL NUTRUNNER, CORDLESS SERIES |
| | 2 | 31191 | 1 | TRANSDUCER/MOTOR TO CLUTCH ADAPTER |
| | 3 | 31559 | 4 | SCREW, SHC M4 x 0.7MM x 1.4MM, STEEL |
| | 4 | 31192 | 1 | GEARBOX COUPLER SHAFT, 6000 & 7000 SERIES |
| | 5 | 25533 | 2 | BEARING, BALL, Ø19mm X Ø10mm X 5mm |
| | 6 | 31321 | 1 | SNAP RING, EXTERNAL, Ø.375 |
| | 7 | 31193 | 1 | GEARBOX CLUTCH ADAPTER |
| | 8 | 21082 | 4 | SCREW, SHC 8-32 X 3/8, STEEL |
| | 9 | 28291 | 1 | CLUTCH PLATE ASSY, HT AIR TOOLS |
| | 10 | 26488 | 1 | O-RING, MOTOR HOUSING |
| | 11 | 28174 | 4 | SPRING, COMPRESSION |
| | 12 | 20105 | 4 | DETENT BALL |
| | 13 | 27744 | 1 | CLUTCH DETENT PLATE |
| | 14 | 26162 | 4 | SCREW, SHC, 6-32 X 9/16, STEEL |
| | 15 | SEE CHART | 1 | GEARBOX, HT AIR TOOLS, 6000-SERIES |
| | 16 | 29285 | 6 | SCREW, BHSC, 8-32 x .38, TORX HEAD, NYLON PELL-IT, BLK OXIDE |
| | 17 | 26495 | 1 | GEAR CASE COVER |
| | 18 | 26319 | 3 | SCREW, BHSC 6-32 X .188, 18-8 SS |
| | 19 | 26896 | 1 | CHOOSE REACTION BAR |
| | 20 | 26514 | 1 | RETAINING RING, SPIRAL, Ø2.441 X Ø2.105 X .078 |
| | 21 | 30950 | 2 | LABEL, MODEL NUMBER, CORDLESS SERIES |

| MODEL NO. | CORDLESS PISTOL NUTRUNNER | GEARBOX ASM. |
|-------------|---------------------------|--------------|
| ABP-CTA250 | ABP-CTA12-HT | 30776 |
| ABP-CTA450 | ABP-CTA12-HT | 30800 |
| ABP-CTA650 | ABP-CTA12-HT | 28201 |
| ABP-CTA950 | ABP-CTA12-HT | 28205 |
| ABP-CTA250W | ABP-CTA12W-HT | 30776 |
| ABP-CTA450W | ABP-CTA12W-HT | 30800 |
| ABP-CTA650W | ABP-CTA12W-HT | 28201 |
| ABP-CTA950W | ABP-CTA12W-HT | 28205 |

◆ REFERENCE WORK INSTRUCTION W2070 FOR TOOL PROGRAMMING

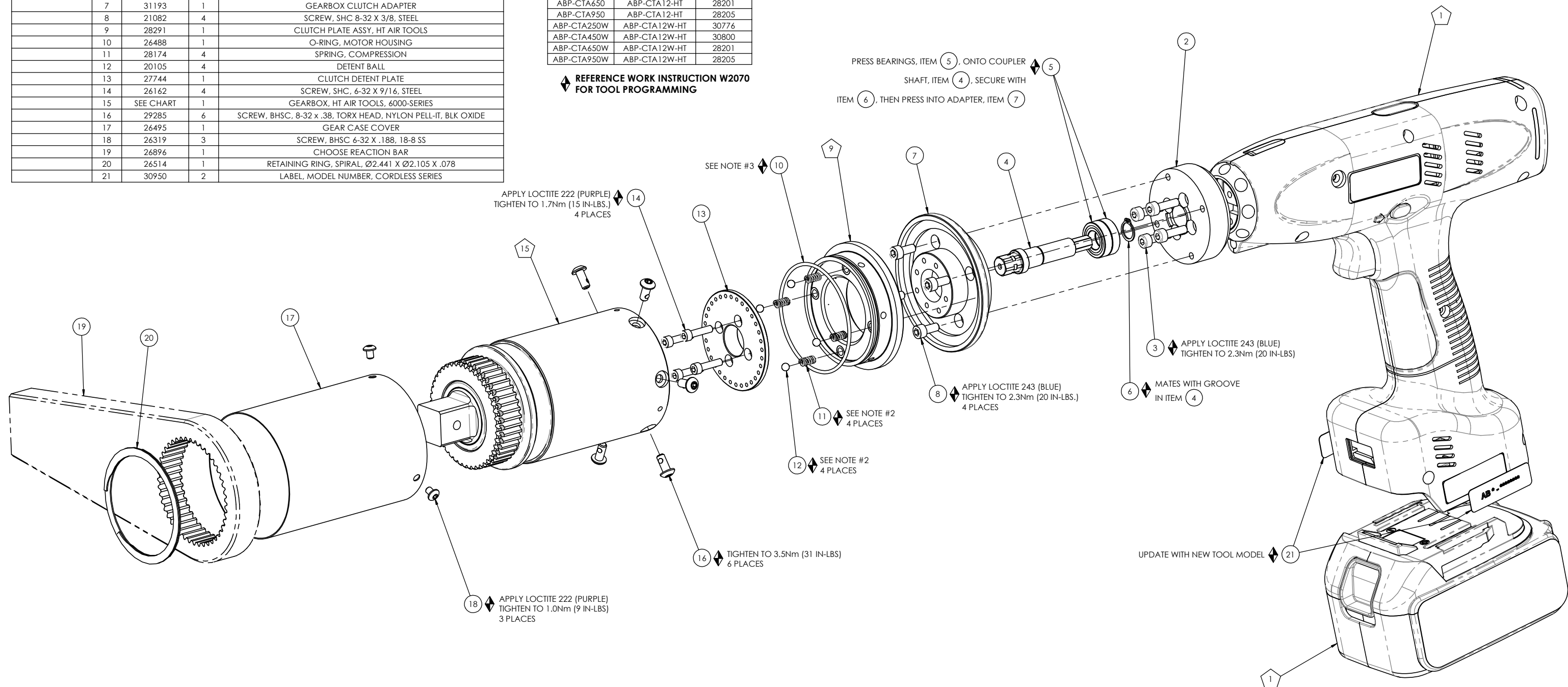

◆ ASSEMBLY INSTRUCTIONS
 ◻ SUB-ASSEMBLY

- GEARS & SPLINES: LUBRICATE WITH DOW CORNING MOLYKOTE BR2 PLUS GREASE.
- BEARINGS: LUBRICATE WITH CHEVRON SR1 GREASE
- O-RINGS: LUBRICATE WITH O-RING LUBE



DOCUMENT CONTROL
 PRINTED COPIES OF THIS DOCUMENT ARE CONSIDERED TO BE UNCONTROLLED DOCUMENTS. HOLDERS ARE RESPONSIBLE FOR VERIFYING THE CURRENT REVISION LEVEL WITH PURCHASING OR ENGINEERING PRIOR TO USE OR FABRICATION. THE CONTROLLED VERSION OF THIS DOCUMENT IS ELECTRONICALLY MAINTAINED.

PROPRIETARY AND CONFIDENTIAL
 THIS DRAWING CONTAINS INFORMATION STRICTLY CONFIDENTIAL TO ACRADYNE/AIMCO. IN THE ABSENCE OF EXPRESSED WRITTEN PERMISSION, ACRADYNE/AIMCO HAS LOANED THIS COPY WITH THE MUTUAL UNDERSTANDING THAT (A) IT WILL NOT BE USED FOR ANY PURPOSE OTHER THAN FOR THAT IN WHICH IT WAS PROVIDED, (B) THE DATA CONTAINED HEREIN WILL NOT BE DISCLOSED TO OTHERS, (C) IT WILL NOT BE REPRODUCED, AND (D) IT WILL BE RETURNED TO ACRADYNE/AIMCO IMMEDIATELY UPON DEMAND.

| REVISION LEVEL | REVISION RELEASE DATE | DESCRIPTION OF CHANGES MADE TO PART | ECN # | AUTHOR/ APPROVAL |
|----------------|-----------------------|-------------------------------------|-------|------------------|
| | | | | |

UNLESS OTHERWISE SPECIFIED, DIMENSIONS ARE IN INCHES
 DIMENSIONS AND TOLERANCING PER ANSI Y14.5 SURFACE ROUGHNESS PER ANSI Y14.36

BLOCK TOLERANCING PER DECIMAL:
 .X = ±.030 .XX = ±.010 .XXX = ±.005 .XXXX = ±.0005
 ANGLE = ±0° 30'

REMOVE BURRS AND SHARP EDGES: R.015 MAX MACHINE SURFACE FINISH: 125 RMS OR BETTER

DRAWINGS AND TECHNICAL DOCUMENTS CONTROLLED BY:
ACRADYNE MECHANICAL ENGINEERING

CORDLESS HT PISTOL NUTRUNNER
 HT CORDLESS, 6000-SERIES

| | | |
|------------------|--|----------------------|
| SIZE D | PART / DRAWING NUMBER ABP-CTA_50 | REVISION A |
| SCALE 1:1 | DO NOT SCALE DRAWING | SHEET 1 OF 2 |

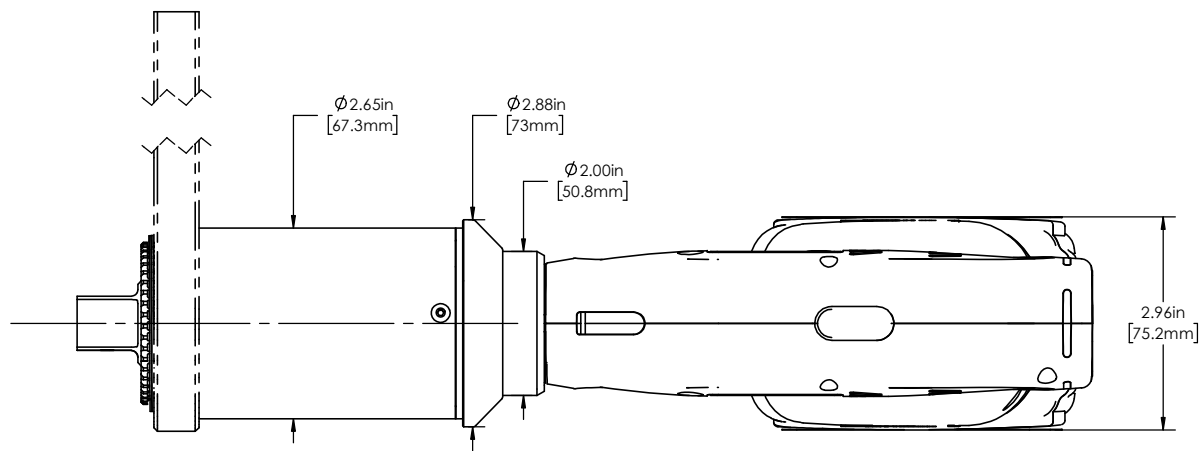

| MODEL NO. |
|-------------|
| ABP-CTA250 |
| ABP-CTA450 |
| ABP-CTA650 |
| ABP-CTA950 |
| ABP-CTA250W |
| ABP-CTA450W |
| ABP-CTA650W |
| ABP-CTA950W |

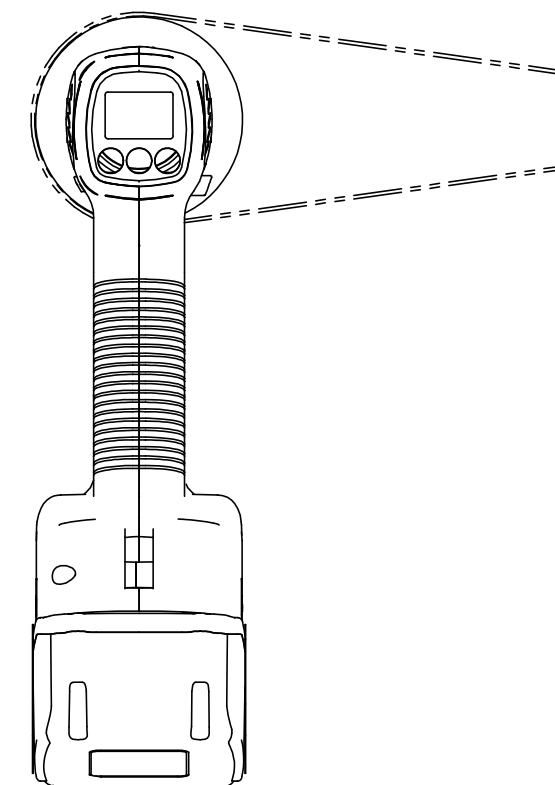
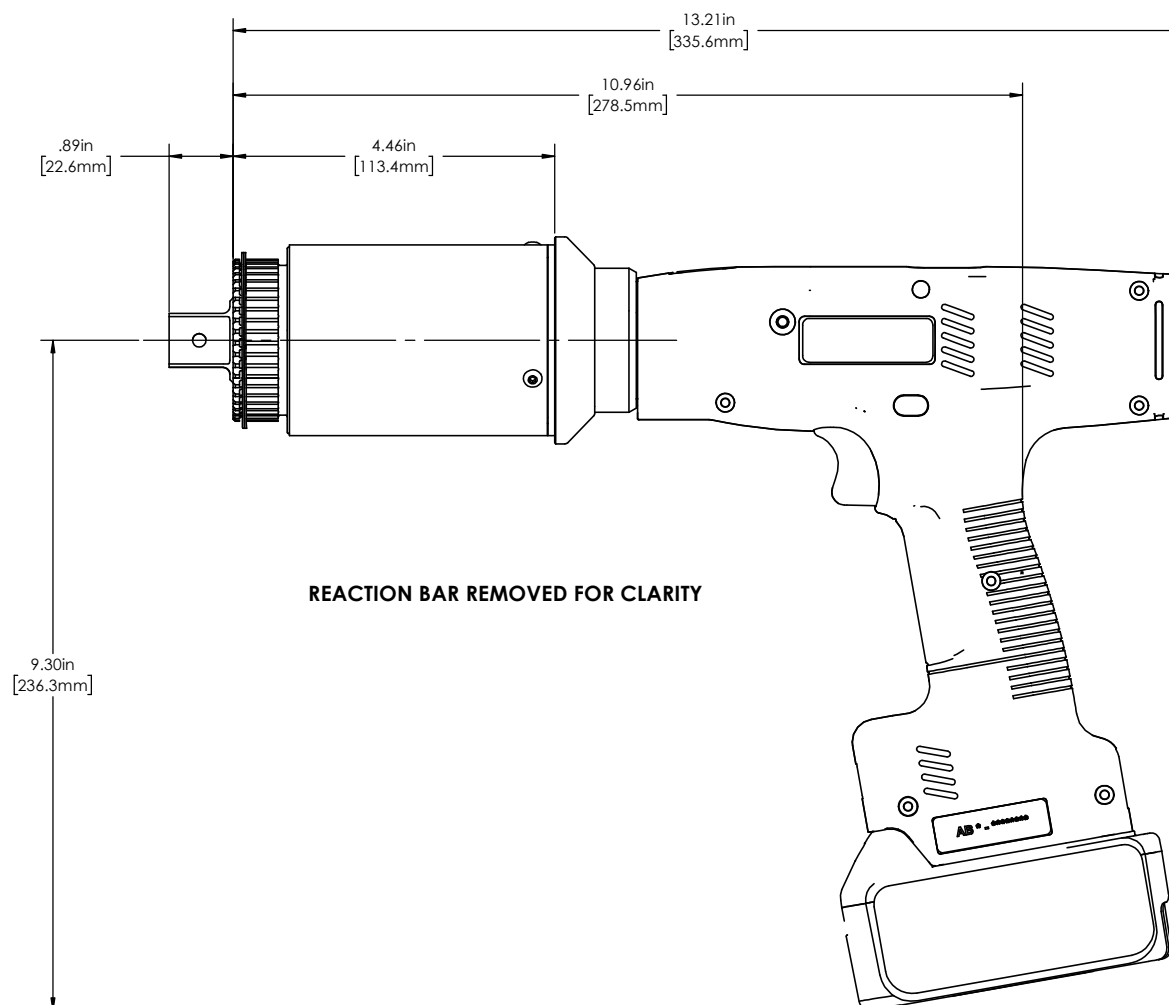
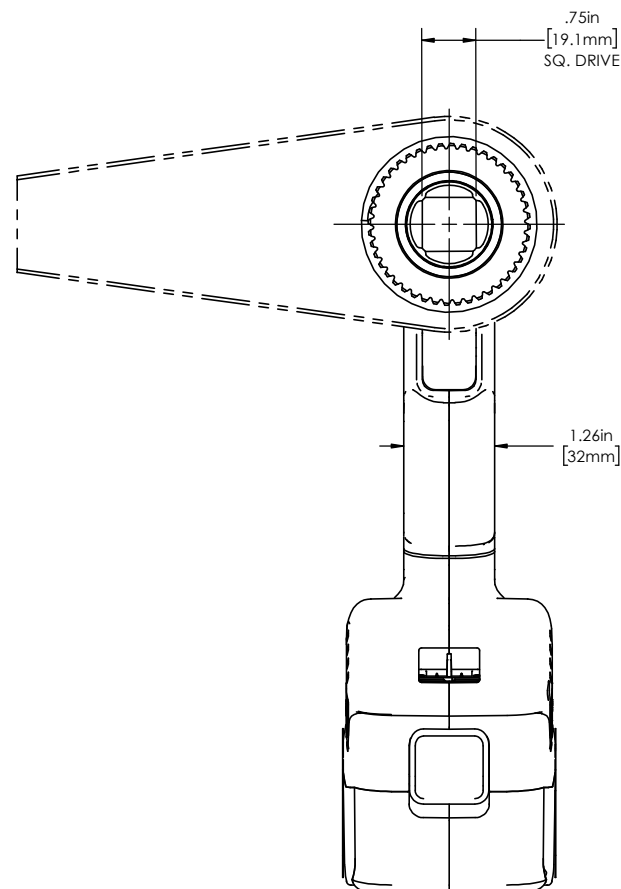

DOCUMENT CONTROL
 PRINTED COPIES OF THIS DOCUMENT ARE CONSIDERED TO BE UNCONTROLLED DOCUMENTS. HOLDERS ARE RESPONSIBLE FOR VERIFYING THE CURRENT REVISION LEVEL WITH PURCHASING OR ENGINEERING PRIOR TO USE OR FABRICATION. THE CONTROLLED VERSION OF THIS DOCUMENT IS ELECTRONICALLY MAINTAINED.

PROPRIETARY AND CONFIDENTIAL
 THIS DRAWING CONTAINS INFORMATION STRICTLY CONFIDENTIAL TO ACRADYNE/AIMCO. IN THE ABSENCE OF EXPRESSED WRITTEN PERMISSION, ACRADYNE/AIMCO HAS LOANED THIS COPY WITH THE MUTUAL UNDERSTANDING THAT (A) IT WILL NOT BE USED FOR ANY PURPOSE OTHER THAN FOR THAT IN WHICH IT WAS PROVIDED, (B) THE DATA CONTAINED HEREIN WILL NOT BE DISCLOSED TO OTHERS, (C) IT WILL NOT BE REPRODUCED, AND (D) IT WILL BE RETURNED TO ACRADYNE/AIMCO IMMEDIATELY UPON DEMAND.

| REVISION LEVEL | REVISION RELEASE DATE | DESCRIPTION OF CHANGES MADE TO PART | ECN # | AUTHOR/ APPROVAL |
|----------------|-----------------------|-------------------------------------|-------|------------------|
| | | | | |

REVISION BLOCK

UNLESS OTHERWISE SPECIFIED, DIMENSIONS ARE IN INCHES
 DIMENSIONS AND TOLERANCING PER ANSI Y14.5
 SURFACE ROUGHNESS PER ANSI Y14.36

BLOCK TOLERANCING PER DECIMAL:
 .X = ±.030 .XX = ±.010 .XXX = ±.005 .XXXX = ±.0005
 ANGLE = ±0° 30'

REMOVE BURRS AND SHARP EDGES: R.015 MAX
 MACHINE SURFACE FINISH: 125 RMS OR BETTER

DRAWINGS AND TECHNICAL DOCUMENTS CONTROLLED BY:
ACRADYNE MECHANICAL ENGINEERING

CORDLESS HT PISTOL NUTRUNNER
 HT CORDLESS, 6000-SERIES

| SIZE | PART / DRAWING NUMBER | REVISION |
|----------|-----------------------|----------|
| D | ABP-CTA_50 | A |

SCALE 1:1 DO NOT SCALE DRAWING SHEET 2 OF 2