

◆ ASSEMBLY INSTRUCTIONS

◇ SUB-ASSEMBLY

- 1) GEARS & SPLINES: LUBRICATE WITH DOW CORNING MOLYKOTE BR2 PLUS GREASE.
- 2) BEARINGS: LUBRICATE WITH CHEVRON SR1 GREASE
- 3) O-RINGS: LUBRICATE WITH O-RING LUBE

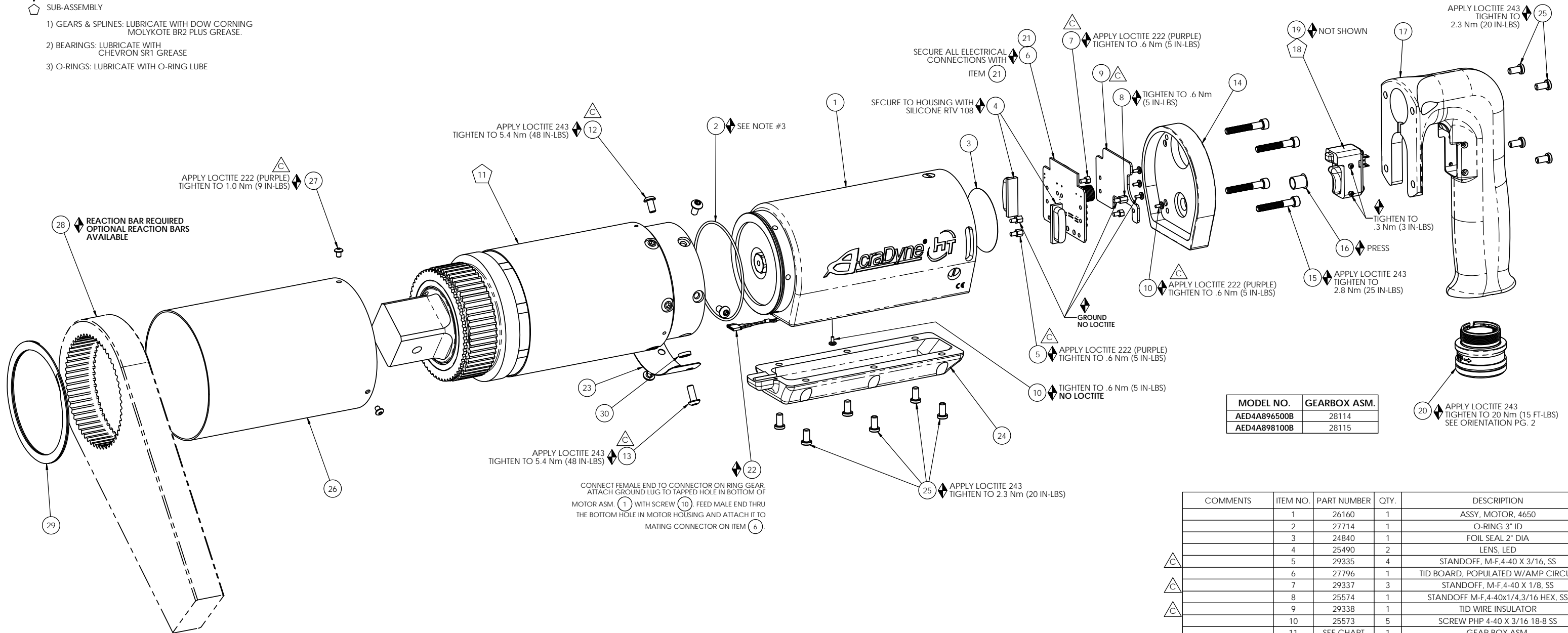

MODEL NO.	GEARBOX ASM.
AED4A896500B	28114
AED4A898100B	28115

COMMENTS	ITEM NO.	PART NUMBER	QTY.	DESCRIPTION
	1	26160	1	ASSY, MOTOR, 4650
	2	27714	1	O-RING 3" ID
	3	24840	1	FOIL SEAL 2" DIA
	4	25490	2	LENS, LED
△	5	29335	4	STANDOFF, M-F, 4-40 X 3/16, SS
	6	27796	1	TID BOARD, POPULATED W/AMP CIRCUIT
△	7	29337	3	STANDOFF, M-F, 4-40 X 1/8, SS
	8	25574	1	STANDOFF M-F, 4-40x1/4, 3/16 HEX, SS
△	9	29338	1	TID WIRE INSULATOR
	10	25573	5	SCREW PHP 4-40 X 3/16 18-8 SS
	11	SEE CHART	1	GEAR BOX ASM.
△	12	29279	4	SCREW, BHSC, TORX, 10-32 x 3/8, STEEL
△	13	29284	2	SCREW, BHSC, TORX, 10-32 X 1/2, STEEL
	14	25225	1	END GRIP CAP, HT TOOLS
	15	25568	4	SHC 10-32 x 1.25 BLK OXIDE
	16	25579	1	PLUG 3/8"
	17	25229	1	AXIAL HANDLE, HT TOOLS
	18	25212	1	SWITCH SUB-ASSEMBLY
	NOT SHOWN	25582	1	TRIGGER CABLE
	20	25505	1	TOOL CONNECTOR ASM HERC PISTOL
NOT SHOWN	21	28257	A/R	CABLE TIE, 1.65MM W X 71MM LG
	22	28211	1	(4) LINE MALE/FEMALE JUMPER ASM.
	23	28230	1	RING GEAR SLEEVE, NON-CLUTCHED, 8100Nm
	24	25231	1	TRAY, WIRE, END GRIP
	25	25569	10	SCREW LHCS 10-32 X 3/8 18-8 SS
	26	26636	1	GEAR CASE COVER
	27	26319	3	SCREW, BHSC 6-32 X .188, 18-8 SS
	28	26899	1	CHOOSE REACTION BAR
	29	26436	1	RETAINING RING, SPIRAL, Ø3.833 X Ø3.293 X .111
	30	25564	2	WASHER SHIM .093THK .25ID .375OD



**DOCUMENT CONTROL**  
 PRINTED COPIES OF THIS DOCUMENT ARE CONSIDERED TO BE UNCONTROLLED DOCUMENTS. HOLDERS ARE RESPONSIBLE FOR VERIFYING THE CURRENT REVISION LEVEL WITH PURCHASING OR ENGINEERING PRIOR TO USE OR FABRICATION. THE CONTROLLED VERSION OF THIS DOCUMENT IS ELECTRONICALLY MAINTAINED.

**PROPRIETARY AND CONFIDENTIAL**  
 THIS DRAWING CONTAINS INFORMATION STRICTLY CONFIDENTIAL TO ACRADYNE/AIMCO. IN THE ABSENCE OF EXPRESSED WRITTEN PERMISSION, ACRADYNE/AIMCO HAS LOANED THIS COPY WITH THE MUTUAL UNDERSTANDING THAT (A) IT WILL NOT BE USED FOR ANY PURPOSE OTHER THAN FOR THAT IN WHICH IT WAS PROVIDED, (B) THE DATA CONTAINED HEREIN WILL NOT BE DISCLOSED TO OTHERS, (C) IT WILL NOT BE REPRODUCED, AND (D) IT WILL BE RETURNED TO ACRADYNE/AIMCO IMMEDIATELY UPON DEMAND.

**UNLESS OTHERWISE SPECIFIED, DIMENSIONS ARE IN INCHES**  
 DIMENSIONS AND TOLERANCING PER ANSI Y14.5 SURFACE ROUGHNESS PER ANSI Y14.36

**BLOCK TOLERANCING PER DECIMAL:**  
 .X = ±.030 .XX = ±.010 .XXX = ±.005 .XXXX = ±.0005 ANGLE = ±0°30'

REMOVE BURRS AND SHARP EDGES: R.015 MAX MACHINE SURFACE FINISH: 125 RMS OR BETTER

DRAWINGS AND TECHNICAL DOCUMENTS CONTROLLED BY:  
**ACRADYNE MECHANICAL ENGINEERING**

**AED4A89\_\_B**  
**"D" HANDLE NUTRUNNER**  
 8000 SERIES

SIZE <b>D</b>	PART / DRAWING NUMBER <b>AED4A89__B</b>	REVISION <b>C</b>
SCALE 2:3	DO NOT SCALE DRAWING	SHEET 1 OF 2

REVISION BLOCK

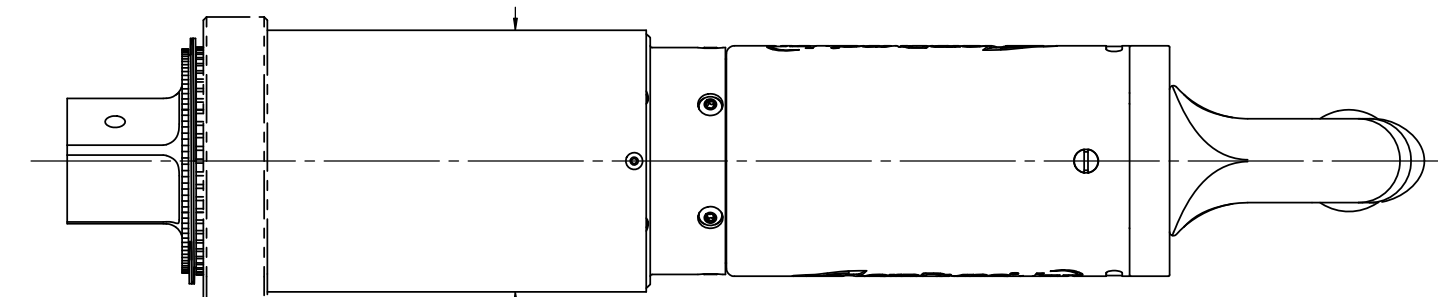

Ø103.8mm  
[4.09in]

REACTION BAR GEOMETRY  
TO CHANGE DEPENDING  
ON REACTION BAR CHOSEN

45.6mm  
[1.80in]

216mm  
[8.51in]

391.9mm  
[15.43in]

95.8mm  
[3.77in]

33.8mm  
[1.33in]

28.3mm  
[1.11in]

REACTION BAR REMOVED  
FOR CLARITY

64.8mm  
[2.55in]

137.9mm  
[5.43in]

25.7mm  
[1.01in]

1 1/2"  
SQUARE DRIVE

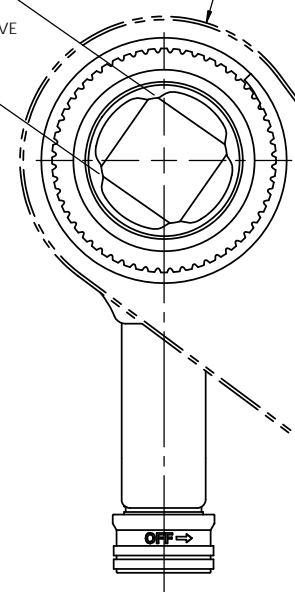

AcraDyne LT

MODEL NO.
AED4A896500B
AED4A898100B

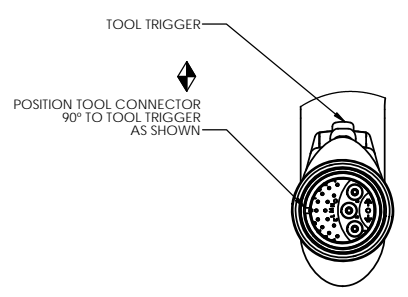

AIMCO  
AcraDyne  
10000 SE PINE STREET  
PORTLAND, OREGON 97216  
503.254.6600

**DOCUMENT CONTROL**  
PRINTED COPIES OF THIS DOCUMENT ARE CONSIDERED TO BE UNCONTROLLED DOCUMENTS. HOLDERS ARE RESPONSIBLE FOR VERIFYING THE CURRENT REVISION LEVEL WITH PURCHASING OR ENGINEERING PRIOR TO USE OR FABRICATION. THE CONTROLLED VERSION OF THIS DOCUMENT IS ELECTRONICALLY MAINTAINED.

**PROPRIETARY AND CONFIDENTIAL**  
THIS DRAWING CONTAINS INFORMATION STRICTLY CONFIDENTIAL TO ACRADYNE/AIMCO. IN THE ABSENCE OF EXPRESSED WRITTEN PERMISSION, ACRADYNE/AIMCO HAS LOANED THIS COPY WITH THE MUTUAL UNDERSTANDING THAT (A) IT WILL NOT BE USED FOR ANY PURPOSE OTHER THAN FOR THAT IN WHICH IT WAS PROVIDED, (B) THE DATA CONTAINED HEREIN WILL NOT BE DISCLOSED TO OTHERS, (C) IT WILL NOT BE REPRODUCED, AND (D) IT WILL BE RETURNED TO ACRADYNE/AIMCO IMMEDIATELY UPON DEMAND.

REVISION BLOCK	
----------------	--

UNLESS OTHERWISE SPECIFIED,  
DIMENSIONS ARE IN INCHES  
DIMENSIONS AND TOLERANCING PER ANSI Y14.5  
SURFACE ROUGHNESS PER ANSI Y14.36

**BLOCK TOLERANCING PER DECIMAL:**  
.X = ±.030 .XX = ±.010 .XXX = ±.005 .XXXX = ±.0005  
ANGLE = ±0° 30'

REMOVE BURRS AND SHARP EDGES: R.015 MAX  
MACHINE SURFACE FINISH: 125 RMS OR BETTER

DRAWINGS AND TECHNICAL DOCUMENTS CONTROLLED BY:  
ACRADYNE MECHANICAL ENGINEERING

**"D" HANDLE NUTRUNNER  
8000 SERIES**

SIZE	PART / DRAWING NUMBER	REVISION
D	AED4A89_ _ _ B	C

SCALE: 2:3 DO NOT SCALE DRAWING SHEET 2 OF 2