

COMMENTS	ITEM NO.	PART NUMBER	QTY.	DESCRIPTION
	1	26212	1	MOTOR ASM., 7000 SERIES
	2	26227	1	O-RING, MOTOR HOUSING
	3	25574	5	STANDOFF M-F, 4-40x1/4, 3/16 HEX, SS
	4	27727	1	TID BOARD, POPULATED W/AMP
	5	25573	5	SCREW PHP 4-40 X 3/16 18-8 SS
	6	SEE CHART	1	GEAR BOX ASM.
	7	26299	1	O-RING, PINION
	8	29279	6	SCREW, BHSC, TORX, 10-32 x 3/8, STEEL
	9	20534	1	3000 SERIAL/MODEL LABEL
	10	26226	1	O-RING, LED COVER
	11	26223	1	LED COVER
	12	26277	1	END CAP, "J" HANDLE
	13	26228	4	SCREW, BHSC 10-32X1.50, STEEL, BLACK OXIDE
	14	26280	1	TOOL CONNECTOR ASM., "J" HANDLE
	15	25745	4	SCREW, BHSC 4-40 STEEL, BLACK OXIDE
	16	28211	1	(4) LINE MALE/FEMALE JUMPER ASM.
	17	26525	1	PLUG 5/16"
	18	26297	1	TRAY, WIRE, "D" & LEVER HANDLE
	19	26206	6	SCREW, BHSC 10-32 X .375, STEEL
	20	SEE CHART	1	GEAR CASE COVER
	21	26319	3	SCREW, BHSC 6-32 X .188, 18-8 SS
	22	26243	1	RETAINING RING, SPIRAL, Ø2.864 X Ø2.464 X .078
	23	26897	1	CHOOSE REACTION BAR
NOT SHOWN	24	27464	A/R	TWISTED WAXED LINEN TWINE
	25	29336	1	TID BOARD WIRE INSULATOR
	26	29337	3	STANDOFF, M-F, 4-40 X 1/8, SS

TOOL MODEL	GEAR BOX ASM.	GEAR CASE COVER
AEF4A771200B	28110	26298
AEF4A773000B	28111	26295

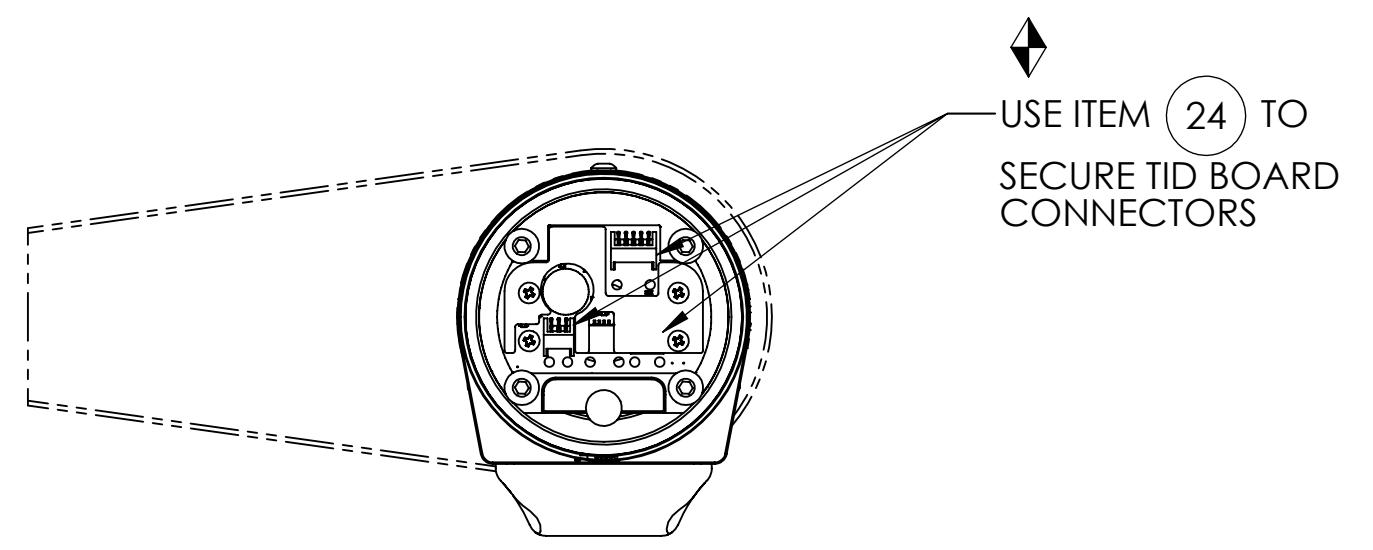

END CAP AND TOOL CONNECTOR REMOVED FOR CLARITY

- ◆ ASSEMBLY INSTRUCTIONS
- ◻ SUB-ASSEMBLY

- 1) GEARS & SPLINES: LUBRICATE WITH DOW CORNING MOLYKOTE BR2 PLUS GREASE.
- 2) BEARINGS: LUBRICATE WITH CHEVRON SR1 GREASE
- 3) O-RINGS: LUBRICATE WITH O-RING LUBE



**DOCUMENT CONTROL**  
 PRINTED COPIES OF THIS DOCUMENT ARE CONSIDERED TO BE UNCONTROLLED DOCUMENTS. HOLDERS ARE RESPONSIBLE FOR VERIFYING THE CURRENT REVISION LEVEL WITH PURCHASING OR ENGINEERING PRIOR TO USE OR FABRICATION. THE CONTROLLED VERSION OF THIS DOCUMENT IS ELECTRONICALLY MAINTAINED.

**PROPRIETARY AND CONFIDENTIAL**  
 THIS DRAWING CONTAINS INFORMATION STRICTLY CONFIDENTIAL TO ACRADYNE/AIMCO. IN THE ABSENCE OF EXPRESSED WRITTEN PERMISSION, ACRADYNE/AIMCO HAS LOANED THIS COPY WITH THE MUTUAL UNDERSTANDING THAT (A) IT WILL NOT BE USED FOR ANY PURPOSE OTHER THAN FOR THAT IN WHICH IT WAS PROVIDED, (B) THE DATA CONTAINED HEREIN WILL NOT BE DISCLOSED TO OTHERS, (C) IT WILL NOT BE REPRODUCED, AND (D) IT WILL BE RETURNED TO ACRADYNE/AIMCO IMMEDIATELY UPON DEMAND.

REVISION LEVEL	REVISION RELEASE DATE	DESCRIPTION OF CHANGES MADE TO PART	ECN #	AUTHOR/ APPROVAL
REVISION BLOCK				

UNLESS OTHERWISE SPECIFIED, DIMENSIONS ARE IN INCHES  
 DIMENSIONS AND TOLERANCING PER ANSI Y14.5  
 SURFACE ROUGHNESS PER ANSI Y14.36

**BLOCK TOLERANCING PER DECIMAL:**  
 .X = ±.030 .XX = ±.010 .XXX = ±.005 .XXXX = ±.0005  
 ANGLE = ±0° 30'

REMOVE BURRS AND SHARP EDGES: R.015 MAX  
 MACHINE SURFACE FINISH: 125 RMS OR BETTER

DRAWINGS AND TECHNICAL DOCUMENTS CONTROLLED BY:  
**ACRADYNE MECHANICAL ENGINEERING**

**AEF4A77\_\_B**  
**FIXTURED NUTRUNNER**  
**7000 SERIES**

SIZE	PART / DRAWING NUMBER	REVISION
<b>D</b>	<b>AEF4A77__B</b>	<b>A</b>

SCALE: 1:2    DO NOT SCALE DRAWING    SHEET 1 OF 2

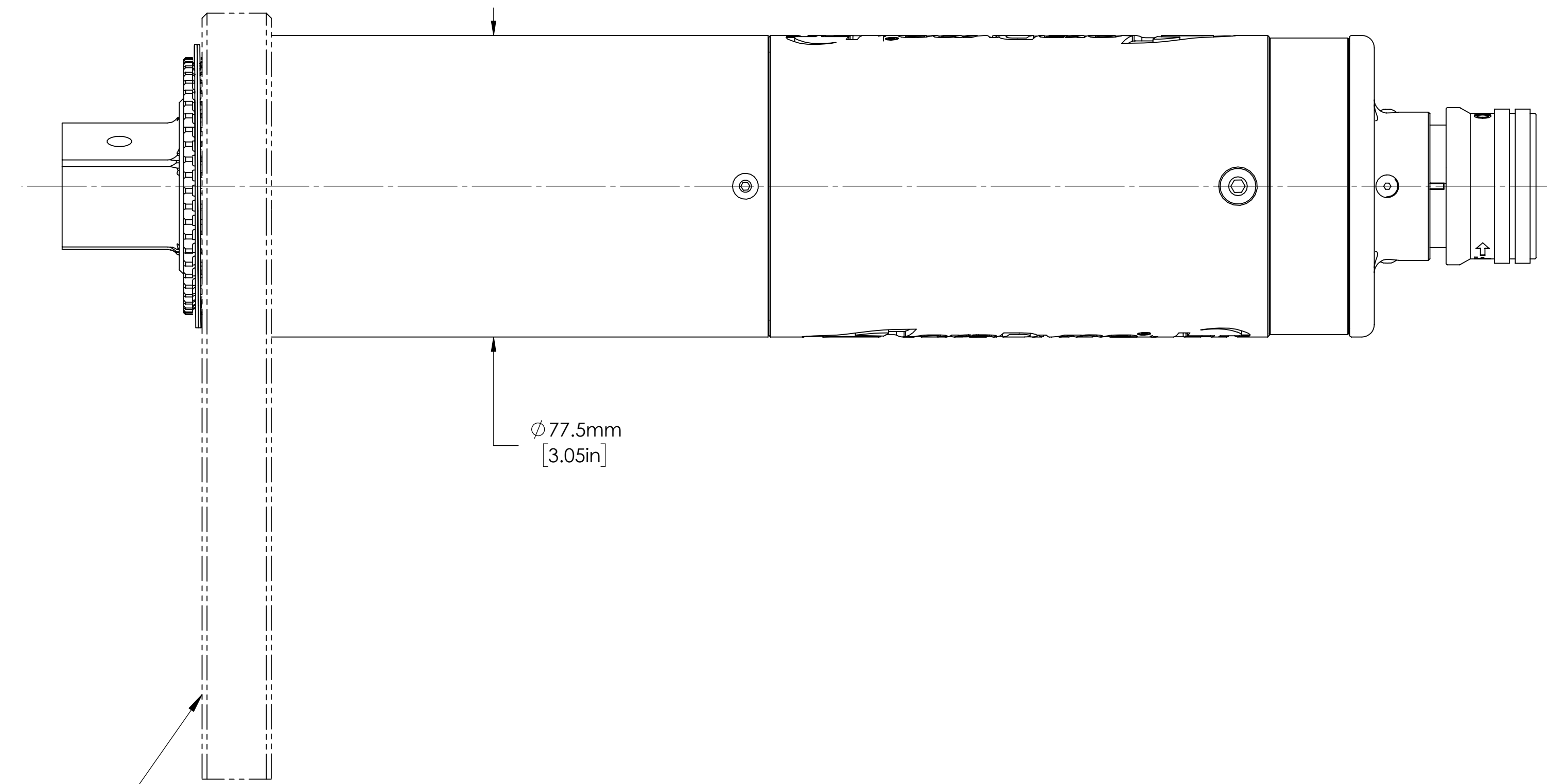

<b>MODEL NO.</b>
<b>AEF4A771200B</b>
<b>AEF4A773000B</b>

**NOTE:**  
REACTION BAR GEOMETRY  
TO CHANGE DEPENDING  
ON REACTION BAR CHOSEN

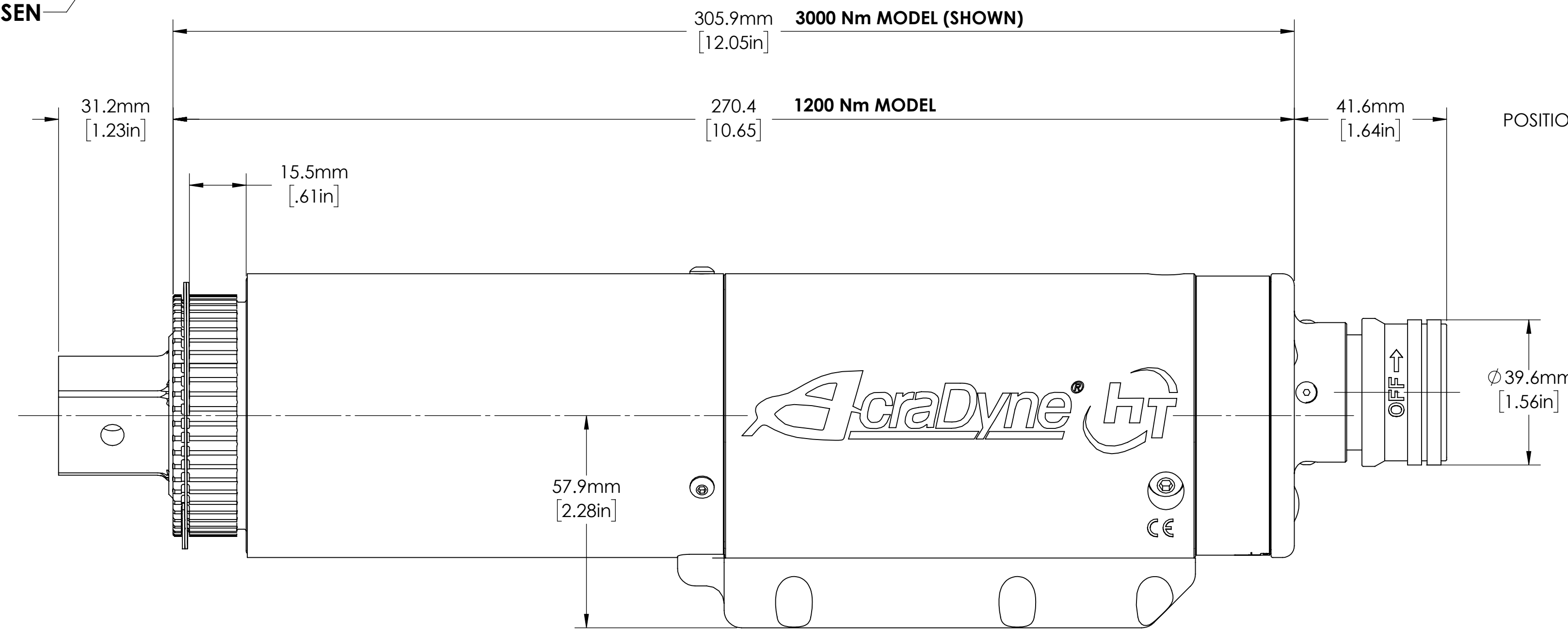

POSITION TOOL CONNECTOR  
AS SHOWN

**REACTION BAR REMOVED  
FOR CLARITY**

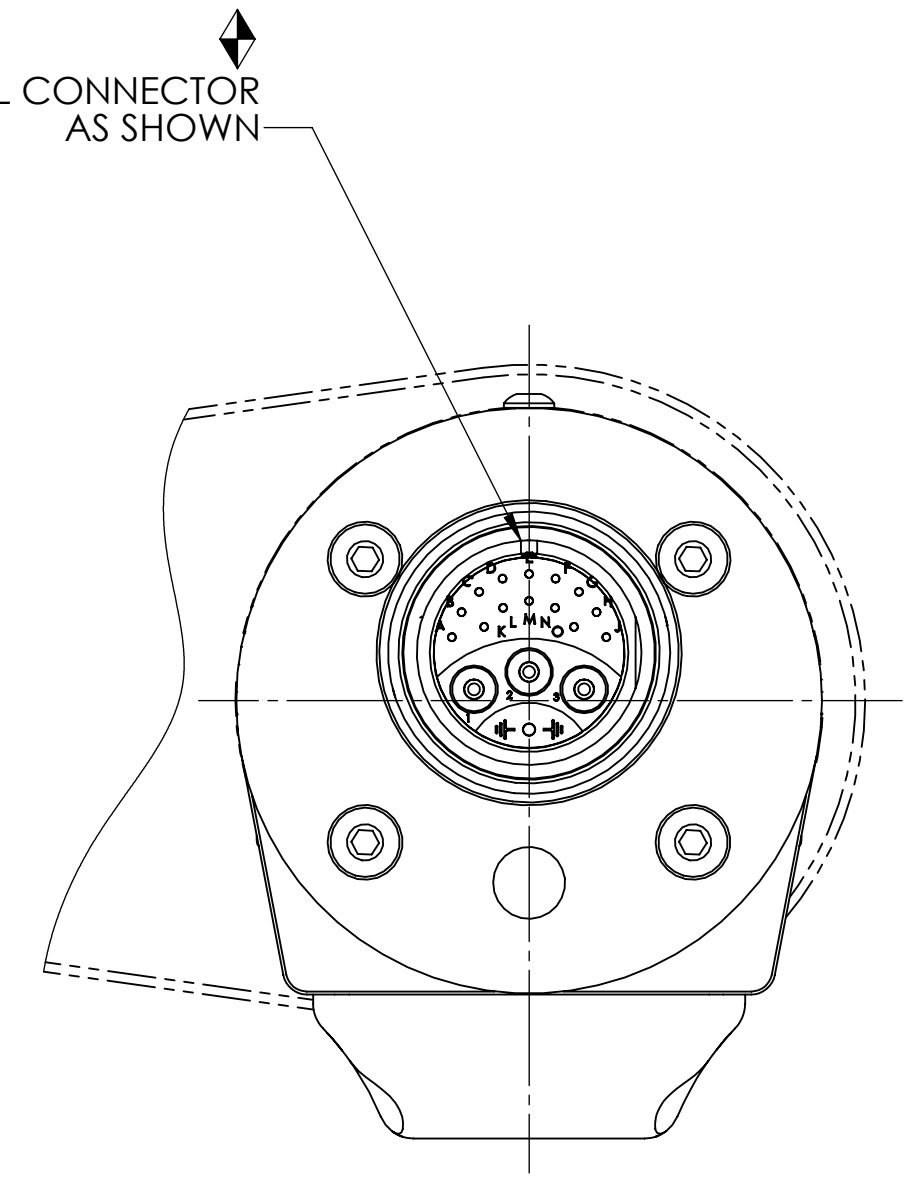
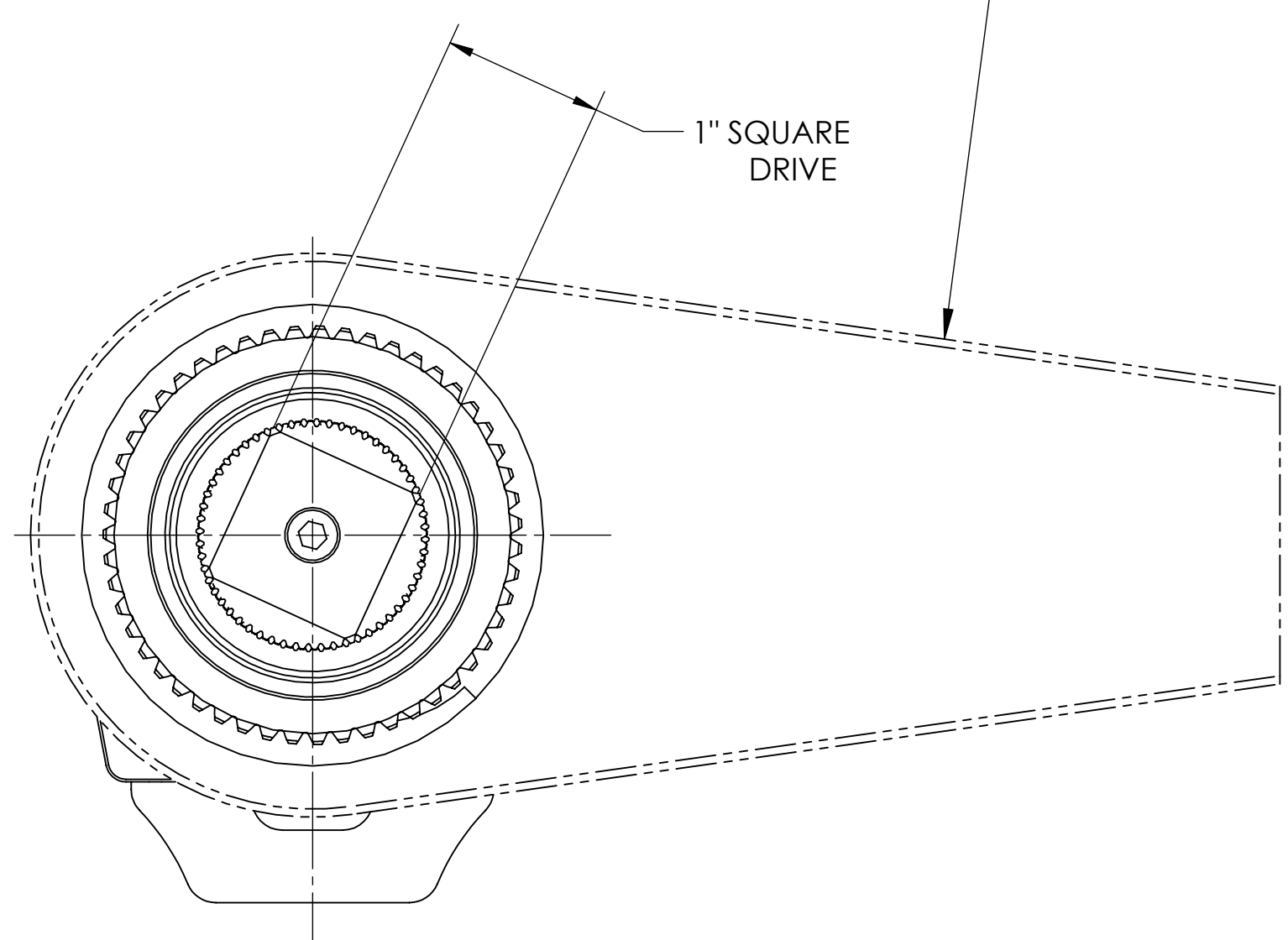

**DOCUMENT CONTROL**  
PRINTED COPIES OF THIS DOCUMENT ARE CONSIDERED TO BE UNCONTROLLED DOCUMENTS. HOLDERS ARE RESPONSIBLE FOR VERIFYING THE CURRENT REVISION LEVEL WITH PURCHASING OR ENGINEERING PRIOR TO USE OR FABRICATION. THE CONTROLLED VERSION OF THIS DOCUMENT IS ELECTRONICALLY MAINTAINED.

**PROPRIETARY AND CONFIDENTIAL**  
THIS DRAWING CONTAINS INFORMATION STRICTLY CONFIDENTIAL TO ACRADYNE/AIMCO. IN THE ABSENCE OF EXPRESSED WRITTEN PERMISSION, ACRADYNE/AIMCO HAS LOANED THIS COPY WITH THE MUTUAL UNDERSTANDING THAT (A) IT WILL NOT BE USED FOR ANY PURPOSE OTHER THAN FOR THAT IN WHICH IT WAS PROVIDED, (B) THE DATA CONTAINED HEREIN WILL NOT BE DISCLOSED TO OTHERS, (C) IT WILL NOT BE REPRODUCED, AND (D) IT WILL BE RETURNED TO ACRADYNE/AIMCO IMMEDIATELY UPON DEMAND.

REVISION LEVEL	REVISION RELEASE DATE	DESCRIPTION OF CHANGES MADE TO PART	ECN #	AUTHOR/ APPROVAL
<b>REVISION BLOCK</b>				

**UNLESS OTHERWISE SPECIFIED, DIMENSIONS ARE IN INCHES**  
DIMENSIONS AND TOLERANCING PER ANSI Y14.5  
SURFACE ROUGHNESS PER ANSI Y14.36

**BLOCK TOLERANCING PER DECIMAL:**  
X = ±.030 .XX = ±.010 .XXX = ±.005 .XXXX = ±.0005  
ANGLE = ±0° 30'

REMOVE BURRS AND SHARP EDGES: R.015 MAX  
MACHINE SURFACE FINISH: 125 RMS OR BETTER

**DRAWINGS AND TECHNICAL DOCUMENTS CONTROLLED BY:**  
**ACRADYNE MECHANICAL ENGINEERING**

<b>AEF4A77__B FIXTURED NUTRUNNER 7000 SERIES</b>		
SIZE	PART / DRAWING NUMBER	REVISION
<b>D</b>	<b>AEF4A77__B</b>	<b>A</b>
SCALE: 1:1	DO NOT SCALE DRAWING	SHEET 2 OF 2