

| TOOL MODEL | GEAR BOX ASM. | GEAR CASE COVER |
|----------------|---------------|-----------------|
| AEF4A771000BDL | 28110 | 26298 |
| AEF4A772500BDL | 28111 | 26295 |

| COMMENTS | ITEM NO. | PART NUMBER | QTY. | DESCRIPTION |
|-----------|----------|-------------|------|---|
| | 1 | 26212 | 1 | MOTOR ASM., 7000 SERIES |
| | 2 | 26227 | 1 | O-RING, MOTOR HOUSING |
| | 3 | 25574 | 4 | STANDOFF M-F, 4-40x1/4.3/16 HEX, SS |
| | 4 | 27727 | 1 | TID BOARD, POPULATED W/AMP |
| | 5 | 25573 | 8 | SCREW PHP 4-40 X 3/16 18-8 SS |
| | 6 | SEE CHART | 1 | GEAR BOX ASM. |
| | 7 | 26299 | 1 | O-RING, PINION |
| | 8 | 29279 | 6 | SCREW, BHSC, 10-32 x 3/8, TORX HEAD, NYLON PELL-IT, STEEL |
| | 9 | 20534 | 1 | 3000 SERIAL/MODEL LABEL |
| | 10 | 26226 | 1 | O-RING, LED COVER |
| | 11 | 26223 | 1 | LED COVER |
| | 12 | 26277 | 1 | END CAP, "J" HANDLE |
| | 13 | 26228 | 8 | SCREW, BHSC 10-32X1.50, STEEL, BLACK OXIDE |
| | 14 | 26280 | 1 | TOOL CONNECTOR ASM., "J" HANDLE |
| | 15 | 25745 | 4 | SCREW, BHSC 4-40 STEEL, BLACK OXIDE |
| | 16 | 28211 | 1 | (4) LINE MALE/FEMALE JUMPER ASM. |
| | 17 | 26525 | 1 | PLUG 5/16" |
| NOT SHOWN | 18 | 27464 | A/R | TWISTED WAXED LINEN TWINE |
| | 19 | 29336 | 1 | TID BOARD WIRE INSULATOR |
| | 20 | 29337 | 3 | STANDOFF, M-F, 4-40 X 1/8, SS |
| | 21 | 28060 | 1 | HANDLE BLOCK, HT DUAL LEVER |
| | 22 | 28059 | 2 | HANDLE SPACER, HT DUAL LEVER |
| | 23 | 24838 | 1 | TRANSDUCER CABLE CHASE |
| | 24 | 26224 | 1 | TRAY, WIRE, PISTOL, INJECTION MOLDED |
| | 25 | 28664 | 2 | SCREW, BHSC, 10-32 X .437, STEEL |
| | 26 | 28070 | 1 | HANDLE ASM., DUAL LEVER, MFB DISABLED |
| NOT SHOWN | 27 | 28107 | 1 | TRIGGER CABLE |
| NOT SHOWN | 28 | 28066 | 1 | HANDLE ASM., DUAL LEVER |
| NOT SHOWN | 29 | 25582 | 1 | TRIGGER CABLE |
| | 30 | 28002 | 8 | SCREW, SHC, 10-32 X 2.5, STEEL |
| | 31 | 26319 | 3 | SCREW, BHSC 6-32 X .188, 18-8 SS |
| | 32 | SEE CHART | 1 | GEAR CASE COVER |
| | 33 | 26897 | 1 | CHOOSE REACTION BAR |
| | 34 | 26243 | 1 | RETAINING RING, SPIRAL, Ø2.864 X Ø2.464 X .078 |
| | 35 | 31410 | 1 | GROUND WIRE ASSEMBLY, 18 AWG, 6000 & 7000 HT SERIES |

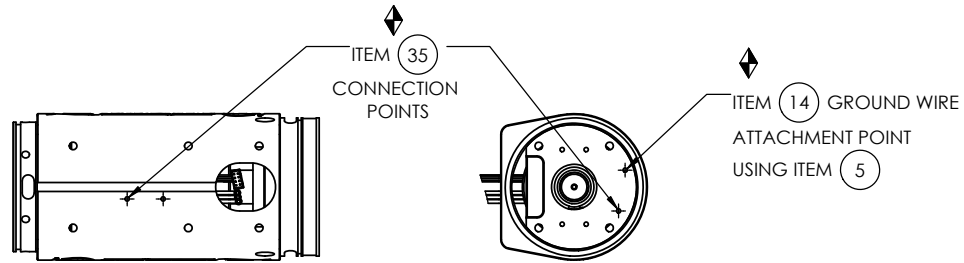

GROUND WIRE ATTACHMENT DETAILS

CONNECT FEMALE END TO CONNECTOR ON RING GEAR. ATTACH GROUND LUG TO TAPPED HOLE IN BOTTOM OF MOTOR ASM. (1) WITH SCREW (5). FEED MALE END THRU THE BOTTOM HOLE IN MOTOR HOUSING AND ATTACH IT TO MATING CONNECTOR ON ITEM (4).

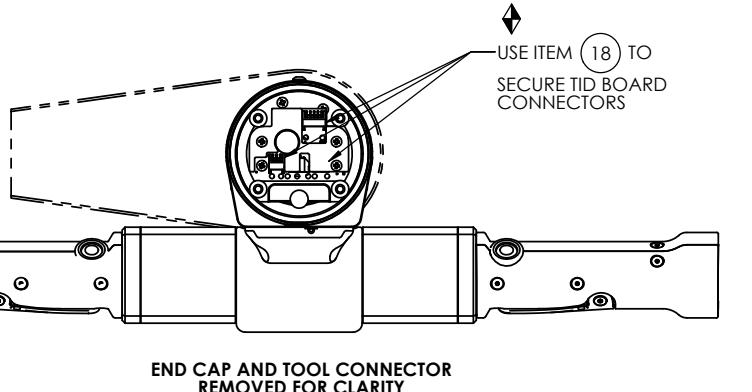
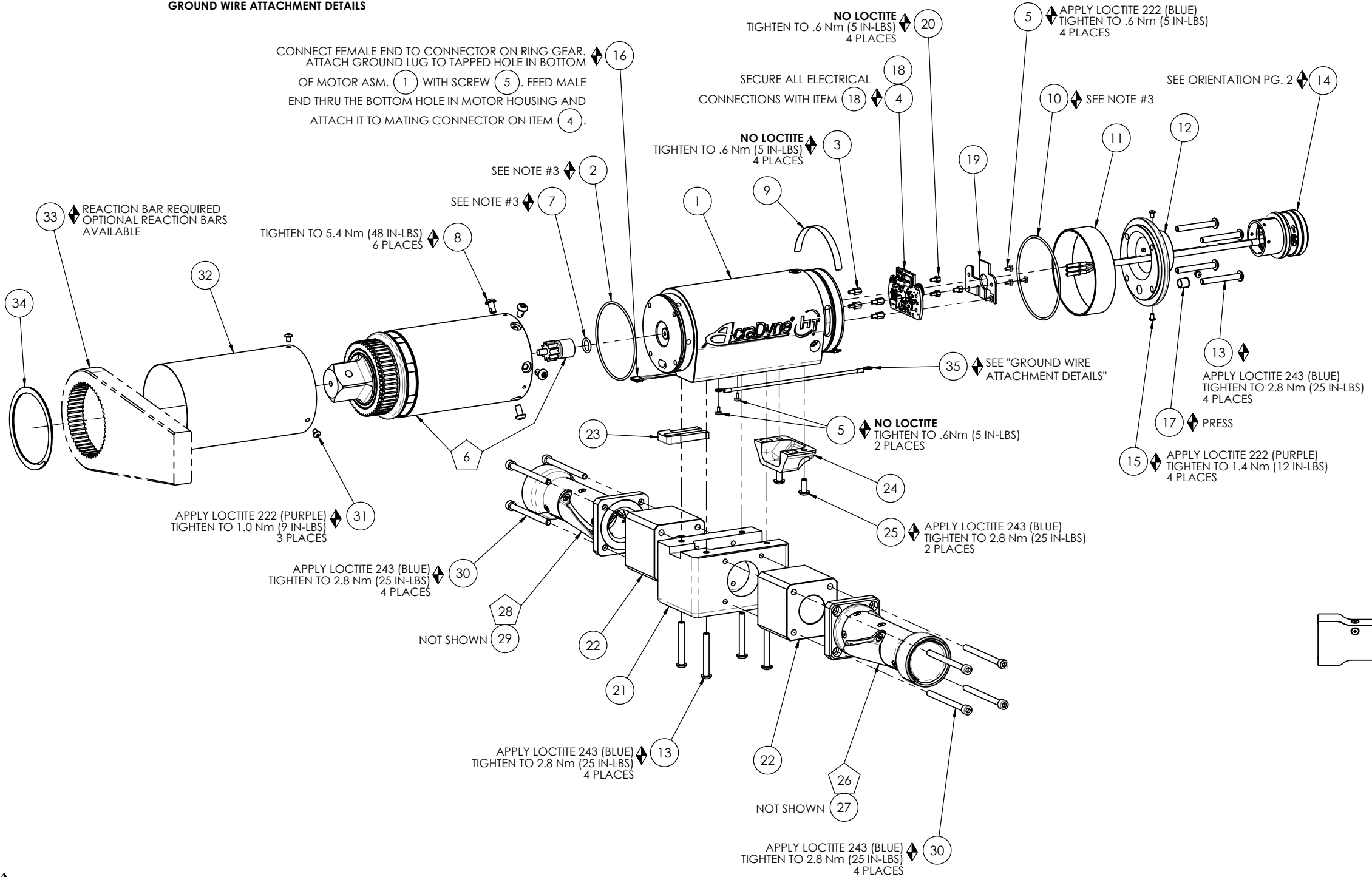

- ◆ ASSEMBLY INSTRUCTIONS
- ◻ SUB-ASSEMBLY

- 1) GEARS & SPLINES: LUBRICATE WITH DOW CORNING MOLYKOTE BR2 PLUS GREASE.
- 2) BEARINGS: LUBRICATE WITH CHEVRON SR1 GREASE
- 3) O-RINGS: LUBRICATE WITH O-RING LUBE



DOCUMENT CONTROL
 PRINTED COPIES OF THIS DOCUMENT ARE CONSIDERED TO BE UNCONTROLLED DOCUMENTS. HOLDERS ARE RESPONSIBLE FOR VERIFYING THE CURRENT REVISION LEVEL WITH PURCHASING OR ENGINEERING PRIOR TO USE OR FABRICATION. THE CONTROLLED VERSION OF THIS DOCUMENT IS ELECTRONICALLY MAINTAINED.

PROPRIETARY AND CONFIDENTIAL
 THIS DRAWING CONTAINS INFORMATION STRICTLY CONFIDENTIAL TO ACRADYNE/AIMCO. IN THE ABSENCE OF EXPRESSED WRITTEN PERMISSION, ACRADYNE/AIMCO HAS LOANED THIS COPY WITH THE MUTUAL UNDERSTANDING THAT (A) IT WILL NOT BE USED FOR ANY PURPOSE OTHER THAN FOR THAT IN WHICH IT WAS PROVIDED, (B) THE DATA CONTAINED HEREIN WILL NOT BE DISCLOSED TO OTHERS, (C) IT WILL NOT BE REPRODUCED, AND (D) IT WILL BE RETURNED TO ACRADYNE/AIMCO IMMEDIATELY UPON DEMAND.

| REVISION | DESCRIPTION | DATE | BY |
|----------|-------------|------|----|
| | | | |
| | | | |
| | | | |
| | | | |
| | | | |
| | | | |

UNLESS OTHERWISE SPECIFIED, DIMENSIONS ARE IN INCHES
 DIMENSIONS AND TOLERANCING PER ANSI Y14.5 SURFACE ROUGHNESS PER ANSI Y14.36

BLOCK TOLERANCING PER DECIMAL:
 .X = ±.030 .XX = ±.010 .XXX = ±.005 .XXXX = ±.0005 ANGLE = ±0°30'

REMOVE BURRS AND SHARP EDGES: R.015 MAX MACHINE SURFACE FINISH: 125 RMS OR BETTER

DRAWINGS AND TECHNICAL DOCUMENTS CONTROLLED BY:
ACRADYNE MECHANICAL ENGINEERING

FIXTURED NUTRUNNER DUAL LEVER 7000 SERIES

| | | |
|----------|-----------------------|----------|
| SIZE | PART / DRAWING NUMBER | REVISION |
| D | AEF4A77_00BDL | A |

SCALE 1:2 DO NOT SCALE DRAWING SHEET 1 OF 2

REVISION BLOCK

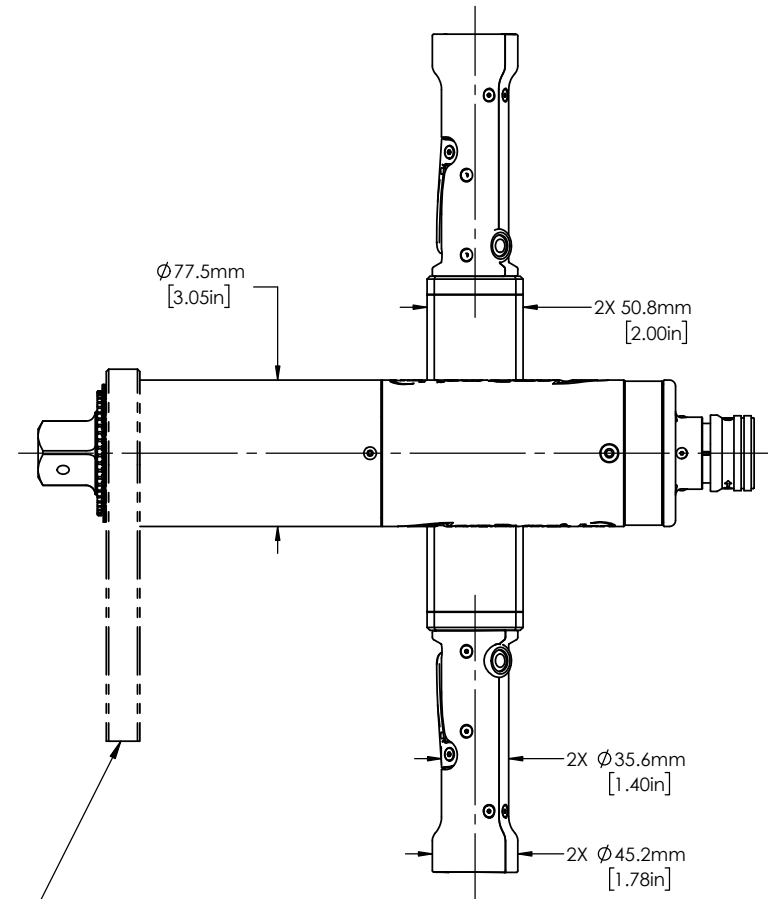

| |
|-----------------------|
| MODEL NO. |
| AEF4A771000BDL |
| AEF4A772500BDL |

NOTE:
REACTION BAR GEOMETRY
TO CHANGE DEPENDING
ON REACTION BAR CHOSEN

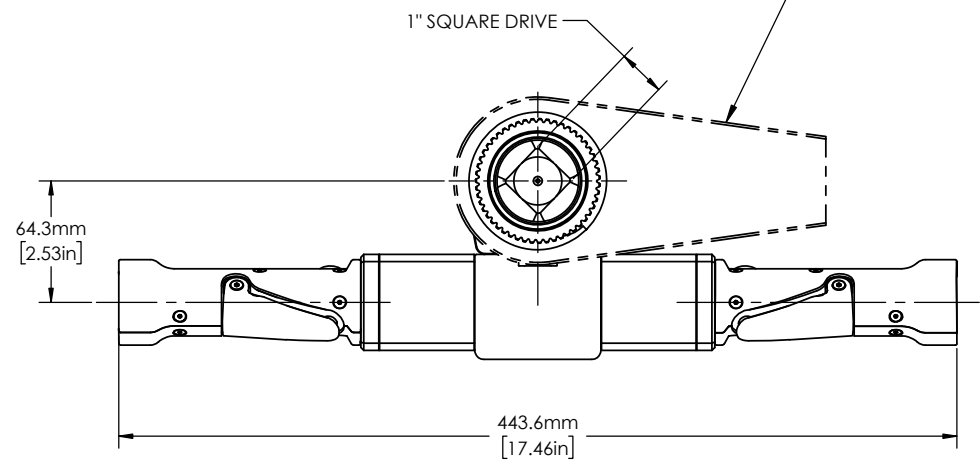
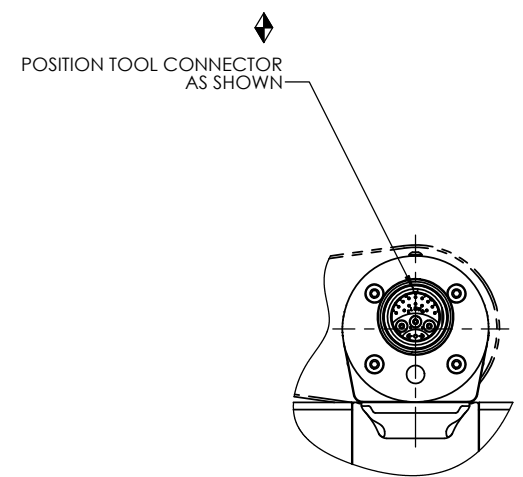
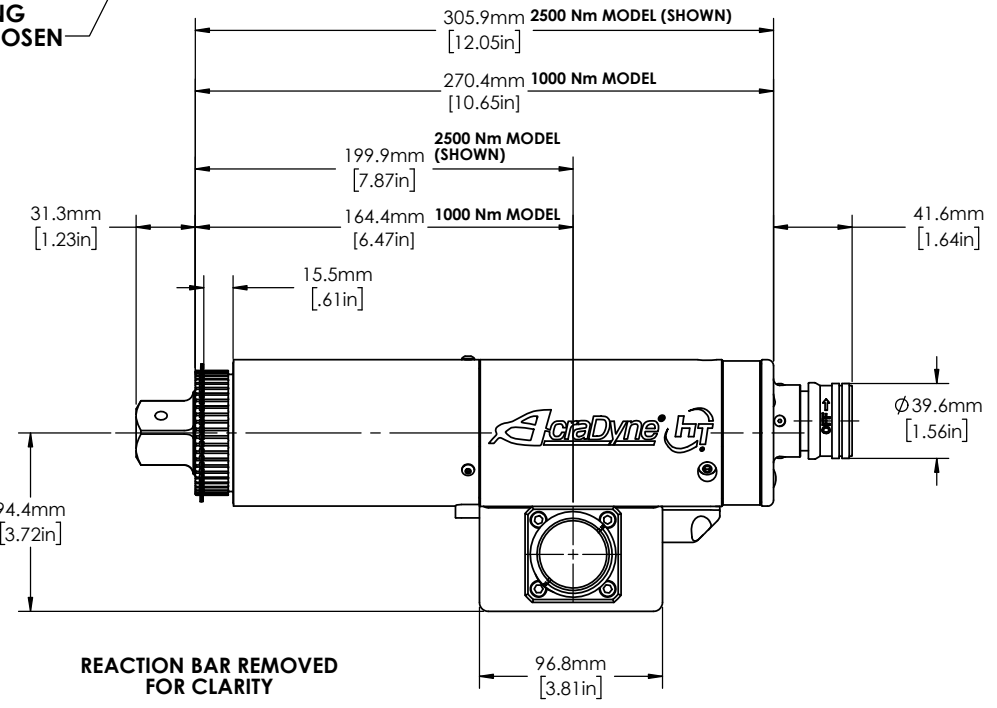

REACTION BAR REMOVED FOR CLARITY



DOCUMENT CONTROL
PRINTED COPIES OF THIS DOCUMENT ARE CONSIDERED TO BE UNCONTROLLED DOCUMENTS. HOLDERS ARE RESPONSIBLE FOR VERIFYING THE CURRENT REVISION LEVEL WITH PURCHASING OR ENGINEERING PRIOR TO USE OR FABRICATION. THE CONTROLLED VERSION OF THIS DOCUMENT IS ELECTRONICALLY MAINTAINED.

PROPRIETARY AND CONFIDENTIAL
THIS DRAWING CONTAINS INFORMATION STRICTLY CONFIDENTIAL TO ACRADYNE/AIMCO. IN THE ABSENCE OF EXPRESSED WRITTEN PERMISSION, ACRADYNE/AIMCO HAS LOANED THIS COPY WITH THE MUTUAL UNDERSTANDING THAT (A) IT WILL NOT BE USED FOR ANY PURPOSE OTHER THAN FOR THAT IN WHICH IT WAS PROVIDED, (B) THE DATA CONTAINED HEREIN WILL NOT BE DISCLOSED TO OTHERS, (C) IT WILL NOT BE REPRODUCED, AND (D) IT WILL BE RETURNED TO ACRADYNE/AIMCO IMMEDIATELY UPON DEMAND.

| REV | DESCRIPTION | DATE | BY | CHKD |
|-----|-------------|------|----|------|
| | | | | |
| | | | | |
| | | | | |
| | | | | |

UNLESS OTHERWISE SPECIFIED, DIMENSIONS ARE IN INCHES
DIMENSIONS AND TOLERANCING PER ANSI Y14.5
SURFACE ROUGHNESS PER ANSI Y14.36

BLOCK TOLERANCING PER DECIMAL:
.X = ±.030 .XX = ±.010 .XXX = ±.005 .XXXX = ±.0005
ANGLE = ±0°30'

REMOVE BURRS AND SHARP EDGES: R.015 MAX
MACHINE SURFACE FINISH: 125 RMS OR BETTER

DRAWINGS AND TECHNICAL DOCUMENTS CONTROLLED BY:
ACRADYNE MECHANICAL ENGINEERING

**FIXTURED NUTRUNNER
DUAL LEVER
7000 SERIES**

| | | |
|-----------|-----------------------|--------------|
| SIZE | PART / DRAWING NUMBER | REVISION |
| D | AEF4A77_00BDL | A |
| SCALE 1:2 | DO NOT SCALE DRAWING | SHEET 2 OF 2 |

REVISION BLOCK