

◆ ASSEMBLY INSTRUCTIONS

◇ SUB-ASSEMBLY

- 1) GEARS & SPLINES: LUBRICATE WITH DOW CORNING MOLYKOTE BR2 PLUS GREASE.
- 2) BEARINGS: LUBRICATE WITH CHEVRON SR1 GREASE
- 3) O-RINGS: LUBRICATE WITH O-RING LUBE

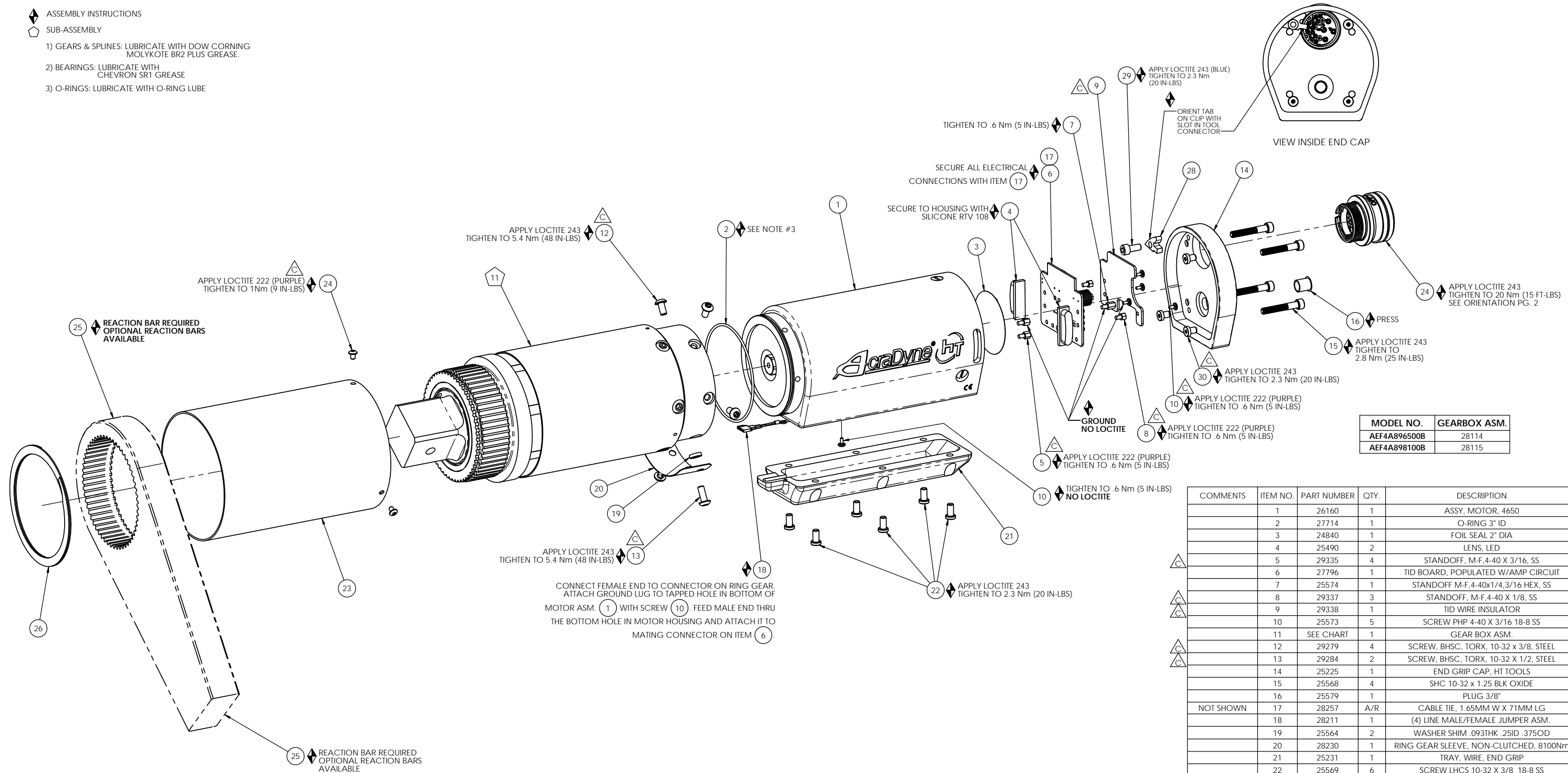

MODEL NO.	GEARBOX ASM.
AEF4A896500B	28114
AEF4A898100B	28115

COMMENTS	ITEM NO.	PART NUMBER	QTY.	DESCRIPTION
	1	26160	1	ASSY, MOTOR, 4650
	2	27714	1	O-RING 3" ID
	3	24840	1	FOIL SEAL 2" DIA
	4	25490	2	LENS, LED
	5	29335	4	STANDOFF, M-F, 4-40 X 3/16, SS
	6	27796	1	TID BOARD, POPULATED W/AMP CIRCUIT
	7	25574	1	STANDOFF M-F, 4-40x1/4, 3/16 HEX, SS
	8	29337	3	STANDOFF, M-F, 4-40 X 1/8, SS
	9	29338	1	TID WIRE INSULATOR
	10	25573	5	SCREW PHP 4-40 X 3/16 18-8 SS
	11	SEE CHART	1	GEAR BOX ASM.
	12	29279	4	SCREW, BHSC, TORX, 10-32 x 3/8, STEEL
	13	29284	2	SCREW, BHSC, TORX, 10-32 X 1/2, STEEL
	14	25225	1	END GRIP CAP, HT TOOLS
	15	25568	4	SHC 10-32 x 1.25 BLK OXIDE
	16	25579	1	PLUG 3/8"
NOT SHOWN	17	28257	A/R	CABLE TIE, 1.65MM W X 71MM LG
	18	28211	1	(4) LINE MALE/FEMALE JUMPER ASM.
	19	25564	2	WASHER SHIM .093THK .25ID .375OD
	20	28230	1	RING GEAR SLEEVE, NON-CLUTCHED, 8100Nm
	21	25231	1	TRAY, WIRE, END GRIP
	22	25569	6	SCREW LHCS 10-32 X 3/8 18-8 SS
	23	26636	1	GEAR CASE COVER
	24	26319	3	SCREW, BHSC 6-32 X .188, 18-8 SS
	25	26899	1	CHOOSE REACTION BAR
	26	26436	1	RETAINING RING, SPIRAL, Ø3.833 X Ø3.293 X .111
	24	25507	1	TOOL CONNECTOR ASM HERC PISTOL
	28	27063	1	TOOL CONNECTOR CLIP
	29	26458	1	SCREW, SHC 10-32 X .44 LG., STEEL, BLACK OXIDE
	30	24859	3	LHSC 10-32 X 1/4 BLK OXIDE



**DOCUMENT CONTROL**  
 PRINTED COPIES OF THIS DOCUMENT ARE CONSIDERED TO BE UNCONTROLLED DOCUMENTS. HOLDERS ARE RESPONSIBLE FOR VERIFYING THE CURRENT REVISION LEVEL WITH PURCHASING OR ENGINEERING PRIOR TO USE OR FABRICATION. THE CONTROLLED VERSION OF THIS DOCUMENT IS ELECTRONICALLY MAINTAINED.

**PROPRIETARY AND CONFIDENTIAL**  
 THIS DRAWING CONTAINS INFORMATION STRICTLY CONFIDENTIAL TO ACRADYNE/AIMCO. IN THE ABSENCE OF EXPRESSED WRITTEN PERMISSION, ACRADYNE/AIMCO HAS LOANED THIS COPY WITH THE MUTUAL UNDERSTANDING THAT (A) IT WILL NOT BE USED FOR ANY PURPOSE OTHER THAN FOR THAT IN WHICH IT WAS PROVIDED, (B) THE DATA CONTAINED HEREIN WILL NOT BE DISCLOSED TO OTHERS, (C) IT WILL NOT BE REPRODUCED, AND (D) IT WILL BE RETURNED TO ACRADYNE/AIMCO IMMEDIATELY UPON DEMAND.

**UNLESS OTHERWISE SPECIFIED, DIMENSIONS ARE IN INCHES**  
 DIMENSIONS AND TOLERANCING PER ANSI Y14.5  
 SURFACE ROUGHNESS PER ANSI Y14.36

**BLOCK TOLERANCING PER DECIMAL:**  
 .X = ±.030 .XX = ±.010 .XXX = ±.005 .XXXX = ±.0005  
 ANGLE = ±0°30'

REMOVE BURRS AND SHARP EDGES: R.015 MAX  
 MACHINE SURFACE FINISH: 125 RMS OR BETTER

DRAWINGS AND TECHNICAL DOCUMENTS CONTROLLED BY:  
**ACRADYNE MECHANICAL ENGINEERING**

**AED4A89\_\_B**  
**FIXTURED NUTRUNNER**  
**8000 SERIES**

SIZE	PART / DRAWING NUMBER	REVISION
<b>D</b>	<b>AEF4A89__B</b>	<b>C</b>

SCALE: 2:3 DO NOT SCALE DRAWING SHEET 1 OF 2

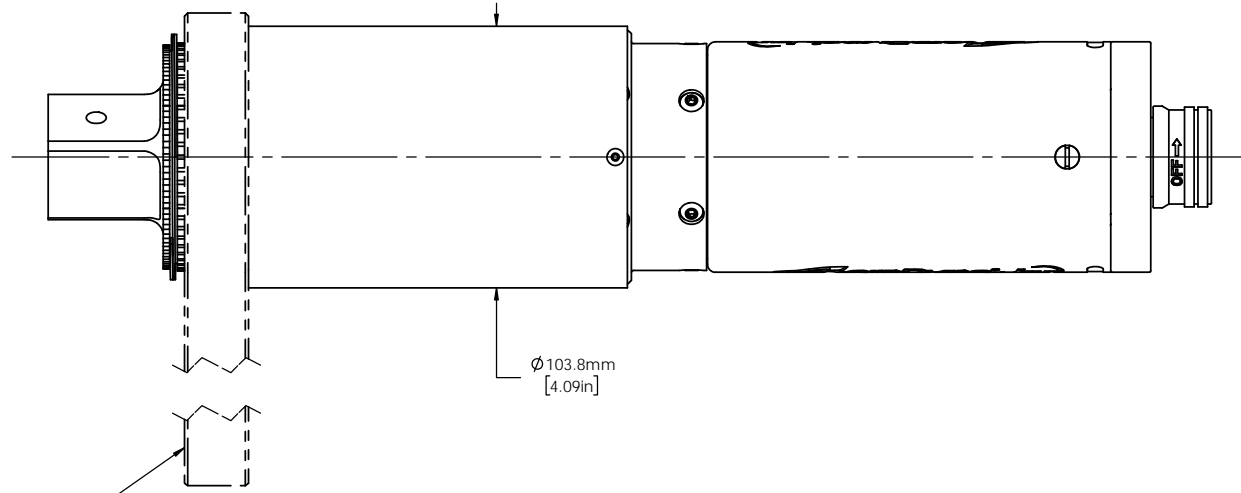

REACTION BAR GEOMETRY  
TO CHANGE DEPENDING  
ON REACTION BAR CHOSEN

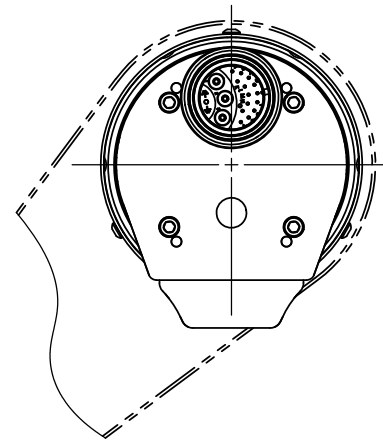
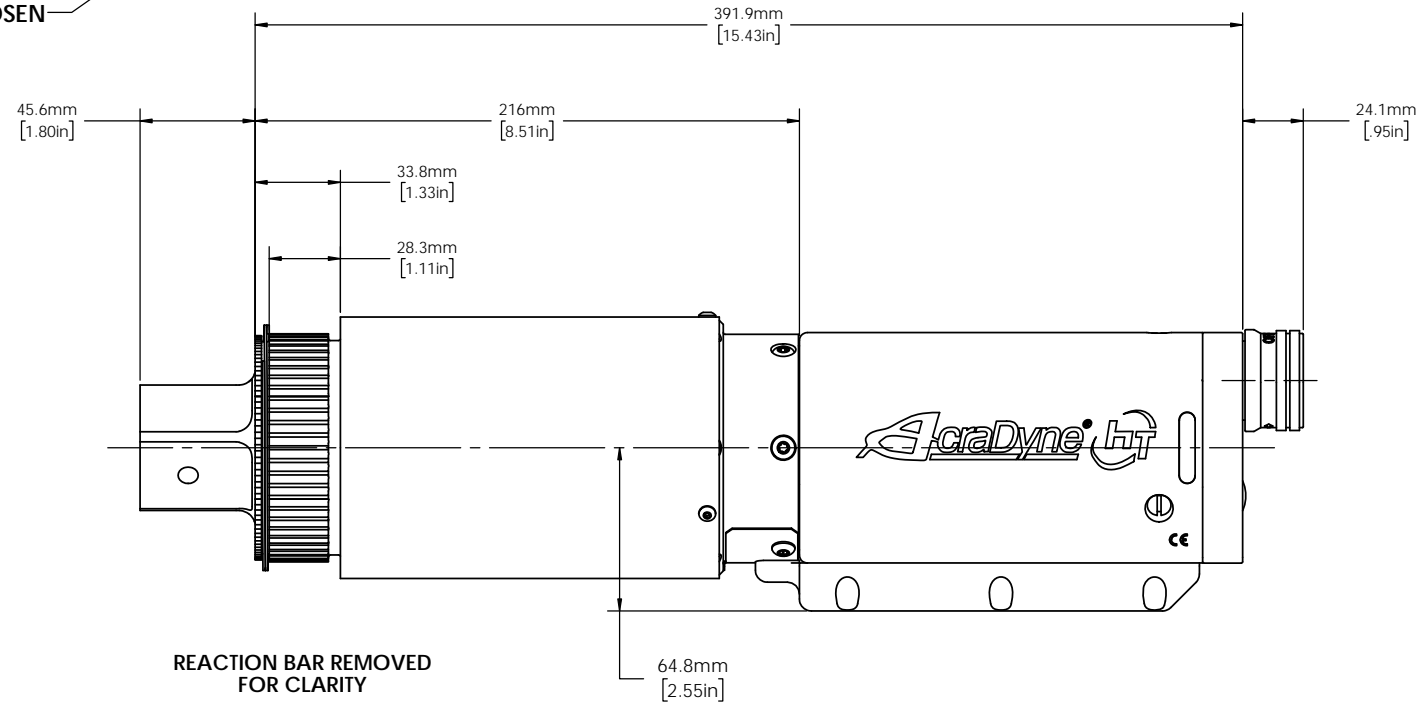
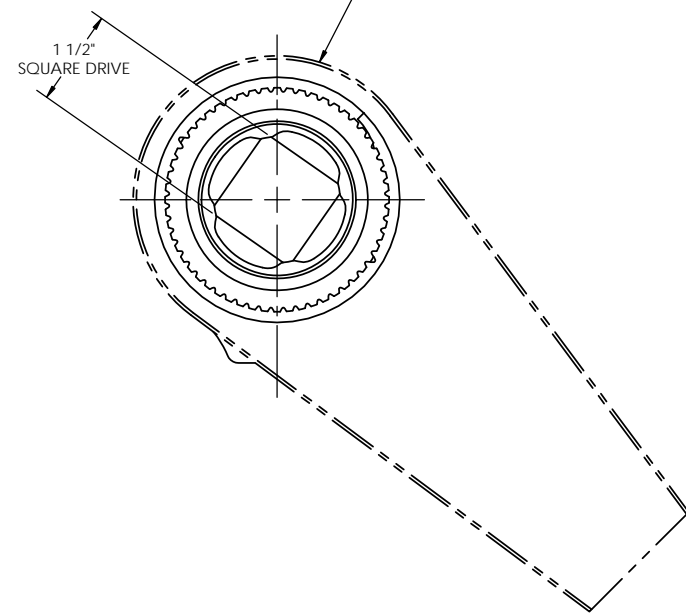

MODEL NO.
AEF4A896500B
AEF4A898100B



**DOCUMENT CONTROL**  
PRINTED COPIES OF THIS DOCUMENT ARE CONSIDERED TO BE UNCONTROLLED DOCUMENTS. HOLDERS ARE RESPONSIBLE FOR VERIFYING THE CURRENT REVISION LEVEL WITH PURCHASING OR ENGINEERING PRIOR TO USE OR FABRICATION. THE CONTROLLED VERSION OF THIS DOCUMENT IS ELECTRONICALLY MAINTAINED.

**PROPRIETARY AND CONFIDENTIAL**  
THIS DRAWING CONTAINS INFORMATION STRICTLY CONFIDENTIAL TO ACRADYNE/AIMCO. IN THE ABSENCE OF EXPRESSED WRITTEN PERMISSION, ACRADYNE/AIMCO HAS LOANED THIS COPY WITH THE MUTUAL UNDERSTANDING THAT (A) IT WILL NOT BE USED FOR ANY PURPOSE OTHER THAN FOR THAT IN WHICH IT WAS PROVIDED, (B) THE DATA CONTAINED HEREIN WILL NOT BE DISCLOSED TO OTHERS, (C) IT WILL NOT BE REPRODUCED, AND (D) IT WILL BE RETURNED TO ACRADYNE/AIMCO IMMEDIATELY UPON DEMAND.

REVISION BLOCK

UNLESS OTHERWISE SPECIFIED,  
DIMENSIONS ARE IN INCHES  
DIMENSIONS AND TOLERANCING PER ANSI Y14.5  
SURFACE ROUGHNESS PER ANSI Y14.36

BLOCK TOLERANCING PER DECIMAL:  
.X = ±.030 .XX = ±.010 .XXX = ±.005 .XXXX = ±.0005  
ANGLE = ±0° 30'

REMOVE BURRS AND SHARP EDGES: R.015 MAX  
MACHINE SURFACE FINISH: 125 RMS OR BETTER

DRAWINGS AND TECHNICAL DOCUMENTS CONTROLLED BY:  
ACRADYNE MECHANICAL ENGINEERING

FIXTURED NUTRUNNER  
8000 SERIES

SIZE	PART / DRAWING NUMBER	REVISION
D	AEF4A89_ _ _ B	C

SCALE: 2:3 DO NOT SCALE DRAWING SHEET 2 OF 2