

COMMENTS	ITEM NO.	PART NUMBER	QTY.	DESCRIPTION
	1	31452	1	MOTOR/FAN SUB-ASM., 12K Nm
	2	25573	7	SCREW PHP 4-40 X 3/16 18-8 SS
	3	25574	4	STANDOFF M-F, 4-40x1/4, 3/16 HEX, SS
	4	26206	4	SCREW, BHSC 10-32 X .375, STEEL
	5	31535	1	TOOL CONNECTOR/HANDLE ADAPTER PLATE
	6	31520	1	TRANSDUCER WIRE COVER, 8100 Nm
	7	20532	4	SCREW, 6-32x1/4 BUTTON SOC CAP
	8	31290	1	TOOL CONNECTOR ASSEMBLY, 17,000Nm
	9	31411	8	LIGHTPIPE, LED, PANEL MOUNT, CONVEX, .250" LENGTH
	10	31496	1	FAN HOUSING, 80mm X 38mm FAN, 12,000Nm TOOL
	11	30298	4	SCREW, BHSC 10-32 X 5/8, STEEL, BLACK OXIDE
	12	31621	4	SCREW, SHC 10-32 X 1-3/8, STEEL, BLACK OXIDE
	13	31647	4	SCREW, BHSC, 1/4-20 X 1, STEEL, BLACK OXIDE
	14	28114	1	GEAR BOX ASM., 413.07:1, 6500 Nm
	15	22141	1	SAFETY LABEL
	16	31317	1	LABEL, MODEL, SERIAL NUMBER AND DESCRIPTION
	17	27727	1	TID BOARD, POPULATED W/AMP
	18	27953	1	O-RING, 70 DURO BUNA N, -.042
	19	26319	3	SCREW, BHSC 6-32 X .188, 18-8 SS
	20	29336	1	TID BOARD WIRE INSULATOR
	21	29337	3	STANDOFF, M-F, 4-40 X 1/8, SS
	22	30734	1	CONNECTOR, 2 POS, MALE PINS, MOLEX 70107-0001
NOT SHOWN	23	30738	2	CONNECTOR CRIMP TERMINAL, MALE
	24	26636	1	GEAR CASE COVER
	25	28511	2	SCREW, SHC 4-40x.625, STEEL, BLACK OXIDE
	26	31509	1	ADAPTER, MOTOR TO CLUTCH
	27	25271	A/R	SHIM, -.002
	28	25272	A/R	SHIM, -.005
	29	25273	A/R	SHIM, -.010
	30	26525	1	PLUG 5/16"
	31	29284	6	SCREW, BHSC, 10-32 X 1/2, TORX HEAD, NYLON PELL-IT, STEEL
	32	31613	1	HANDLE FILLER PLATE
	33	31417	1	MALE RECEPTACLE CABLE ASSY, 3-PIN, 6.56FT, 2-PIN CONNECTOR
	34	26899	1	CHOOSE REACTION BAR
	35	26436	1	RETAINING RING, SPIRAL, Ø3.833 X Ø3.293 X .111
NOT SHOWN	36	24263	A/R	KAPTON TAPE, 1/2"
NOT SHOWN	37	24177	A/R	CLEAR SILICON, RTV 108
	38	28211	1	(4) LINE MALE/FEMALE JUMPER ASM.
NOT SHOWN	39	28525	1	CABLE ASM., I/O ADAPTOR TO 3-SKT FEMALE CONN.

FAN CONNECTOR CRIMP DETAIL

- ◆ ASSEMBLY INSTRUCTIONS
- ◊ SUB-ASSEMBLY

- 1) GEARS & SPLINES: LUBRICATE WITH DOW CORNING MOLYKOTE BR2 PLUS GREASE.
- 2) BEARINGS: LUBRICATE WITH CHEVRON SR1 GREASE
- 3) O-RINGS: LUBRICATE WITH O-RING LUBE



**DOCUMENT CONTROL**  
 PRINTED COPIES OF THIS DOCUMENT ARE CONSIDERED TO BE UNCONTROLLED DOCUMENTS. HOLDERS ARE RESPONSIBLE FOR VERIFYING THE CURRENT REVISION LEVEL WITH PURCHASING OR ENGINEERING PRIOR TO USE OR FABRICATION. THE CONTROLLED VERSION OF THIS DOCUMENT IS ELECTRONICALLY MAINTAINED.

**PROPRIETARY AND CONFIDENTIAL**  
 THIS DRAWING CONTAINS INFORMATION STRICTLY CONFIDENTIAL TO ACRADYNE/AMCO. IN THE ABSENCE OF EXPRESSED WRITTEN PERMISSION, ACRADYNE/AMCO HAS LOANED THIS COPY WITH THE MUTUAL UNDERSTANDING THAT (A) IT WILL NOT BE USED FOR ANY PURPOSE OTHER THAN FOR THAT IN WHICH IT WAS PROVIDED, (B) THE DATA CONTAINED HEREIN WILL NOT BE DISCLOSED TO OTHERS, (C) IT WILL NOT BE REPRODUCED, AND (D) IT WILL BE RETURNED TO ACRADYNE/AMCO IMMEDIATELY UPON DEMAND.

**UNLESS OTHERWISE SPECIFIED, DIMENSIONS ARE IN INCHES**  
 DIMENSIONS AND TOLERANCING PER ANSI Y14.5 SURFACE ROUGHNESS PER ANSI Y14.36

**BLOCK TOLERANCING PER DECIMAL:**  
 .X = ±.030 .XX = ±.010 .XXX = ±.005 .XXXX = ±.0005  
 ANGLE = ±0°30'

REMOVE BURRS AND SHARP EDGES: R.015 MAX MACHINE SURFACE FINISH: 125 RMS OR BETTER

DRAWINGS AND TECHNICAL DOCUMENTS CONTROLLED BY:  
**ACRADYNE MECHANICAL ENGINEERING**

**FIXTURED NUTRUNNER, W/ FAN KIT, 6500Nm**

9000-SERIES

SIZE	PART / DRAWING NUMBER	REVISION
<b>D</b>	<b>AEF4A996500B</b>	<b>A</b>
SCALE 1:2	DO NOT SCALE DRAWING	SHEET 1 OF 2

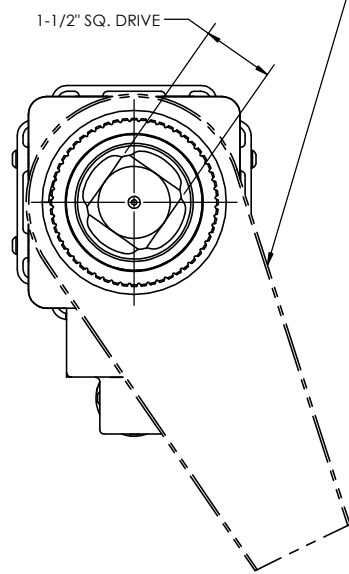

REACTION BAR GEOMETRY  
TO CHANGE DEPENDING  
ON REACTION BAR CHOSEN

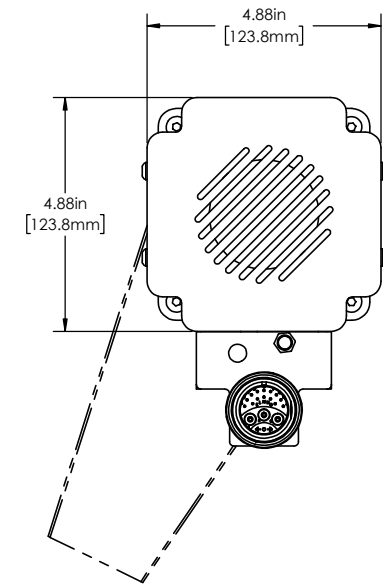
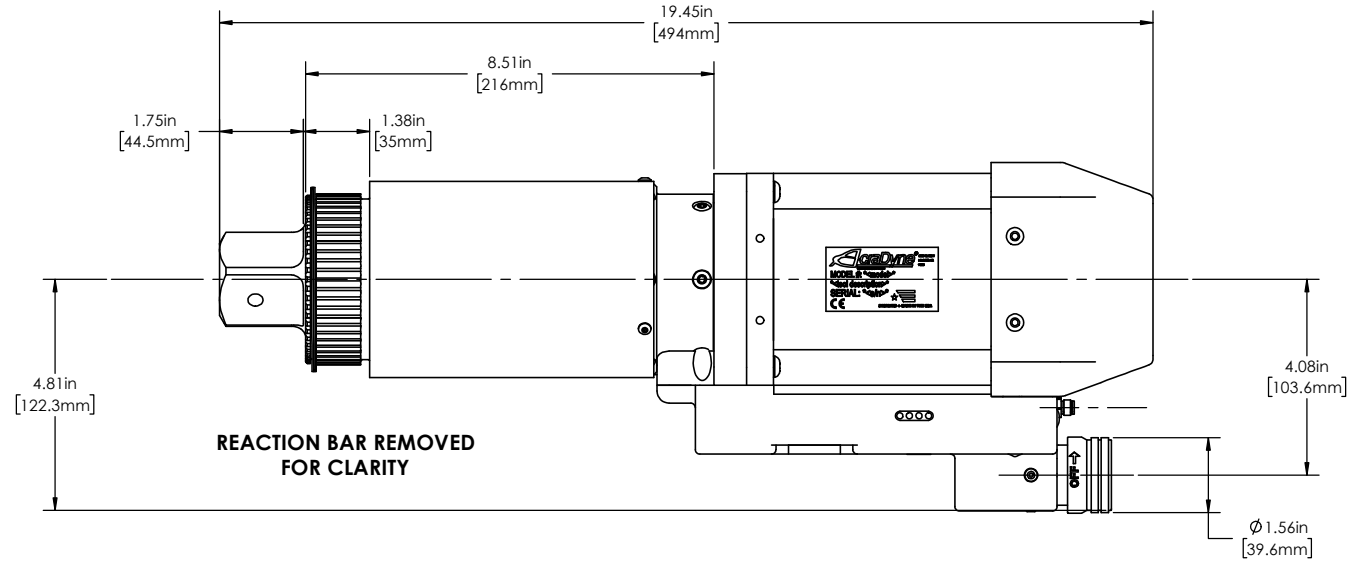
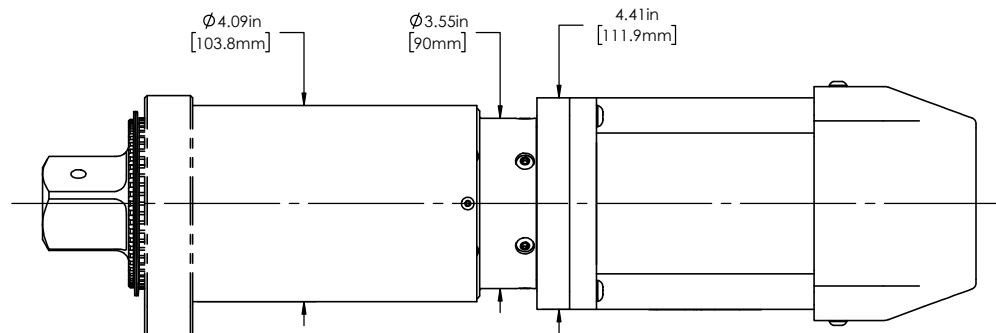

**DOCUMENT CONTROL**  
PRINTED COPIES OF THIS DOCUMENT ARE CONSIDERED TO BE UNCONTROLLED DOCUMENTS. HOLDERS ARE RESPONSIBLE FOR VERIFYING THE CURRENT REVISION LEVEL WITH PURCHASING OR ENGINEERING PRIOR TO USE OR FABRICATION. THE CONTROLLED VERSION OF THIS DOCUMENT IS ELECTRONICALLY MAINTAINED.

**PROPRIETARY AND CONFIDENTIAL**  
THIS DRAWING CONTAINS INFORMATION STRICTLY CONFIDENTIAL TO ACRADYNE/AMCO. IN THE ABSENCE OF EXPRESSED WRITTEN PERMISSION, ACRADYNE/AMCO HAS LOANED THIS COPY WITH THE MUTUAL UNDERSTANDING THAT (A) IT WILL NOT BE USED FOR ANY PURPOSE OTHER THAN FOR THAT IN WHICH IT WAS PROVIDED, (B) THE DATA CONTAINED HEREIN WILL NOT BE DISCLOSED TO OTHERS, (C) IT WILL NOT BE REPRODUCED, AND (D) IT WILL BE RETURNED TO ACRADYNE/AMCO IMMEDIATELY UPON DEMAND.

**UNLESS OTHERWISE SPECIFIED, DIMENSIONS ARE IN INCHES**  
DIMENSIONS AND TOLERANCING PER ANSI Y14.5  
SURFACE ROUGHNESS PER ANSI Y14.36

**BLOCK TOLERANCING PER DECIMAL:**  
.X = ±.030 .XX = ±.010 .XXX = ±.005 .XXXX = ±.0005  
ANGLE = ±0°30'

REMOVE BURRS AND SHARP EDGES: R.015 MAX  
MACHINE SURFACE FINISH: 125 RMS OR BETTER

DRAWINGS AND TECHNICAL DOCUMENTS CONTROLLED BY:  
**ACRADYNE MECHANICAL ENGINEERING**

**PISTOL HANDLE  
NUTRUNNER, 8100Nm  
9000-SERIES**

SIZE <b>D</b>	PART / DRAWING NUMBER <b>AEF4A996500B</b>	REVISION <b>A</b>
SCALE 1:4	DO NOT SCALE DRAWING	SHEET 2 OF 2