

COMMENTS	ITEM NO.	PART NUMBER	QTY.	DESCRIPTION
	1	26213	1	PISTOL MOTOR ASSEMBLY
	2	26198	1	THRUST WASHER
	3	26074	1	BELLEVILLE WASHER
	4	SEE CHART	1	GEAR TRAIN ASM.
	5	26530	2	DOWEL PIN, Ø1/8 x 1.00, STEEL
	6	27391	1	PIN RETAINER RING
	7	26077	2	M-F THREADED HEX STANDOFF
	8	20912	1	WAVE SPRING --- 3000 SERIES
	9	SEE CHART	1	ASSEMBLY, GEAR CARRIER
	10	20911	2	BELLEVILLE WASHER
	11	20923	1	INLINE HEAD ASSY - 1/2 IN DRIVE
	12	20913	2	PIN, RETAINING
	13	26078	2	SHC SCREW, 4-40, BLACK OXIDE
	14	26080	1	O-RING, LED LIGHT RING COVER
	15	26079	1	LIGHT RING COVER, LED
	16	26085	1	PISTOL HANDLE
	17	24934	2	SCREW, FHC 4-40 X .312, STEEL, BLACK OXIDE
	18	26103	1	TOOL CONNECTOR ASM., PISTOL
	19	25849	1	T.I.D. BOARD ASM., PISTOL
	20	25745	5	SCREW, BHSC 4-40 STEEL, BLACK OXIDE
	21	26089	4	SCREW, BHSC 6-32X.625, STEEL, BLACK OXIDE
	22	20534	1	3000 SERIAL/MODEL LABEL
	23	25212	1	SWITCH SUB-ASSEMBLY
NOT SHOWN	24	25788	1	CABLE ASM., TRIGGER
	25	26081	1	MOTOR HOUSING COVER
	26	26087	1	END CAP, PISTOL MOTOR
	27	22141	1	SAFETY LABEL
	28	27310	1	REACTION BAR, STEEL, 75-230Nm
	29	20455	1	FIXTURE NUT, INLINE --- 3000 SERIES
	30	26839	1	PISTOL LED BOARD ASM.
	31	25385	4	SCREW, FHSC 6-32 X .375, STEEL
	32	27596	2	SCREW, PLASTITE, FH TORX, 8-16 X .500, SS

MODEL NO.	GEAR TRAIN ASM.	GEAR CARRIER ASM.
AEP35075AV	26116	20924
AEP35090AV	26115	26117
AEP35110AV	26114	20924
AEP35135AV	26113	26117
AEP35170AV	26111	26117

◆ ASSEMBLY INSTRUCTIONS  
 ◻ SUB-ASSEMBLY

- 1) GEARS & SPLINES: LUBRICATE WITH DOW CORNING MOLYKOTE BR2 PLUS GREASE.
- 2) BEARINGS: LUBRICATE WITH CHEVRON SR1 GREASE
- 3) O-RINGS: LUBRICATE WITH O-RING LUBE

REQUIRED TOOLING
LOCTITE 243 (BLUE)
1/16 HEX WRENCH
5/64 HEX WRENCH
3/32 HEX WRENCH
7/32 HEX WRENCH
T6 TORX DRIVER
T15 TORX DRIVER

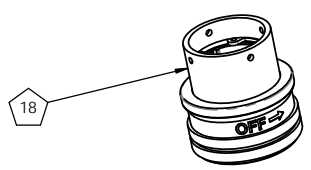

**DOCUMENT CONTROL**  
 PRINTED COPIES OF THIS DOCUMENT ARE CONSIDERED TO BE UNCONTROLLED DOCUMENTS. HOLDERS ARE RESPONSIBLE FOR VERIFYING THE CURRENT REVISION LEVEL WITH PURCHASING OR ENGINEERING PRIOR TO USE OR FABRICATION. THE CONTROLLED VERSION OF THIS DOCUMENT IS ELECTRONICALLY MAINTAINED.

**PROPRIETARY AND CONFIDENTIAL**  
 THIS DRAWING CONTAINS INFORMATION STRICTLY CONFIDENTIAL TO ACRADYNE/AIMCO. IN THE ABSENCE OF EXPRESSED WRITTEN PERMISSION, ACRADYNE/AIMCO HAS LOANED THIS COPY WITH THE MUTUAL UNDERSTANDING THAT (A) IT WILL NOT BE USED FOR ANY PURPOSE OTHER THAN FOR THAT IN WHICH IT WAS PROVIDED, (B) THE DATA CONTAINED HEREIN WILL NOT BE DISCLOSED TO OTHERS, (C) IT WILL NOT BE REPRODUCED, AND (D) IT WILL BE RETURNED TO ACRADYNE/AIMCO IMMEDIATELY UPON DEMAND.

REVISION LEVEL	REVISION RELEASE DATE	DESCRIPTION OF CHANGES MADE TO PART	ECN #	AUTHOR/ APPROVAL

**UNLESS OTHERWISE SPECIFIED, DIMENSIONS ARE IN INCHES**  
 DIMENSIONS AND TOLERANCING PER ANSI Y14.5  
 SURFACE ROUGHNESS PER ANSI Y14.36

**BLOCK TOLERANCING PER DECIMAL:**  
 .X = ±.030 .XX = ±.010 .XXX = ±.005 .XXXX = ±.0005  
 ANGLE = 40°/30°

REMOVE BURRS AND SHARP EDGES: R.015 MAX  
 MACHINE SURFACE FINISH: 125 RMS OR BETTER

DRAWINGS AND TECHNICAL DOCUMENTS CONTROLLED BY:  
**ACRADYNE MECHANICAL ENGINEERING**

**AEP35\_\_A\_\_ PISTOL NUTRUNNER**  
 5000 SERIES, GEN 3

SIZE	PART / DRAWING NUMBER	REVISION
D	AEP35__A__	J

SCALE: 3:4 DO NOT SCALE DRAWING SHEET 1 OF 4

COMMENTS	ITEM NO.	PART NUMBER	QTY.	DESCRIPTION
	1	26213	1	PISTOL MOTOR ASSEMBLY
	2	26198	1	THRUST WASHER
	3	26074	1	BELLEVILLE WASHER
	4	SEE CHART	1	GEARBOX ASM. - TRIPLE STEP
	5	26530	2	DOWEL PIN, $\phi 1/8 \times 1.00$ , STEEL
	6	27391	1	PIN RETAINER RING
	7	26077	2	M-F THREADED HEX STANDOFF
	8	26078	2	SHC SCREW, 4-40, BLACK OXIDE
	9	26080	1	O-RING, LED LIGHT RING COVER
	10	26079	1	LIGHT RING COVER, LED
	11	26085	1	PISTOL HANDLE
	12	24934	2	SCREW, FHC 4-40 X .312, STEEL, BLACK OXIDE
	13	25849	1	T.I.D. BOARD ASM., PISTOL
	14	25745	5	SCREW, BHSC 4-40 STEEL, BLACK OXIDE
	15	26089	4	SCREW, BHSC 6-32X.625, STEEL, BLACK OXIDE
	16	20534	1	3000 SERIAL/MODEL LABEL
	17	25212	1	SWITCH SUB-ASSEMBLY
NOT SHOWN	18	25788	1	CABLE ASM., TRIGGER
	19	26081	1	MOTOR HOUSING COVER
	20	26087	1	END CAP, PISTOL MOTOR
	21	22141	1	SAFETY LABEL
	22	27315	1	REACTION BAR, STEEL, 280-635Nm
	23	23792	1	RETAINING NUT, HEX
	24	26839	1	PISTOL LED BOARD ASM.
	25	26103	1	TOOL CONNECTOR ASM., PISTOL
	26	27596	2	SCREW, PLASTITE, FH TORX, 8-16 X .500, SS
	27	25385	4	SCREW, FHSC 6-32 X .375, STEEL

MODEL NO.	GEARBOX ASM.
AEP35280A	26202
AEP35350A	26203
AEP35420A	26201
AEP35515A	26200
AEP35635A	26129

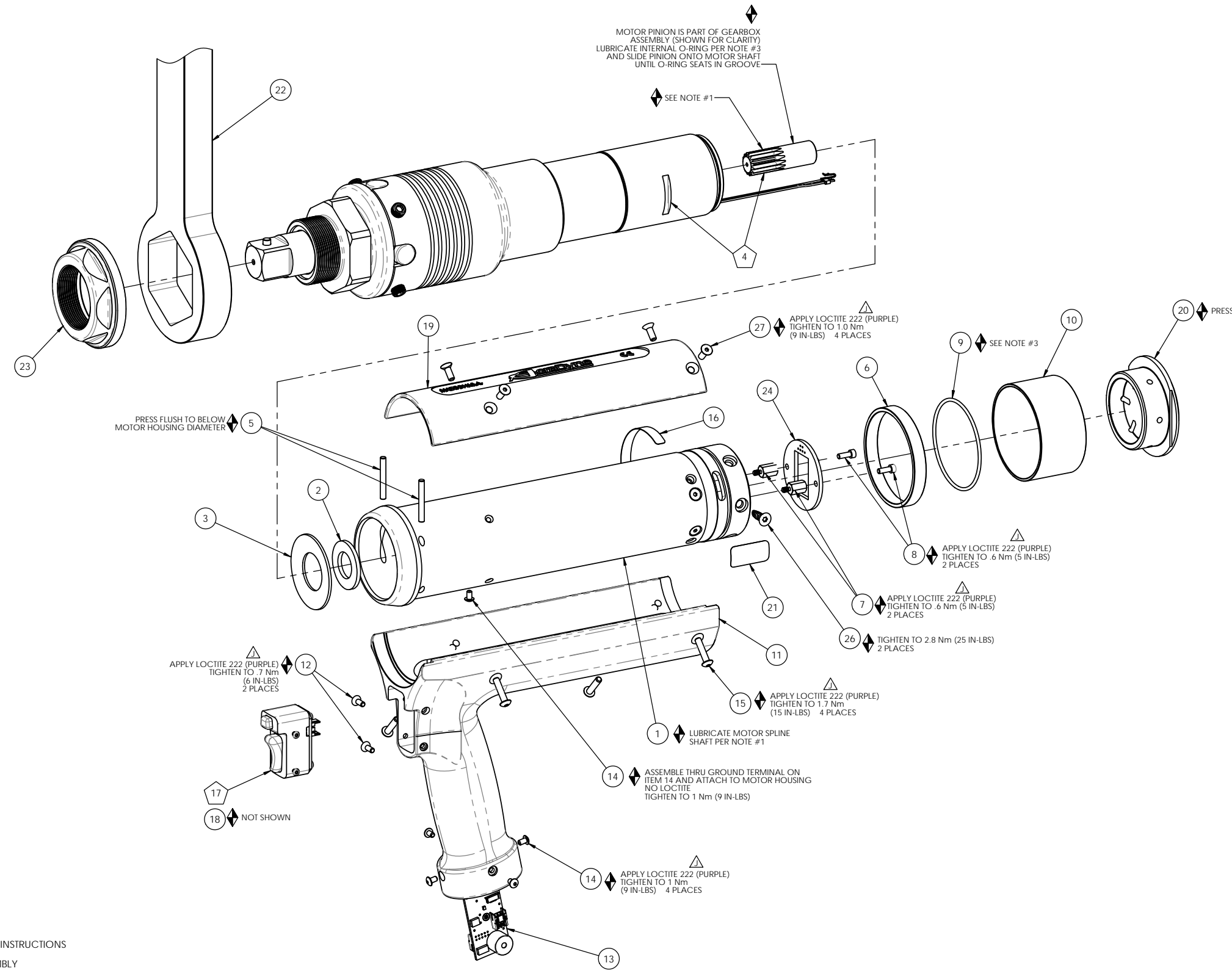

- ◆ ASSEMBLY INSTRUCTIONS
  - ◻ SUB-ASSEMBLY
- 1) GEARS & SPLINES: LUBRICATE WITH DOW CORNING MOLYKOTE BR2 PLUS GREASE.
  - 2) BEARINGS: LUBRICATE WITH CHEVRON SR1 GREASE
  - 3) O-RINGS: LUBRICATE WITH O-RING LUBE

REQUIRED TOOLING
LOCTITE 243 (BLUE)
1/16 HEX WRENCH
5/64 HEX WRENCH
3/32 HEX WRENCH
T6 TORX DRIVER
T15 TORX DRIVER

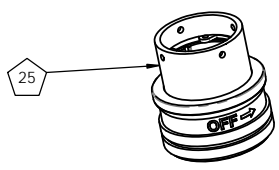

**DOCUMENT CONTROL**  
 PRINTED COPIES OF THIS DOCUMENT ARE CONSIDERED TO BE UNCONTROLLED DOCUMENTS. HOLDERS ARE RESPONSIBLE FOR VERIFYING THE CURRENT REVISION LEVEL WITH PURCHASING OR ENGINEERING PRIOR TO USE OR FABRICATION. THE CONTROLLED VERSION OF THIS DOCUMENT IS ELECTRONICALLY MAINTAINED.

**PROPRIETARY AND CONFIDENTIAL**  
 THIS DRAWING CONTAINS INFORMATION STRICTLY CONFIDENTIAL TO ACRADYNE/AIMCO. IN THE ABSENCE OF EXPRESSED WRITTEN PERMISSION, ACRADYNE/AIMCO HAS LOANED THIS COPY WITH THE MUTUAL UNDERSTANDING THAT (A) IT WILL NOT BE USED FOR ANY PURPOSE OTHER THAN FOR THAT IN WHICH IT WAS PROVIDED, (B) THE DATA CONTAINED HEREIN WILL NOT BE DISCLOSED TO OTHERS, (C) IT WILL NOT BE REPRODUCED, AND (D) IT WILL BE RETURNED TO ACRADYNE/AIMCO IMMEDIATELY UPON DEMAND.

REVISION LEVEL	REVISION RELEASE DATE	DESCRIPTION OF CHANGES MADE TO PART	ECN #	AUTHOR/ APPROVAL

**REVISION BLOCK**

**UNLESS OTHERWISE SPECIFIED, DIMENSIONS ARE IN INCHES**  
 DIMENSIONS AND TOLERANCING PER ANSI Y14.5 SURFACE ROUGHNESS PER ANSI Y14.36

**BLOCK TOLERANCING PER DECIMAL:**  
 .X =  $\pm 0.030$  .XX =  $\pm 0.010$  .XXX =  $\pm 0.005$  .XXXX =  $\pm 0.0005$   
 ANGLE =  $10^{\circ} 30'$

REMOVE BURRS AND SHARP EDGES: R.015 MAX MACHINE SURFACE FINISH: 125 RMS OR BETTER

**DRAWINGS AND TECHNICAL DOCUMENTS CONTROLLED BY:**  
 ACRADYNE MECHANICAL ENGINEERING

<b>AEP35__A__ PISTOL NUTRUNNER</b> 5000 SERIES, GEN 3		
SIZE	PART / DRAWING NUMBER	REVISION
<b>D</b>	<b>AEP35__A__</b>	<b>J</b>
SCALE 3:4	DO NOT SCALE DRAWING	SHEET 2 OF 4

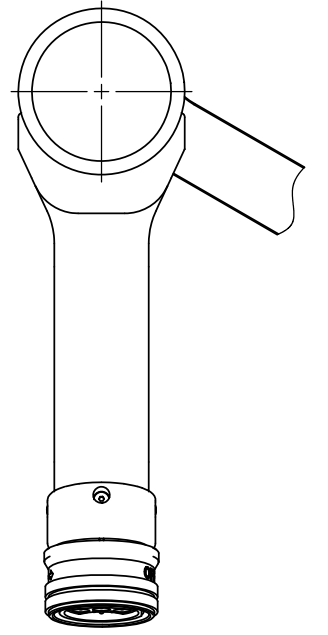
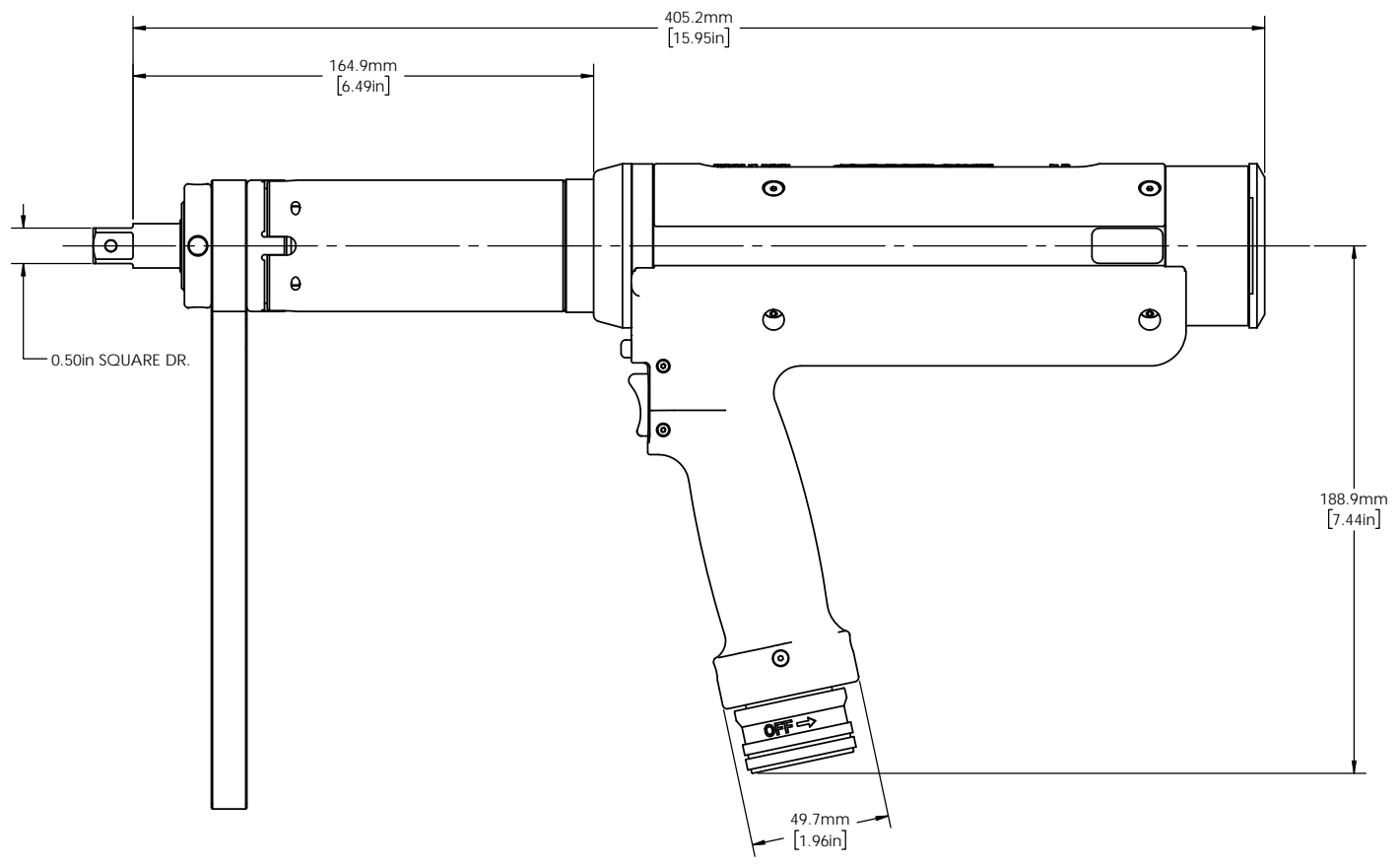
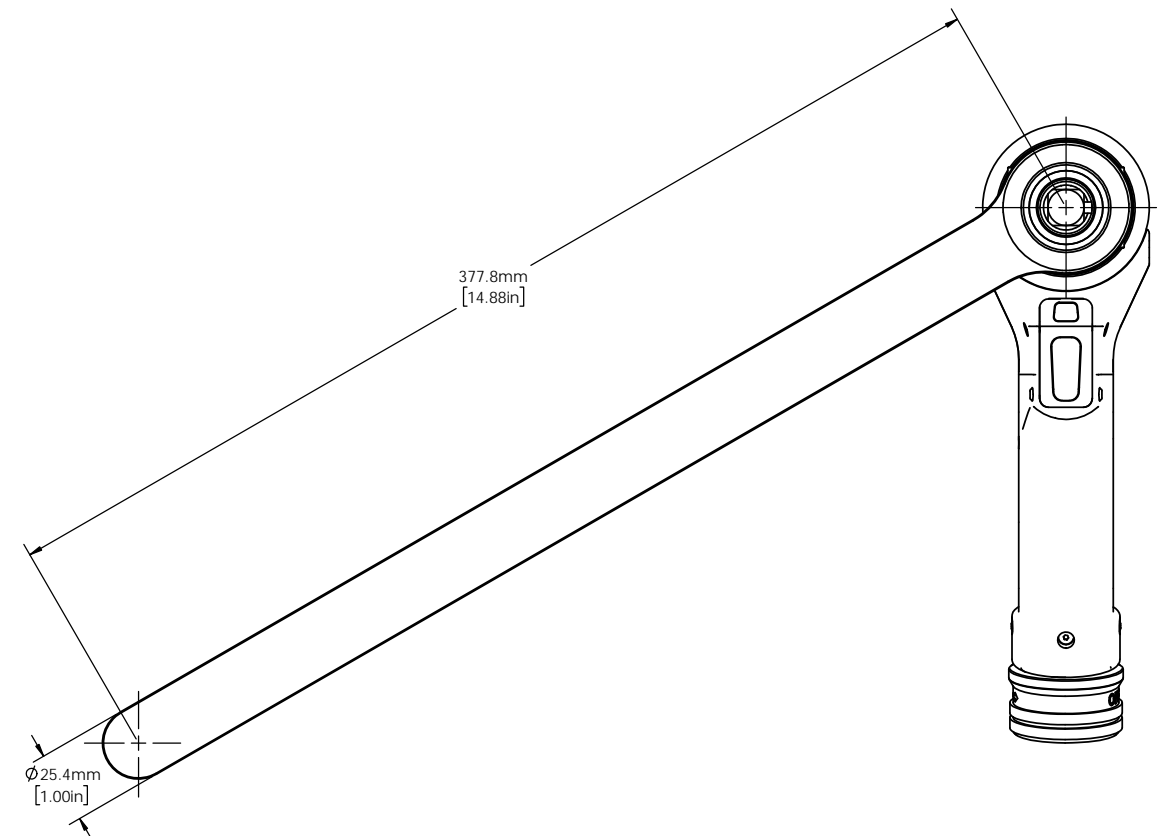
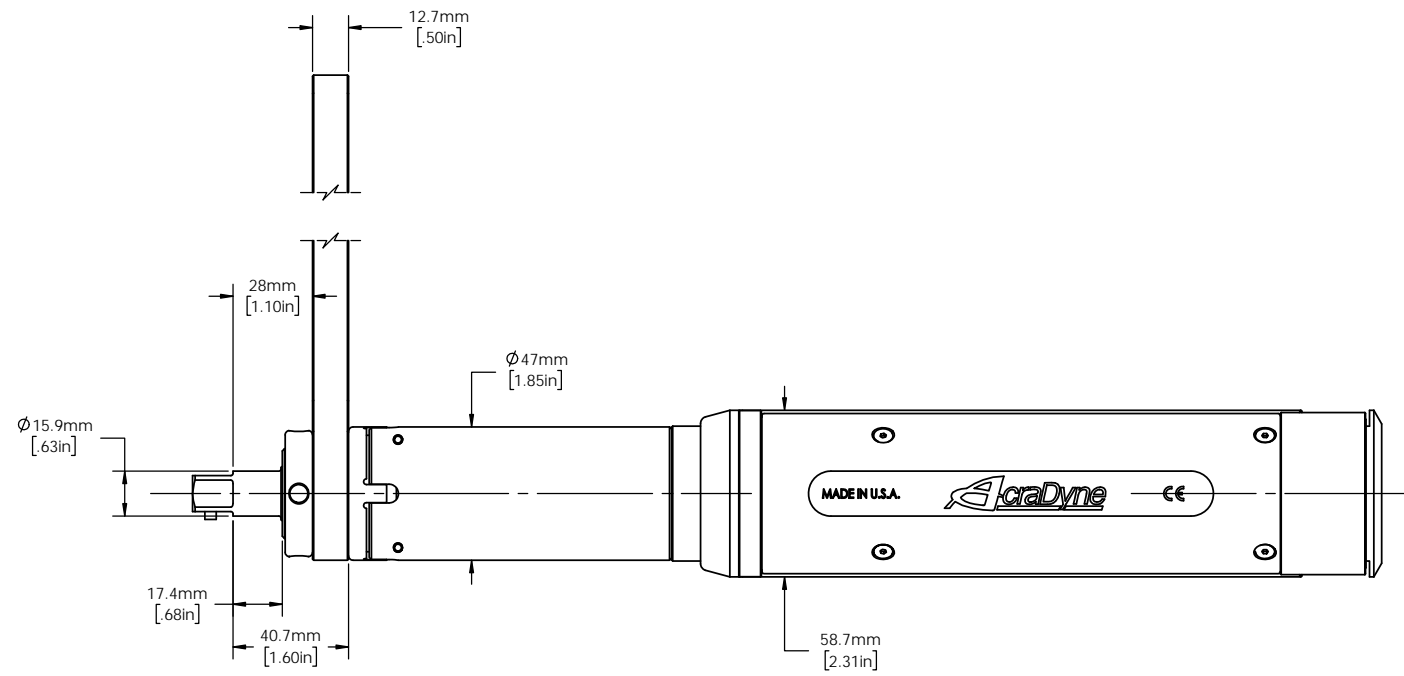
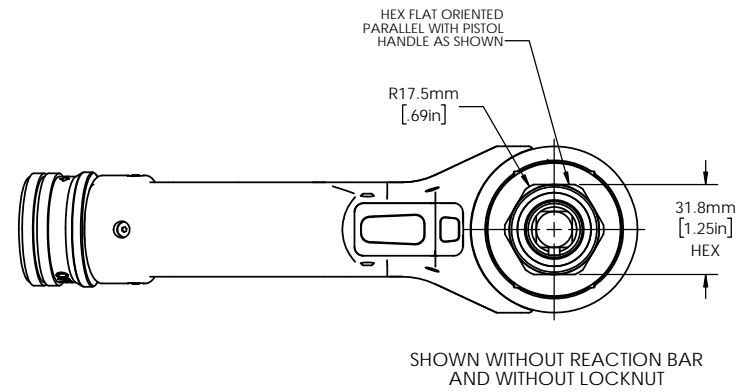

MODEL NO.	AEP35075AV
	AEP35090AV
	AEP35110AV
	AEP35135AV
	AEP35170AV
CATALOG NO.	AEP35075AV
	AEP35090AV
	AEP35110AV
	AEP35135AV
	AEP35170AV



**DOCUMENT CONTROL**  
 PRINTED COPIES OF THIS DOCUMENT ARE CONSIDERED TO BE UNCONTROLLED DOCUMENTS. HOLDERS ARE RESPONSIBLE FOR VERIFYING THE CURRENT REVISION LEVEL WITH PURCHASING OR ENGINEERING PRIOR TO USE OR FABRICATION. THE CONTROLLED VERSION OF THIS DOCUMENT IS ELECTRONICALLY MAINTAINED.

**PROPRIETARY AND CONFIDENTIAL**  
 THIS DRAWING CONTAINS INFORMATION STRICTLY CONFIDENTIAL TO ACRADYNE/AIMCO. IN THE ABSENCE OF EXPRESSED WRITTEN PERMISSION, ACRADYNE/AIMCO HAS LOANED THIS COPY WITH THE MUTUAL UNDERSTANDING THAT (A) IT WILL NOT BE USED FOR ANY PURPOSE OTHER THAN FOR THAT IN WHICH IT WAS PROVIDED, (B) THE DATA CONTAINED HEREIN WILL NOT BE DISCLOSED TO OTHERS, (C) IT WILL NOT BE REPRODUCED, AND (D) IT WILL BE RETURNED TO ACRADYNE/AIMCO IMMEDIATELY UPON DEMAND.

REVISION LEVEL	REVISION RELEASE DATE	DESCRIPTION OF CHANGES MADE TO PART	ECN #	AUTHOR/ APPROVAL

**UNLESS OTHERWISE SPECIFIED, DIMENSIONS ARE IN INCHES**  
 DIMENSIONS AND TOLERANCING PER ANSI Y14.5  
 SURFACE ROUGHNESS PER ANSI Y14.36

**BLOCK TOLERANCING PER DECIMAL:**  
 .X = ±.030 .XX = ±.010 .XXX = ±.005 .XXXX = ±.0005  
 ANGLE = ±0° 30'

REMOVE BURRS AND SHARP EDGES: R.015 MAX  
 MACHINE SURFACE FINISH: 125 RMS OR BETTER

DRAWINGS AND TECHNICAL DOCUMENTS CONTROLLED BY:  
**ACRADYNE MECHANICAL ENGINEERING**

**AEP35\_\_A\_\_**  
**TOOL OUTLINE**  
 5000 SERIES, GEN 3

SIZE	PART / DRAWING NUMBER	REVISION
<b>D</b>	<b>AEP35__A__</b>	<b>J</b>
SCALE: 3:4	DO NOT SCALE DRAWING	SHEET 3 OF 4

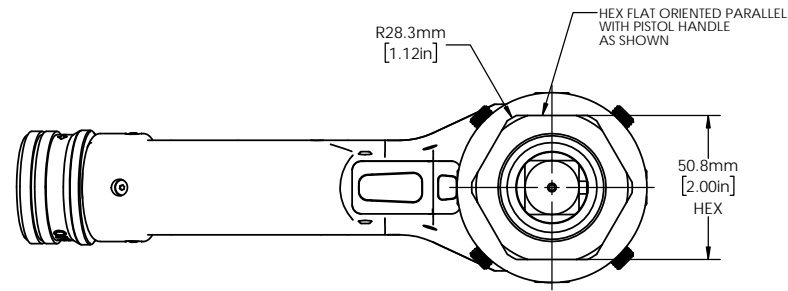

SHOWN WITHOUT REACTION BAR AND WITHOUT LOCKNUT

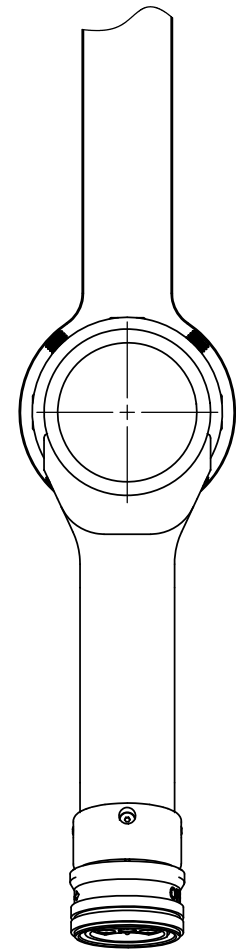
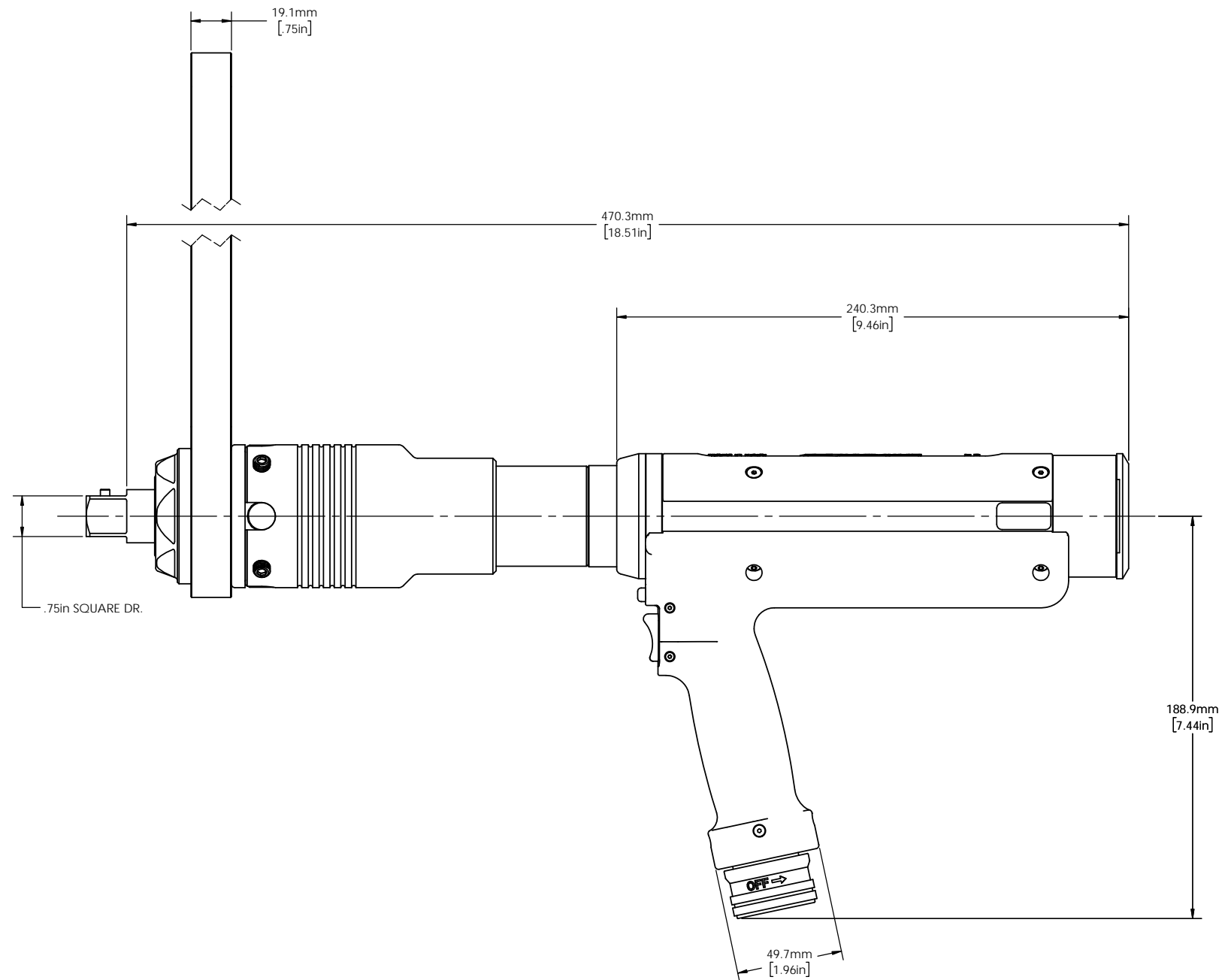
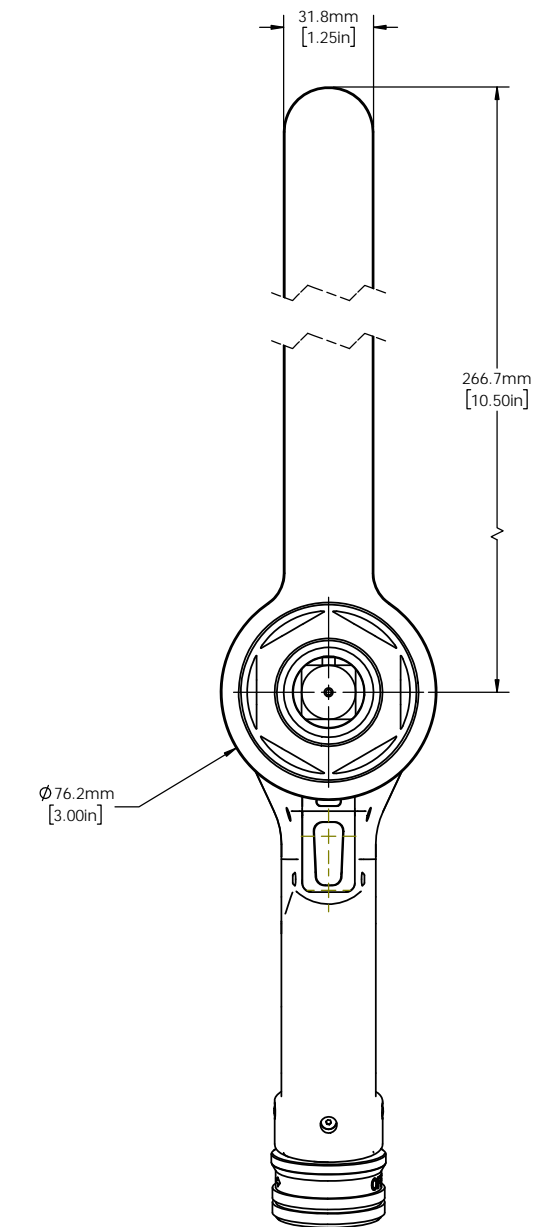
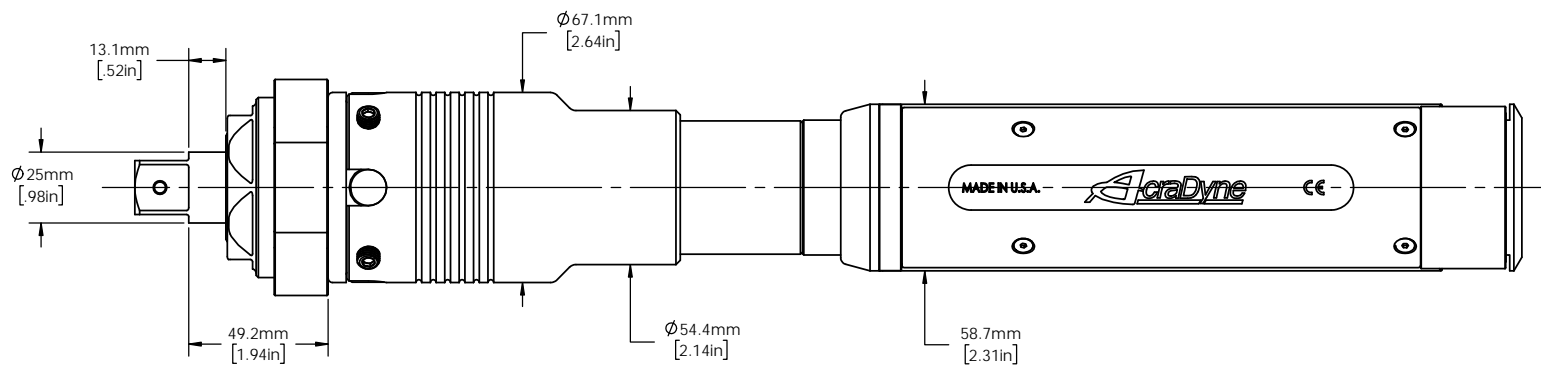

CATALOG NO.	MODEL NO.
	AEP35280A
	AEP35350A
	AEP35420A
	AEP35515A
AEP35635A	

10000 SE PINE STREET  
PORTLAND, OREGON 97216  
503.254.6600

**DOCUMENT CONTROL**  
PRINTED COPIES OF THIS DOCUMENT ARE CONSIDERED TO BE UNCONTROLLED DOCUMENTS. HOLDERS ARE RESPONSIBLE FOR VERIFYING THE CURRENT REVISION LEVEL WITH PURCHASING OR ENGINEERING PRIOR TO USE OR FABRICATION. THE CONTROLLED VERSION OF THIS DOCUMENT IS ELECTRONICALLY MAINTAINED.

**PROPRIETARY AND CONFIDENTIAL**  
THIS DRAWING CONTAINS INFORMATION STRICTLY CONFIDENTIAL TO ACRADYNE/AIMCO. IN THE ABSENCE OF EXPRESSED WRITTEN PERMISSION, ACRADYNE/AIMCO HAS LOANED THIS COPY WITH THE MUTUAL UNDERSTANDING THAT (A) IT WILL NOT BE USED FOR ANY PURPOSE OTHER THAN FOR THAT IN WHICH IT WAS PROVIDED, (B) THE DATA CONTAINED HEREIN WILL NOT BE DISCLOSED TO OTHERS, (C) IT WILL NOT BE REPRODUCED, AND (D) IT WILL BE RETURNED TO ACRADYNE/AIMCO IMMEDIATELY UPON DEMAND.

REVISION LEVEL	REVISION RELEASE DATE	DESCRIPTION OF CHANGES MADE TO PART	ECN #	AUTHOR/ APPROVAL

**UNLESS OTHERWISE SPECIFIED, DIMENSIONS ARE IN INCHES**  
DIMENSIONS AND TOLERANCING PER ANSI Y14.5  
SURFACE ROUGHNESS PER ANSI Y14.36

**BLOCK TOLERANCING PER DECIMAL:**  
.X = ±.030 .XX = ±.010 .XXX = ±.005 .XXXX = ±.0005  
ANGLE = ±0°30'

REMOVE BURRS AND SHARP EDGES: R.015 MAX  
MACHINE SURFACE FINISH: 125 RMS OR BETTER

**DRAWINGS AND TECHNICAL DOCUMENTS CONTROLLED BY:**  
**ACRADYNE MECHANICAL ENGINEERING**

<b>AEP35__A__ TOOL OUTLINE</b>		
5000 SERIES, GEN 3		
SIZE <b>D</b>	PART / DRAWING NUMBER <b>AEP35__A__</b>	REVISION <b>J</b>
SCALE 3:4	DO NOT SCALE DRAWING	SHEET 4 OF 4