

END CAP REMOVED FOR CLARITY

APPLY LOCTITE #243 (BLUE) TIGHTEN TO 3.5 Nm (31 IN-LBS) 6 PLACES (7)

CONNECT FEMALE END TO CONNECTOR ON RING GEAR. ATTACH GROUND LUG TO TAPPED HOLE IN BOTTOM OF MOTOR ASM. (1) WITH SCREW (4). FEED MALE END THRU THE BOTTOM HOLE IN MOTOR HOUSING AND ATTACH IT TO MATING CONNECTOR ON ITEM (3).

TIGHTEN TO .3 (3 IN-LBS) 4 PLACES (16)

MODEL NO.	GEAR BOX ASM.
AEP4A66250B	28658
AEP4A66425B	28798
AEP4A66625B	28108
AEP4A66925B	28109

COMMENTS	ITEM NO.	PART NUMBER	QTY.	DESCRIPTION
	1	26481	1	MOTOR ASM.
	2	25574	5	STANDOFF M-F, 4-40x1/4, 3/16 HEX, SS
	3	27727	1	TID BOARD, POPULATED W/AMP
	4	25573	5	SCREW PHP 4-40 X 3/16 18-8 SS
	5	26488	1	O-RING, MOTOR HOUSING
	6	26299	1	O-RING, PINION
	7	29285	6	SCREW, BHSC, TORX, 8-32 x .38, STEEL
	8	SEE CHART	1	GEAR BOX ASM.
	9	26275	1	HANDLE, PISTOL
	10	26206	6	SCREW, BHSC 10-32 X .375, STEEL
	11	26288	1	TOOL CONNECTOR ASM., PISTOL
	12	25745	4	SCREW, BHSC 4-40 STEEL, BLACK OXIDE
	13	26289	1	SWITCH SUB-ASSEMBLY
NOT SHOWN	14	26526	1	TRIGGER CABLE ASM.
NOT SHOWN	15	27464	A/R	TWISTED WAXED LINEN TWINE
	16	28211	1	(4) LINE MALE/FEMALE JUMPER ASM.
	17	26224	1	TRAY, WIRE, PISTOL
	18	20534	1	SERIAL/MODEL LABEL
	19	26487	1	O-RING, LED COVER
	20	26483	1	LED COVER
	21	26482	1	END CAP, PISTOL
	22	26525	1	PLUG 5/16"
	23	26495	1	GEAR CASE COVER
	24	26319	3	SCREW, BHSC 6-32 X .188, 18-8 SS
	25	26896	1	CHOOSE REACTION BAR
	26	26514	1	RETAINING RING, SPIRAL, Ø2.441 X Ø2.105 X .078
	27	27401	4	SCREW, BHSC 10-32 X 1.25, STEEL, BLK OXIDE
	28	29336	1	TID BOARD WIRE INSULATOR
	29	29337	3	STANDOFF, M-F, 4-40 X 1/8, SS

◆ ASSEMBLY INSTRUCTIONS
 ◊ SUB-ASSEMBLY

- 1) GEARS & SPLINES: LUBRICATE WITH DOW CORNING MOLYKOTE BR2 PLUS GREASE.
- 2) BEARINGS: LUBRICATE WITH CHEVRON SR1 GREASE
- 3) O-RINGS: LUBRICATE WITH O-RING LUBE



DOCUMENT CONTROL
 PRINTED COPIES OF THIS DOCUMENT ARE CONSIDERED TO BE UNCONTROLLED DOCUMENTS. HOLDERS ARE RESPONSIBLE FOR VERIFYING THE CURRENT REVISION LEVEL WITH PURCHASING OR ENGINEERING PRIOR TO USE OR FABRICATION. THE CONTROLLED VERSION OF THIS DOCUMENT IS ELECTRONICALLY MAINTAINED.

PROPRIETARY AND CONFIDENTIAL
 THIS DRAWING CONTAINS INFORMATION STRICTLY CONFIDENTIAL TO ACRADYNE/AIMCO. IN THE ABSENCE OF EXPRESSED WRITTEN PERMISSION, ACRADYNE/AIMCO HAS LOANED THIS COPY WITH THE MUTUAL UNDERSTANDING THAT (A) IT WILL NOT BE USED FOR ANY PURPOSE OTHER THAN FOR THAT IN WHICH IT WAS PROVIDED, (B) THE DATA CONTAINED HEREIN WILL NOT BE DISCLOSED TO OTHERS, (C) IT WILL NOT BE REPRODUCED, AND (D) IT WILL BE RETURNED TO ACRADYNE/AIMCO IMMEDIATELY UPON DEMAND.

REVISION LEVEL	REVISION RELEASE DATE	DESCRIPTION OF CHANGES MADE TO PART	ECN #	AUTHOR/ APPROVAL
REVISION BLOCK				

UNLESS OTHERWISE SPECIFIED, DIMENSIONS ARE IN INCHES
 DIMENSIONS AND TOLERANCING PER ANSI Y14.5 SURFACE ROUGHNESS PER ANSI Y14.36

BLOCK TOLERANCING PER DECIMAL:
 X = ±.030 XX = ±.010 XXX = ±.005 XXXX = ±.0005 ANGLE = ±0°30'

REMOVE BURRS AND SHARP EDGES: R.015 MAX MACHINE SURFACE FINISH: 125 RMS OR BETTER

DRAWINGS AND TECHNICAL DOCUMENTS CONTROLLED BY:
ACRADYNE MECHANICAL ENGINEERING

**PISTOL NUTRUNNER
6000 SERIES**

SIZE	PART / DRAWING NUMBER	REVISION
D	AEP4A66__B	A
SCALE 3:4	DO NOT SCALE DRAWING	SHEET 1 OF 2

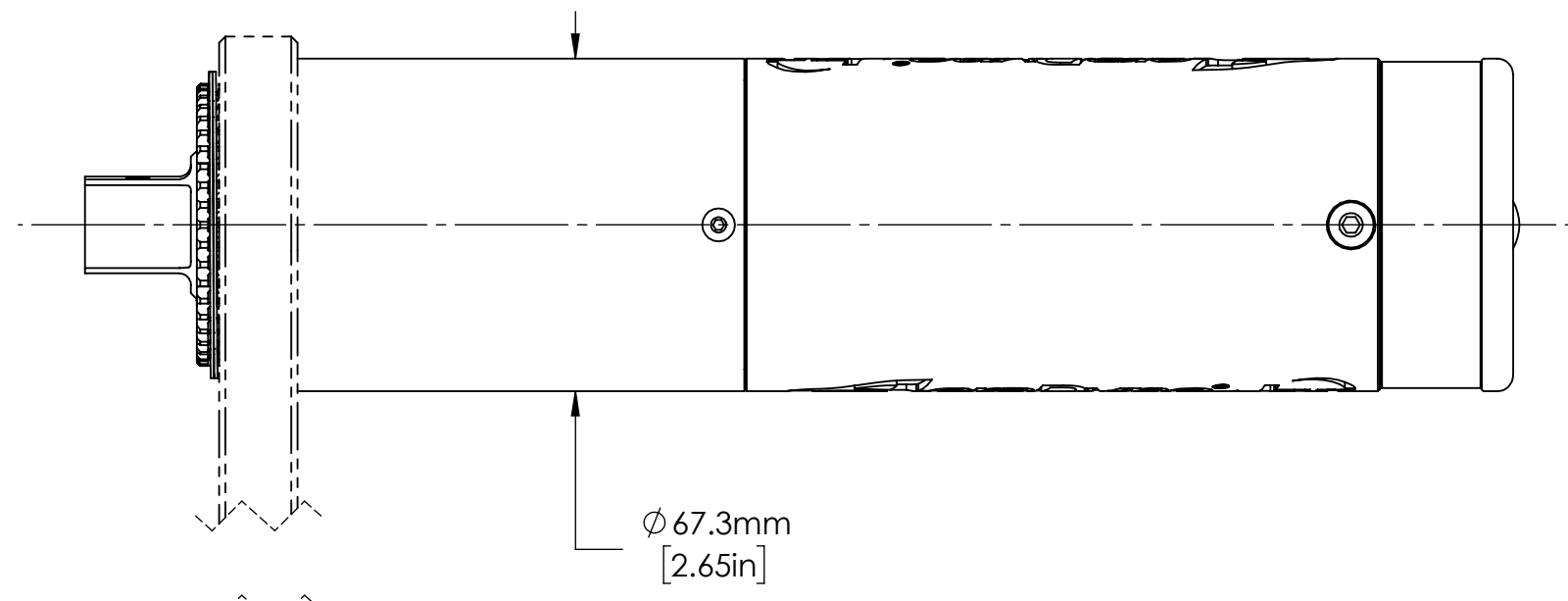

**NOTE:
REACTION BAR GEOMETRY
TO CHANGE DEPENDING
ON REACTION BAR CHOSEN.**

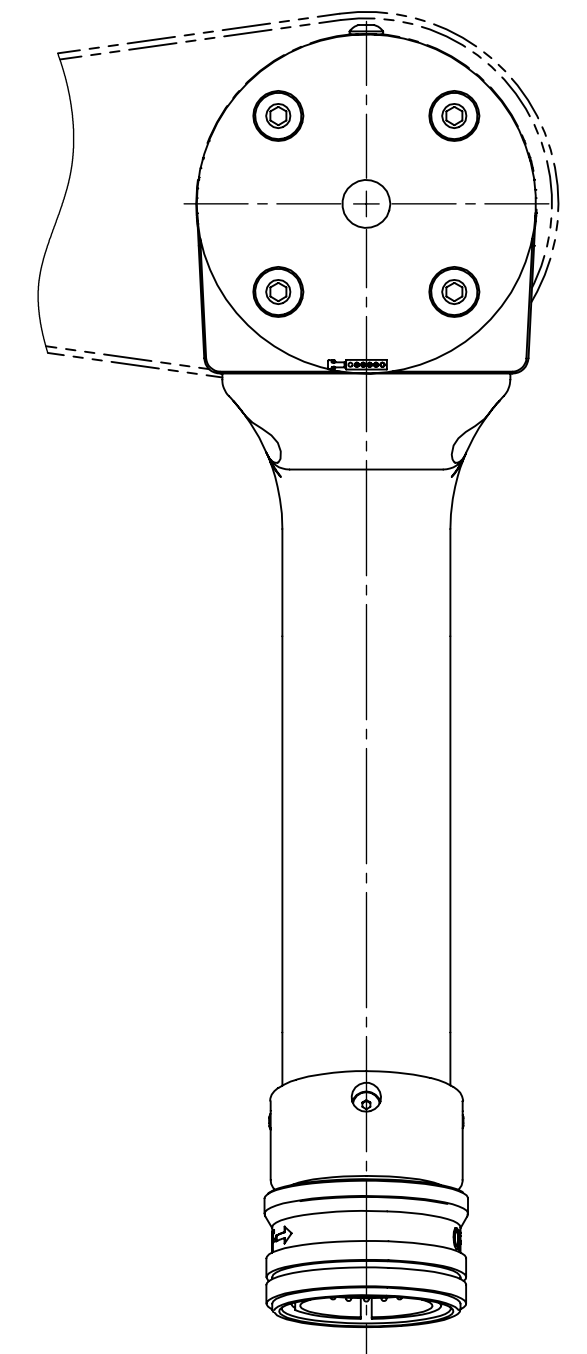
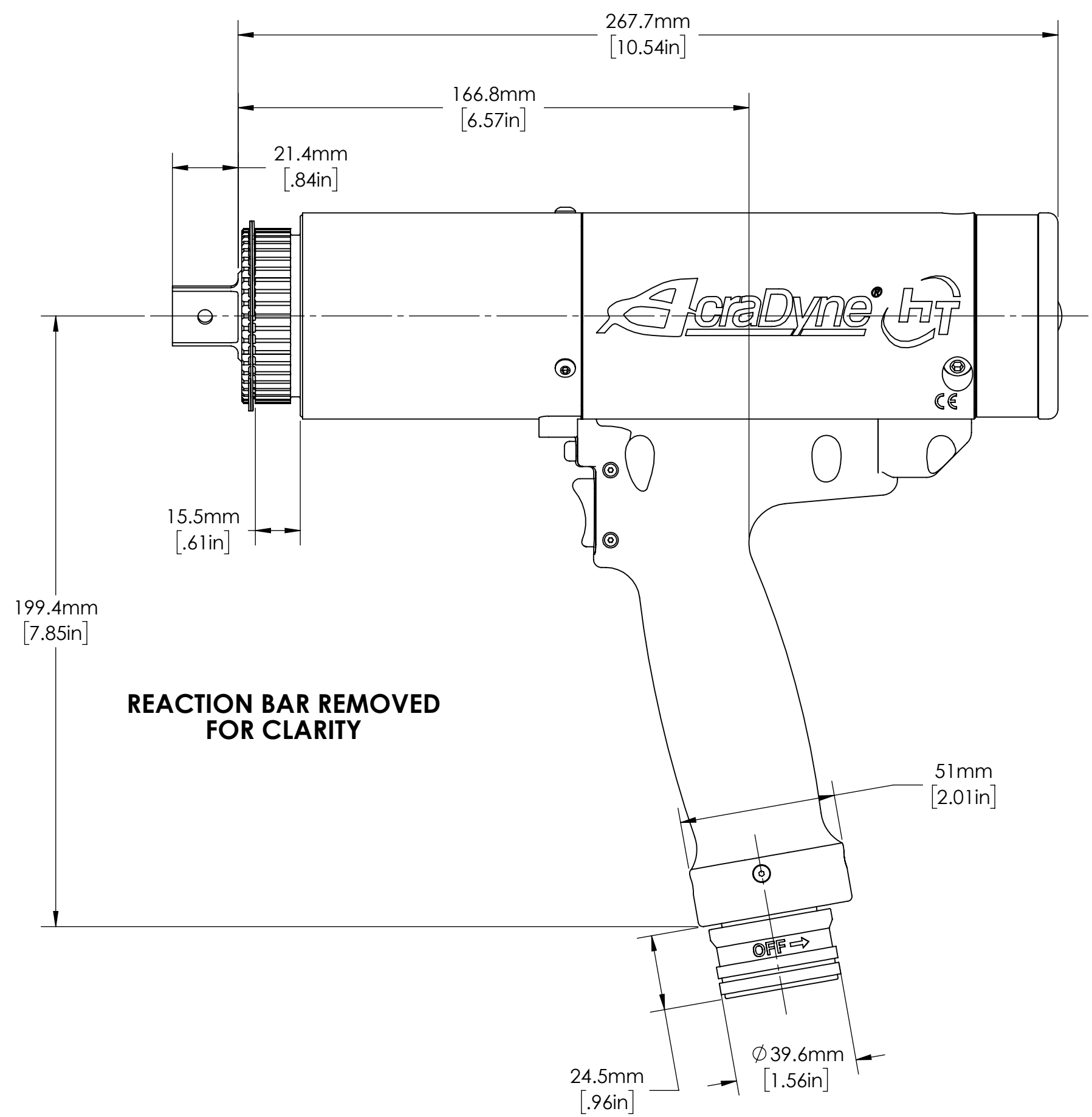
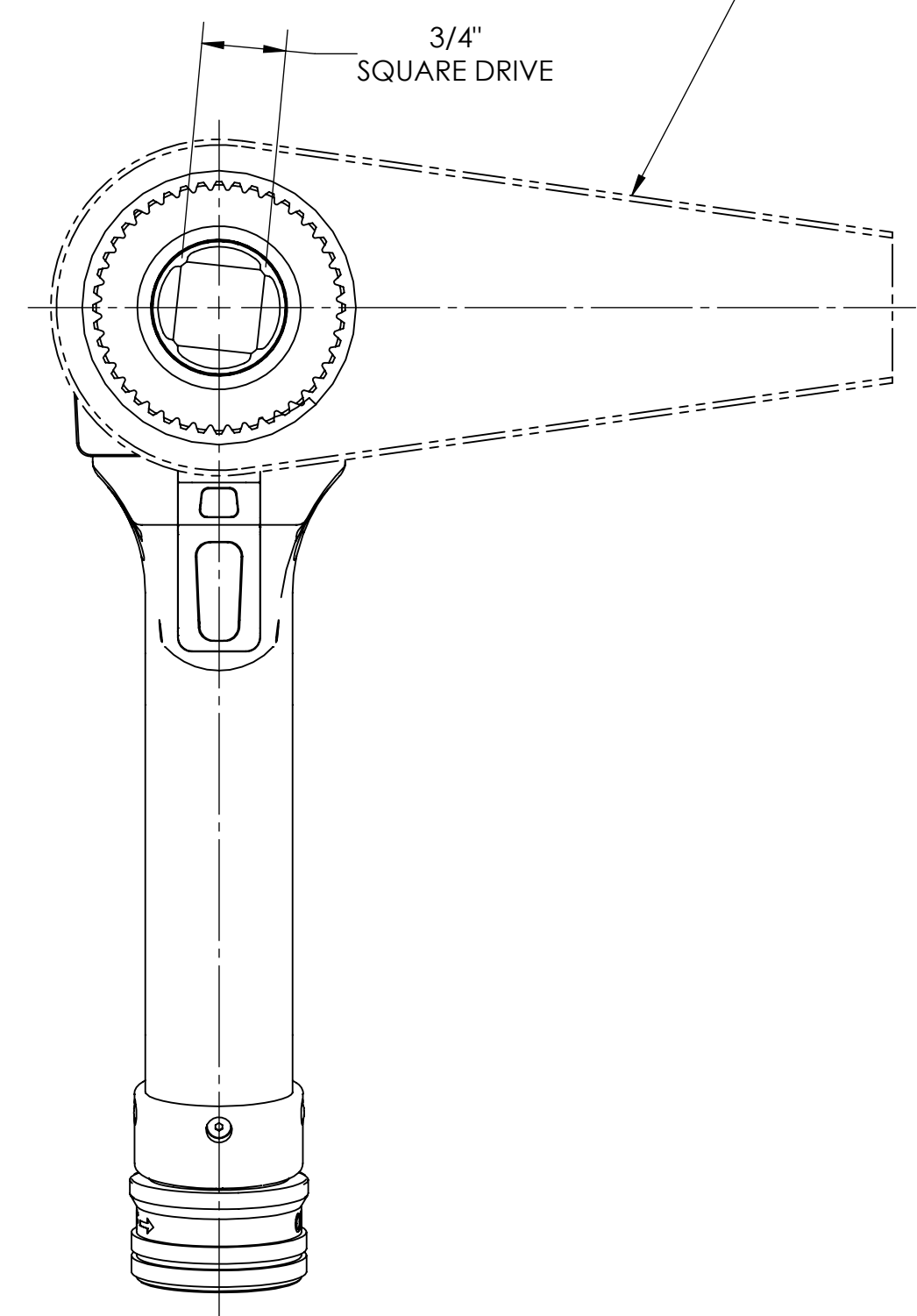

MODEL NO.
AEP4A66250B
AEP4A66425B
AEP4A66625B
AEP4A66925B

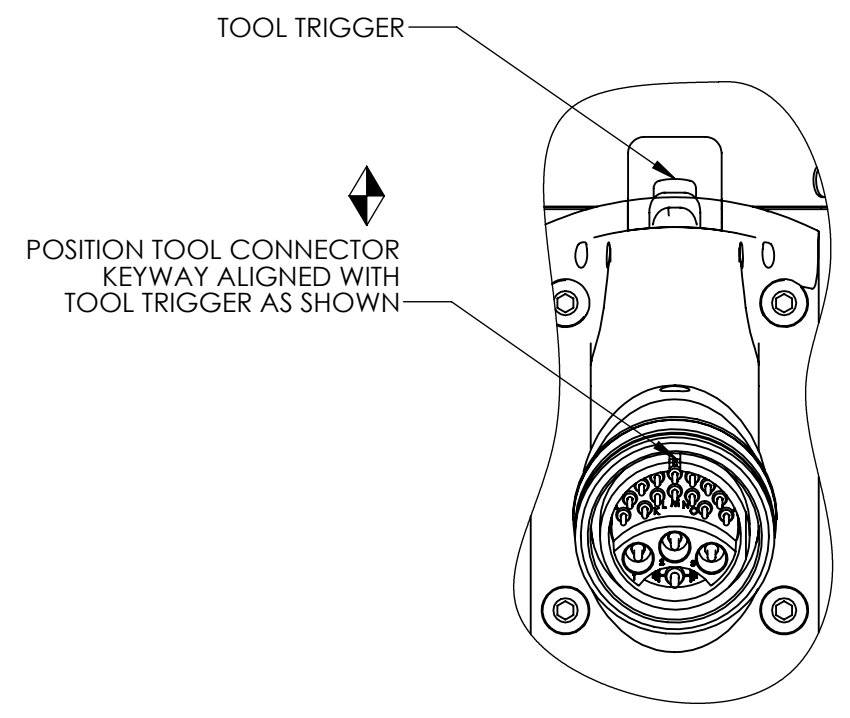

DOCUMENT CONTROL
PRINTED COPIES OF THIS DOCUMENT ARE CONSIDERED TO BE UNCONTROLLED DOCUMENTS. HOLDERS ARE RESPONSIBLE FOR VERIFYING THE CURRENT REVISION LEVEL WITH PURCHASING OR ENGINEERING PRIOR TO USE OR FABRICATION. THE CONTROLLED VERSION OF THIS DOCUMENT IS ELECTRONICALLY MAINTAINED.

PROPRIETARY AND CONFIDENTIAL
THIS DRAWING CONTAINS INFORMATION STRICTLY CONFIDENTIAL TO ACRADYNE/AIMCO. IN THE ABSENCE OF EXPRESSED WRITTEN PERMISSION, ACRADYNE/AIMCO HAS LOANED THIS COPY WITH THE MUTUAL UNDERSTANDING THAT (A) IT WILL NOT BE USED FOR ANY PURPOSE OTHER THAN FOR THAT IN WHICH IT WAS PROVIDED, (B) THE DATA CONTAINED HEREIN WILL NOT BE DISCLOSED TO OTHERS, (C) IT WILL NOT BE REPRODUCED, AND (D) IT WILL BE RETURNED TO ACRADYNE/AIMCO IMMEDIATELY UPON DEMAND.

REVISION LEVEL	REVISION RELEASE DATE	DESCRIPTION OF CHANGES MADE TO PART	ECN #	AUTHOR/ APPROVAL
REVISION BLOCK				

UNLESS OTHERWISE SPECIFIED, DIMENSIONS ARE IN INCHES
DIMENSIONS AND TOLERANCING PER ANSI Y14.5
SURFACE ROUGHNESS PER ANSI Y14.36

BLOCK TOLERANCING PER DECIMAL:
X = ±.030 XX = ±.010 XXX = ±.005 XXXX = ±.0005
ANGLE = ±0° 30'

REMOVE BURRS AND SHARP EDGES: R.015 MAX
MACHINE SURFACE FINISH: 125 RMS OR BETTER

**DRAWINGS AND TECHNICAL DOCUMENTS CONTROLLED BY:
ACRADYNE MECHANICAL ENGINEERING**

PISTOL NUTRUNNER 6000 SERIES		
SIZE	PART / DRAWING NUMBER	REVISION
D	AEP4A66__B	A
SCALE: 2:3	DO NOT SCALE DRAWING	SHEET 2 OF 2