

MODEL NO.	MOTOR ASSY	1ST STAGE CARRIER ASM.	TRANSDUCER ASM.
AES33400C	25530	20086	25815
AES33600C	25525	20101	25816

ITEM NO.	PART NUMBER	QTY.	DESCRIPTION
1	27031	1	MOTOR HOUSING ASSEMBLY
2	SEE CHART	1	MOTOR ASSY, 1.5 T, 3000 SERIES
3	25063	1	LED BOARD ASM.
4	25075	2	SCREW, SHC 4-40X.375, STEEL, BLACK OXIDE
5	25430	2	STAND-OFF, LED, 3000 SERIES
6	27027	1	SCREW, SET 5-40X.188,STEEL,BLK OXIDE
7	25842	1	ASM. GEARBOX, QUAD STAGE
8	20049	1	BALL BEARING, 1.120 X .4720 IN
9	20916	1	TRANSFER SHAFT, TRIPLE STAGE, 14T --- 3000 SERIES
10	25829	1	PINION BEARING RETAINER
11	SEE CHART	1	TRANSDUCER SUB-ASM., 28Nm
12	25077	1	RING GEAR, 41 TOOTH
13	25085	1	RETAINING RING - RING GEAR
14	25090	1	2ND STAGE CARRIER ASM.
15	SEE CHART	1	1ST STAGE CARRIER ASSEMBLY
16	20111	1	WAVE SPRING WASHER
17	25076	1	RETAINER, BEARING
18	25796	1	O-RING, TRANSDUCER
19	25837	1	O-RING, BEARING RETAINER
20	26793	2	RETAINING PIN, .125 OD X 1-1/4
21	26102	1	TOOL CONNECTOR ASM., LEVER
22	25745	5	SCREW, BHSC 4-40 STEEL, BLACK OXIDE
23	25847	1	TID BOARD ASM.
24	24934	2	SCREW, FHC 4-40 X .312, STEEL, BLACK OXIDE
25	20132	1	THROTTLE SPRING
26	26532	1	GEN 3 TRIGGER ASSY, CAST
27	20061	2	SCREW, LEVER
28	25072	1	O-RING, LED LIGHT RING COVER
29	20534	1	3000 SERIAL/MODEL LABEL
30	25058	1	LIGHT RING COVER, LED
31	26084	1	HANDLE COVER, MFB
32	24706	1	REV BUTTON SUB-ASSEMBLY
33	24683	1	SPRING, REV BUTTON
34	24679	1	RETAINING RING
35	24940	10	SCREW, FHSC 4-40 X .25 LG., STEEL, BLACK OXIDE
36	26083	1	HANDLE COVER
37	23793	1	REACTION BAR
38	23792	1	RETAINING NUT, HEX
39	22141	1	SAFETY LABEL
40	26184	2	ADAPTER INSERT, GEN 3B 3000 SERIES
41	25106	1	PIN RETAINER RING
42	25107	2	RETAINING RING, PIN RETAINER

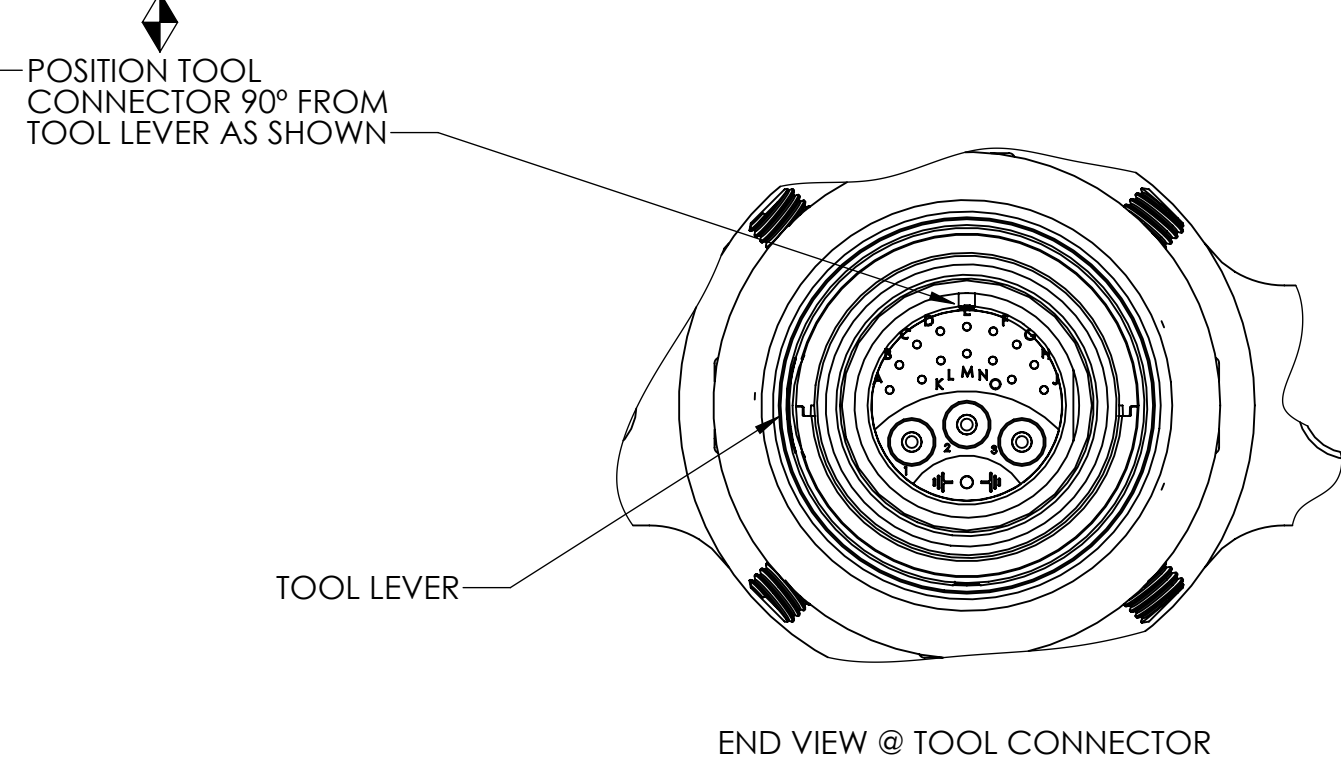
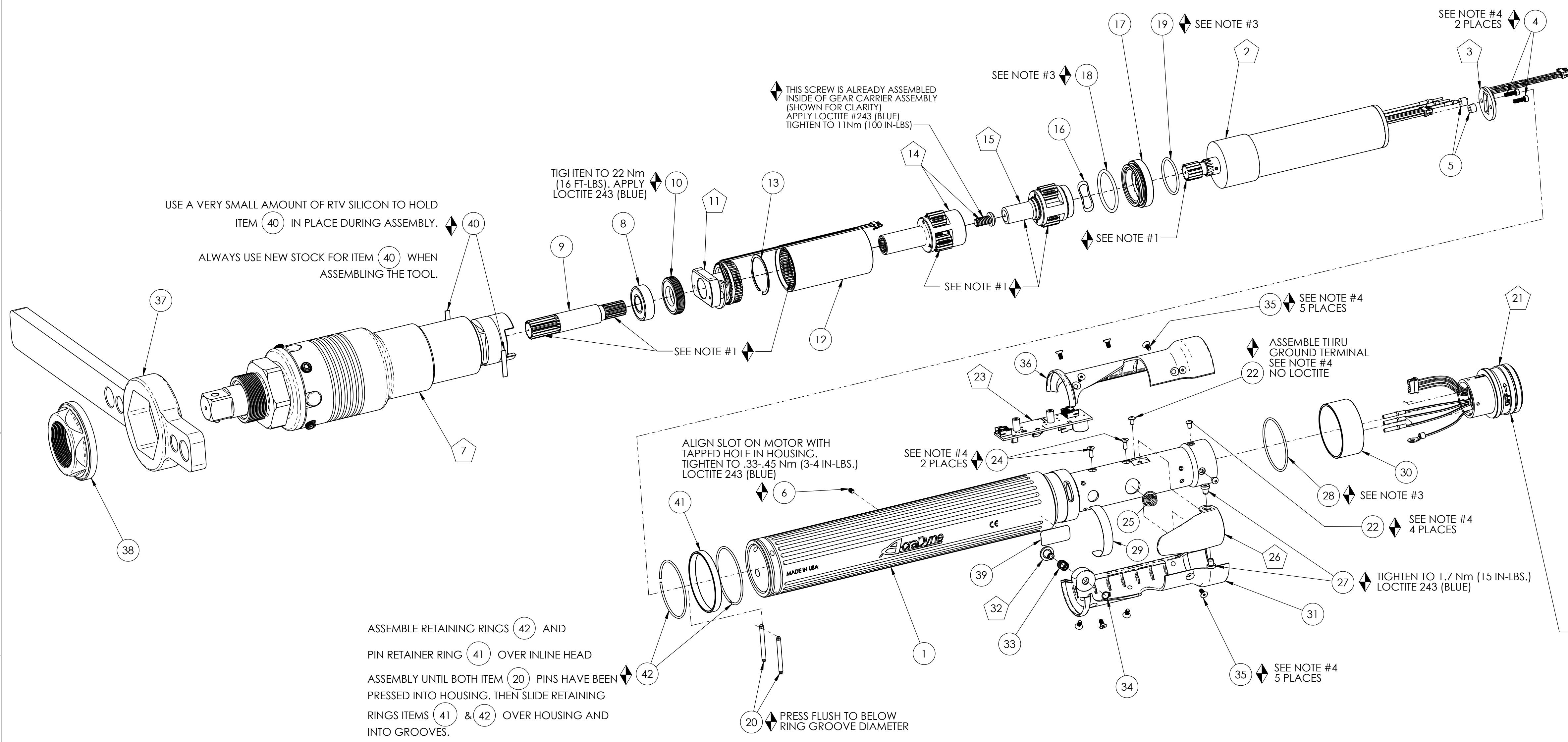

- ◆ ASSEMBLY INSTRUCTIONS
- ◻ SUB-ASSEMBLY

- 1) GEARS & SPLINES: LUBRICATE WITH DOW CORNING MOLYKOTE BR2 PLUS GREASE.
- 2) BEARINGS: LUBRICATE WITH CHEVRON SR1 GREASE
- 3) O-RINGS: LUBRICATE WITH O-RING LUBE
- 4) TIGHTEN TO 1NM (9 IN-LBS.) LOCTITE 243 (BLUE)

REQUIRED TOOLING
LOCTITE 243 (BLUE)
1/16 HEX WRENCH
5/64 HEX WRENCH
3/32 HEX WRENCH
SNAP RING PLIERS - EXTERNAL TYPE



DOCUMENT CONTROL
 PRINTED COPIES OF THIS DOCUMENT ARE CONSIDERED TO BE UNCONTROLLED DOCUMENTS. HOLDERS ARE RESPONSIBLE FOR VERIFYING THE CURRENT REVISION LEVEL WITH PURCHASING OR ENGINEERING PRIOR TO USE OR FABRICATION. THE CONTROLLED VERSION OF THIS DOCUMENT IS ELECTRONICALLY MAINTAINED.

PROPRIETARY AND CONFIDENTIAL
 THIS DRAWING CONTAINS INFORMATION STRICTLY CONFIDENTIAL TO ACRADYNE/AIMCO. IN THE ABSENCE OF EXPRESSED WRITTEN PERMISSION, ACRADYNE/AIMCO HAS LOANED THIS COPY WITH THE MUTUAL UNDERSTANDING THAT (A) IT WILL NOT BE USED FOR ANY PURPOSE OTHER THAN FOR THAT IN WHICH IT WAS PROVIDED, (B) THE DATA CONTAINED HEREIN WILL NOT BE DISCLOSED TO OTHERS, (C) IT WILL NOT BE REPRODUCED, AND (D) IT WILL BE RETURNED TO ACRADYNE/AIMCO IMMEDIATELY UPON DEMAND.

REVISION LEVEL	REVISION RELEASE DATE	DESCRIPTION OF CHANGES MADE TO PART	ECN #	AUTHOR/ APPROVAL
REVISION BLOCK				

UNLESS OTHERWISE SPECIFIED, DIMENSIONS ARE IN INCHES
 DIMENSIONS AND TOLERANCING PER ANSI Y14.5
 SURFACE ROUGHNESS PER ANSI Y14.36

BLOCK TOLERANCING PER DECIMAL:
 X = ±.030 XX = ±.010 XXX = ±.005 XXXX = ±.0005
 ANGLE = ±0° 30'

REMOVE BURRS AND SHARP EDGES: R.015 MAX
 MACHINE SURFACE FINISH: 125 RMS OR BETTER

DRAWINGS AND TECHNICAL DOCUMENTS CONTROLLED BY:
ACRADYNE MECHANICAL ENGINEERING

AES33_00C INLINE NUTRUNNER 3000 SERIES - GEN 3C		
SIZE	PART / DRAWING NUMBER	REVISION
D	AES33_00C	B
SCALE 1:2	DO NOT SCALE DRAWING	SHEET 1 OF 2

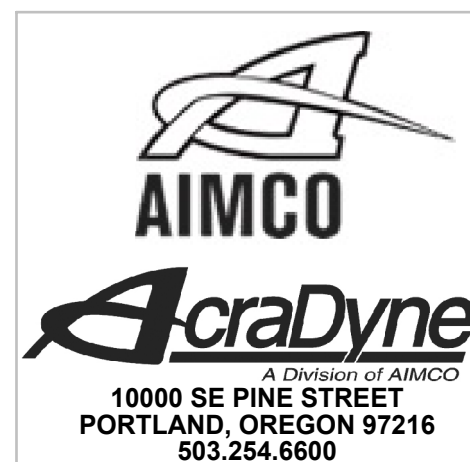
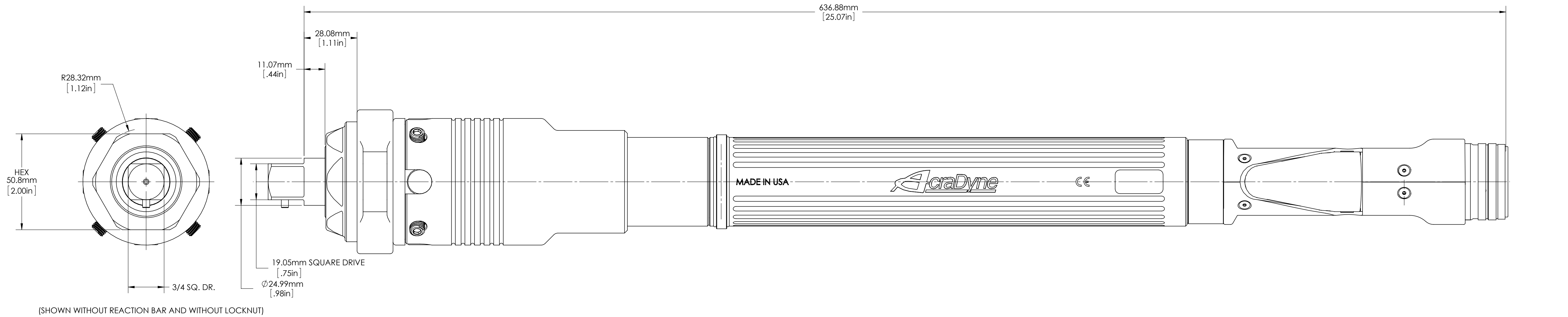
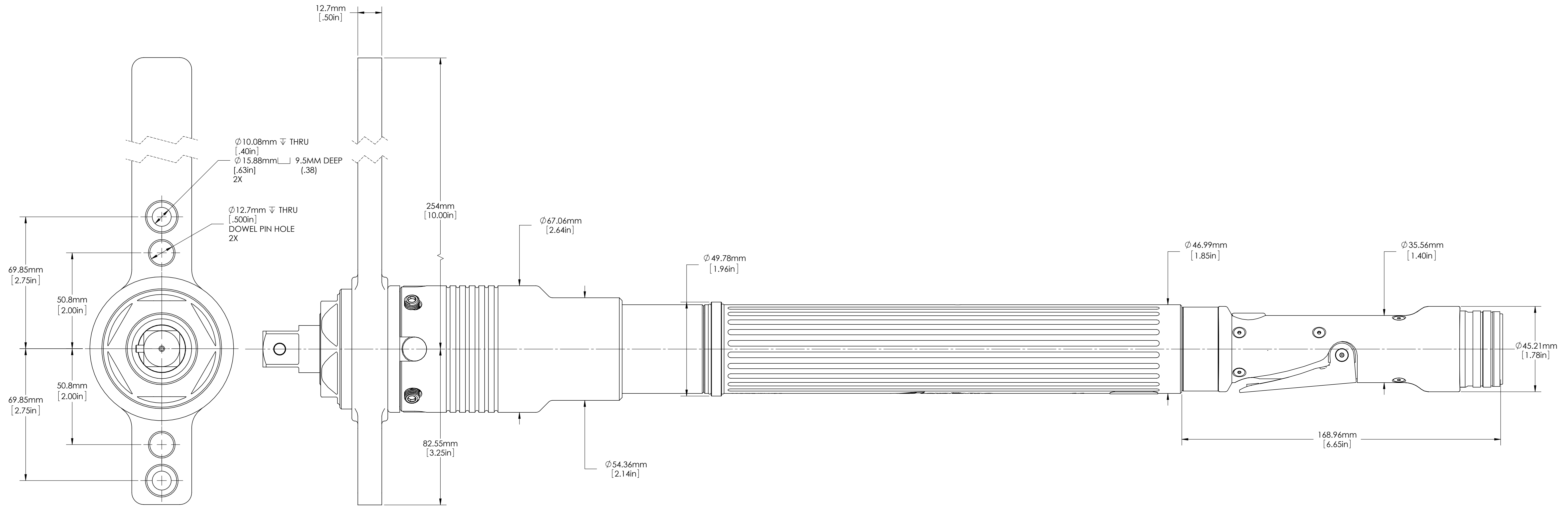

DOCUMENT CONTROL
 PRINTED COPIES OF THIS DOCUMENT ARE CONSIDERED TO BE UNCONTROLLED DOCUMENTS. HOLDERS ARE RESPONSIBLE FOR VERIFYING THE CURRENT REVISION LEVEL WITH PURCHASING OR ENGINEERING PRIOR TO USE OR FABRICATION. THE CONTROLLED VERSION OF THIS DOCUMENT IS ELECTRONICALLY MAINTAINED.

PROPRIETARY AND CONFIDENTIAL
 THIS DRAWING CONTAINS INFORMATION STRICTLY CONFIDENTIAL TO ACRADYNE/AIMCO. IN THE ABSENCE OF EXPRESSED WRITTEN PERMISSION, ACRADYNE/AIMCO HAS LOANED THIS COPY WITH THE MUTUAL UNDERSTANDING THAT (A) IT WILL NOT BE USED FOR ANY PURPOSE OTHER THAN FOR THAT IN WHICH IT WAS PROVIDED, (B) THE DATA CONTAINED HEREIN WILL NOT BE DISCLOSED TO OTHERS, (C) IT WILL NOT BE REPRODUCED, AND (D) IT WILL BE RETURNED TO ACRADYNE/AIMCO IMMEDIATELY UPON DEMAND.

REVISION LEVEL	REVISION RELEASE DATE	DESCRIPTION OF CHANGES MADE TO PART	ECN #	AUTHOR/ APPROVAL
REVISION BLOCK				

UNLESS OTHERWISE SPECIFIED, DIMENSIONS ARE IN INCHES
 DIMENSIONS AND TOLERANCING PER ANSI Y14.5
 SURFACE ROUGHNESS PER ANSI Y14.36

BLOCK TOLERANCING PER DECIMAL:
 X = ±.030 XX = ±.010 XXX = ±.005 XXXX = ±.0005
 ANGLE = ±0° 30'

REMOVE BURRS AND SHARP EDGES: R.015 MAX
 MACHINE SURFACE FINISH: 125 RMS OR BETTER

DRAWINGS AND TECHNICAL DOCUMENTS CONTROLLED BY:
ACRADYNE MECHANICAL ENGINEERING

AES33_00C INLINE NUTRUNNER
3000 SERIES - GEN 3C

SIZE	PART / DRAWING NUMBER	REVISION
D	AES33_00C	B

SCALE 1:1 DO NOT SCALE DRAWING SHEET 2 OF 2