

MODEL NO.	MOTOR ASM.	OUTPUT ASM.	GEAR TRAIN ASM.
AES33100C-2	25530	26405	25834
AES33150C-2	25525	27689	25835
AES33230C-2	25525	27689	25836

COMMENTS	ITEM NO.	PART NUMBER	Motor_exploded/QTY.	DESCRIPTION
	1	27031	1	MOTOR HOUSING ASSEMBLY
	2	SEE CHART	1	MOTOR ASSY, 9T, 3000 SERIES
	3	SEE CHART	1	SLIDING OUTPUT SPINDLE ASM
	4	25063	1	LED BOARD ASM.
	5	25075	2	SCREW, SHC 4-40X.375, STEEL, BLACK OXIDE
	6	25430	2	STAND-OFF, LED, 3000 SERIES
	7	27027	1	SCREW, SET 5-40X.188,STEEL,BLK OXIDE
	8	25106	1	PIN RETAINER RING
	9	25107	2	RETAINING RING, PIN RETAINER
	10	SEE CHART	1	GEAR TRAIN ASM.
	11	20912	1	WAVE SPRING --- 3000 SERIES
	12	20911	2	BELLEVILLE WASHER
	13	20924	1	GEAR CARRIER ASSY, THIRD STAGE, 4:1
	14	20913	2	PIN, RETAINING
	15	26793	2	RETAINING PIN, .125 OD X 1-1/4
	16	26102	1	TOOL CONNECTOR ASM., LEVER
	17	25102	1	SCREW, BHC 4-40X.188, STEEL, BLACK OXIDE
	18	25847	1	TID BOARD ASM.
	19	24934	2	SCREW, FHC 4-40 X .312, STEEL, BLACK OXIDE
	20	20132	1	THROTTLE SPRING
	21	26532	1	GEN 3 TRIGGER ASSY, CAST
	22	20061	2	SCREW, LEVER
	23	25072	1	O-RING, LED LIGHT RING COVER
	24	20534	1	3000 SERIAL/MODEL LABEL
	25	25058	1	LIGHT RING COVER, LED
	26	26084	1	HANDLE COVER, MFB
	27	24706	1	REV BUTTON SUB-ASSEMBLY
	28	24683	1	SPRING, REV BUTTON
	29	24679	1	RETAINING RNG
	30	24940	10	SCREW, FHSC 4-40 X .25 LG., STEEL, BLACK OXIDE
	31	26083	1	HANDLE COVER
	32	22141	1	SAFETY LABEL
	33	26184	2	ADAPTER INSERT, GEN 3B 3000 SERIES
	34	25745	4	SCREW, BHSC 4-40 STEEL, BLACK OXIDE

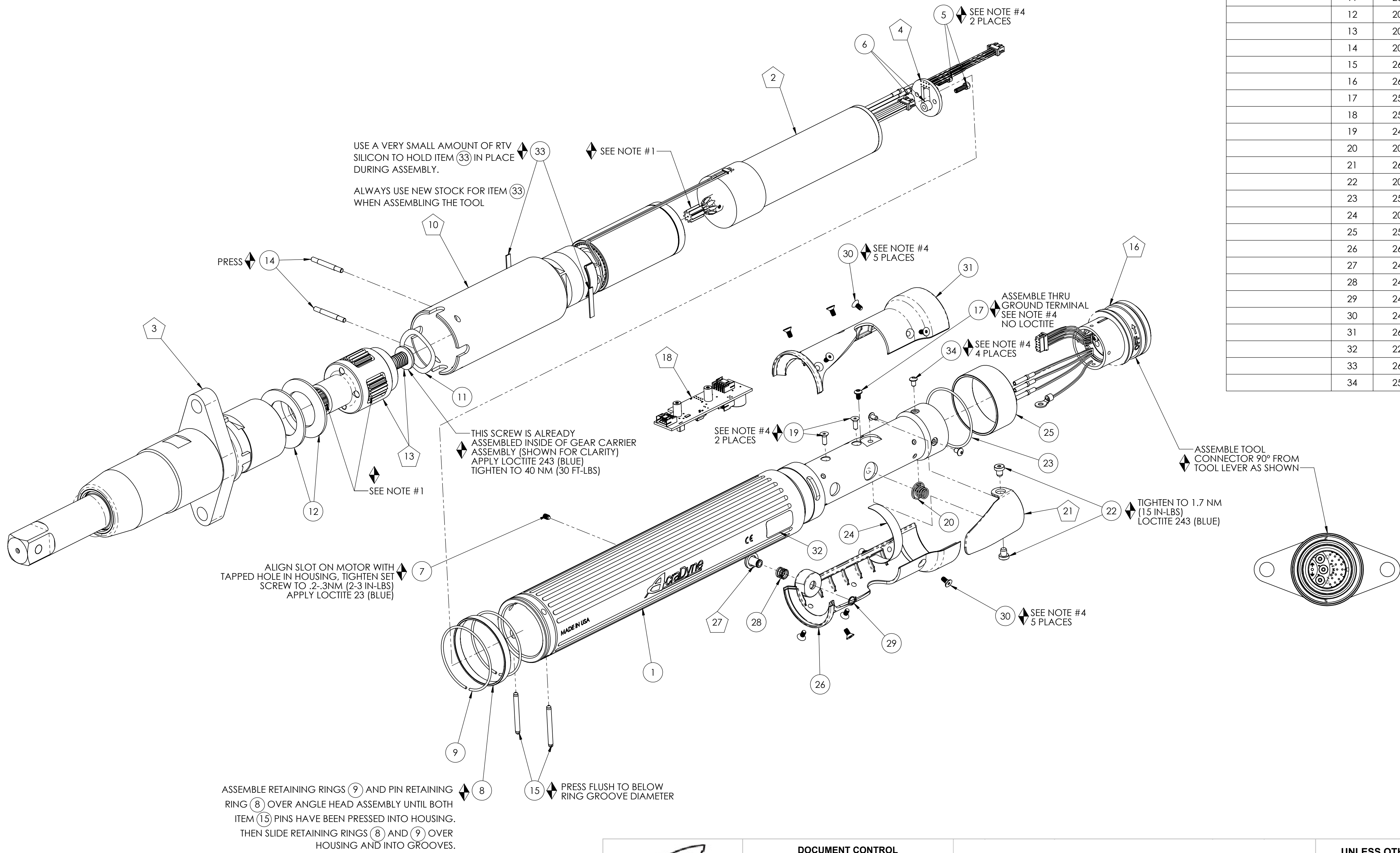

- ◆ ASSEMBLY INSTRUCTIONS
 - ◡ SUB-ASSEMBLY
- 1) GEARS & SPLINES: LUBRICATE WITH DOW CORNING MOLYKOTE BR2 PLUS GREASE.
 - 2) BEARINGS: LUBRICATE WITH CHEVRON SR1 GREASE
 - 3) O-RINGS: LUBRICATE WITH O-RING LUBE
 - 4) TIGHTEN TO 1.0 NM (9 IN-LBS.) USE LOCTITE 243 (BLUE)

REQUIRED TOOLING
LOCTITE 243 (BLUE)
1/16 HEX WRENCH
5/64 HEX WRENCH
3/32 HEX WRENCH
SNAP RING PLIERS - EXTERNAL TYPE



DOCUMENT CONTROL
 PRINTED COPIES OF THIS DOCUMENT ARE CONSIDERED TO BE UNCONTROLLED DOCUMENTS. HOLDERS ARE RESPONSIBLE FOR VERIFYING THE CURRENT REVISION LEVEL WITH PURCHASING OR ENGINEERING PRIOR TO USE OR FABRICATION. THE CONTROLLED VERSION OF THIS DOCUMENT IS ELECTRONICALLY MAINTAINED.

PROPRIETARY AND CONFIDENTIAL
 THIS DRAWING CONTAINS INFORMATION STRICTLY CONFIDENTIAL TO ACRADYNE/AIMCO. IN THE ABSENCE OF EXPRESSED WRITTEN PERMISSION, ACRADYNE/AIMCO HAS LOANED THIS COPY WITH THE MUTUAL UNDERSTANDING THAT (A) IT WILL NOT BE USED FOR ANY PURPOSE OTHER THAN FOR THAT IN WHICH IT WAS PROVIDED, (B) THE DATA CONTAINED HEREIN WILL NOT BE DISCLOSED TO OTHERS, (C) IT WILL NOT BE REPRODUCED, AND (D) IT WILL BE RETURNED TO ACRADYNE/AIMCO IMMEDIATELY UPON DEMAND.

REVISION LEVEL	REVISION RELEASE DATE	DESCRIPTION OF CHANGES MADE TO PART	ECN #	AUTHOR/ APPROVAL
REVISION BLOCK				

UNLESS OTHERWISE SPECIFIED, DIMENSIONS ARE IN INCHES
 DIMENSIONS AND TOLERANCING PER ANSI Y14.5
 SURFACE ROUGHNESS PER ANSI Y14.36

BLOCK TOLERANCING PER DECIMAL:
 X = ±.030 XX = ±.010 XXX = ±.005 XXXX = ±.0005
 ANGLE = ±0°30'

REMOVE BURRS AND SHARP EDGES: R.015 MAX
 MACHINE SURFACE FINISH: 125 RMS OR BETTER

DRAWINGS AND TECHNICAL DOCUMENTS CONTROLLED BY:
ACRADYNE MECHANICAL ENGINEERING

INLINE TOOL, SLIDING SPINDLE 3000 SERIES, GEN 3C		
SIZE	PART / DRAWING NUMBER	REVISION
D	AES33__C-2	A
SCALE 2:3	DO NOT SCALE DRAWING	SHEET 1 OF 2

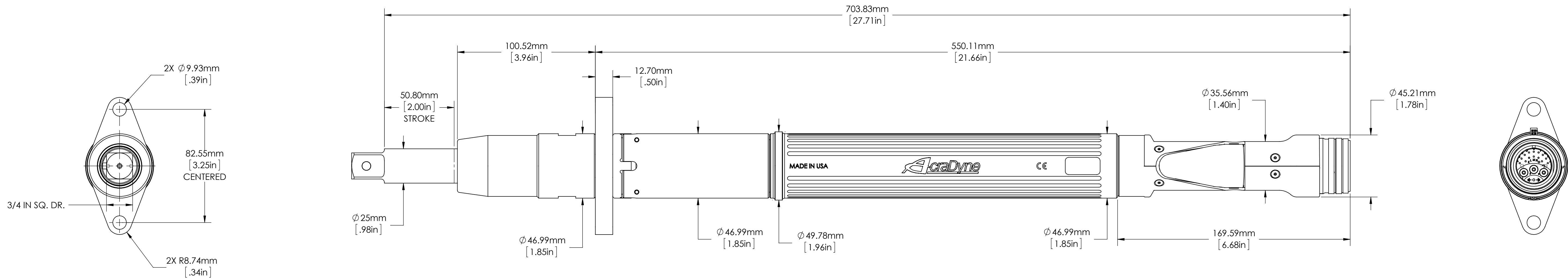

DOCUMENT CONTROL
 PRINTED COPIES OF THIS DOCUMENT ARE CONSIDERED TO BE UNCONTROLLED DOCUMENTS. HOLDERS ARE RESPONSIBLE FOR VERIFYING THE CURRENT REVISION LEVEL WITH PURCHASING OR ENGINEERING PRIOR TO USE OR FABRICATION. THE CONTROLLED VERSION OF THIS DOCUMENT IS ELECTRONICALLY MAINTAINED.

PROPRIETARY AND CONFIDENTIAL
 THIS DRAWING CONTAINS INFORMATION STRICTLY CONFIDENTIAL TO ACRADYNE/AIMCO. IN THE ABSENCE OF EXPRESSED WRITTEN PERMISSION, ACRADYNE/AIMCO HAS LOANED THIS COPY WITH THE MUTUAL UNDERSTANDING THAT (A) IT WILL NOT BE USED FOR ANY PURPOSE OTHER THAN FOR THAT IN WHICH IT WAS PROVIDED, (B) THE DATA CONTAINED HEREIN WILL NOT BE DISCLOSED TO OTHERS, (C) IT WILL NOT BE REPRODUCED, AND (D) IT WILL BE RETURNED TO ACRADYNE/AIMCO IMMEDIATELY UPON DEMAND.

REVISION LEVEL	REVISION RELEASE DATE	DESCRIPTION OF CHANGES MADE TO PART	ECN #	AUTHOR/ APPROVAL
REVISION BLOCK				

UNLESS OTHERWISE SPECIFIED, DIMENSIONS ARE IN INCHES
 DIMENSIONS AND TOLERANCING PER ANSI Y14.5
 SURFACE ROUGHNESS PER ANSI Y14.36

BLOCK TOLERANCING PER DECIMAL:
 .X = ±.030 .XX = ±.010 .XXX = ±.005 .XXXX = ±.0005
 ANGLE = ±0° 30'

REMOVE BURRS AND SHARP EDGES: R.015 MAX
 MACHINE SURFACE FINISH: 125 RMS OR BETTER

DRAWINGS AND TECHNICAL DOCUMENTS CONTROLLED BY:
 ACRADYNE MECHANICAL ENGINEERING

INLINE TOOL, SLIDING SPINDLE 3000 SERIES, GEN 3C		
SIZE	PART / DRAWING NUMBER	REVISION
D	AES33_ _ C-2	A
SCALE: 2:3	DO NOT SCALE DRAWING	SHEET 2 OF 2