

MODEL NO.	GEARBOX ASM.
AES35280A	26202
AES35350A	26203
AES35420A	26201
AES35515A	26200
AES35635A	26129

COMMENTS	ITEM NO.	PART NUMBER	QTY.	DESCRIPTION
	1	26058	1	MOTOR ASM., 5000 SERIES
	2	26198	1	THRUST WASHER
	3	26074	1	BELLEVILLE WASHER
	4	SEE CHART	1	GEARBOX ASM. - TRIPLE STEP
	5	26530	2	DOWEL PIN, $\varnothing 1/8 \times 1.00$, STEEL
	6	27391	1	PIN RETAINER RING
	7	26095	1	LED BOARD ASM.
	8	26078	2	SHC SCREW, 4-40, BLACK OXIDE
	9	26080	1	O-RING, LED LIGHT RING COVER
	10	26079	1	LIGHT RING COVER, LED
	11	26082	1	LEVER HANDLE
	12	25574	2	STANDOFF M-F, 4-40x1/4.3/16 HEX, SS
	13	26088	6	SCREW, BHC 8-32X.25, STEEL, BLACK OXIDE
	14	26102	1	TOOL CONNECTOR ASM., LEVER
	15	25745	5	SCREW, BHSC 4-40 STEEL, BLACK OXIDE
	16	25847	1	TID BOARD ASM.
	17	24934	2	SCREW, FHC 4-40 X .312, STEEL, BLACK OXIDE
	18	20132	1	THROTTLE SPRING
	19	26532	1	GEN 3 TRIGGER ASSY, CAST
	20	20061	2	SCREW, LEVER
	21	26084	1	HANDLE COVER, MFB
	22	24706	1	REV BUTTON SUB-ASSEMBLY
	23	24683	1	SPRING, REV BUTTON
	24	24679	1	RETAINING RNG
	25	24940	10	SCREW, FHSC 4-40 X .25 LG., STEEL, BLACK OXIDE
	26	26083	1	HANDLE COVER
	27	20534	1	3000 SERIAL/MODEL LABEL
	28	26081	2	MOTOR HOUSING COVER
	29	25385	8	SCREW, FHSC 6-32 X .375, STEEL
	30	22141	1	SAFETY LABEL
	31	23793	1	REACTION BAR
	32	23792	1	RETAINING NUT, HEX

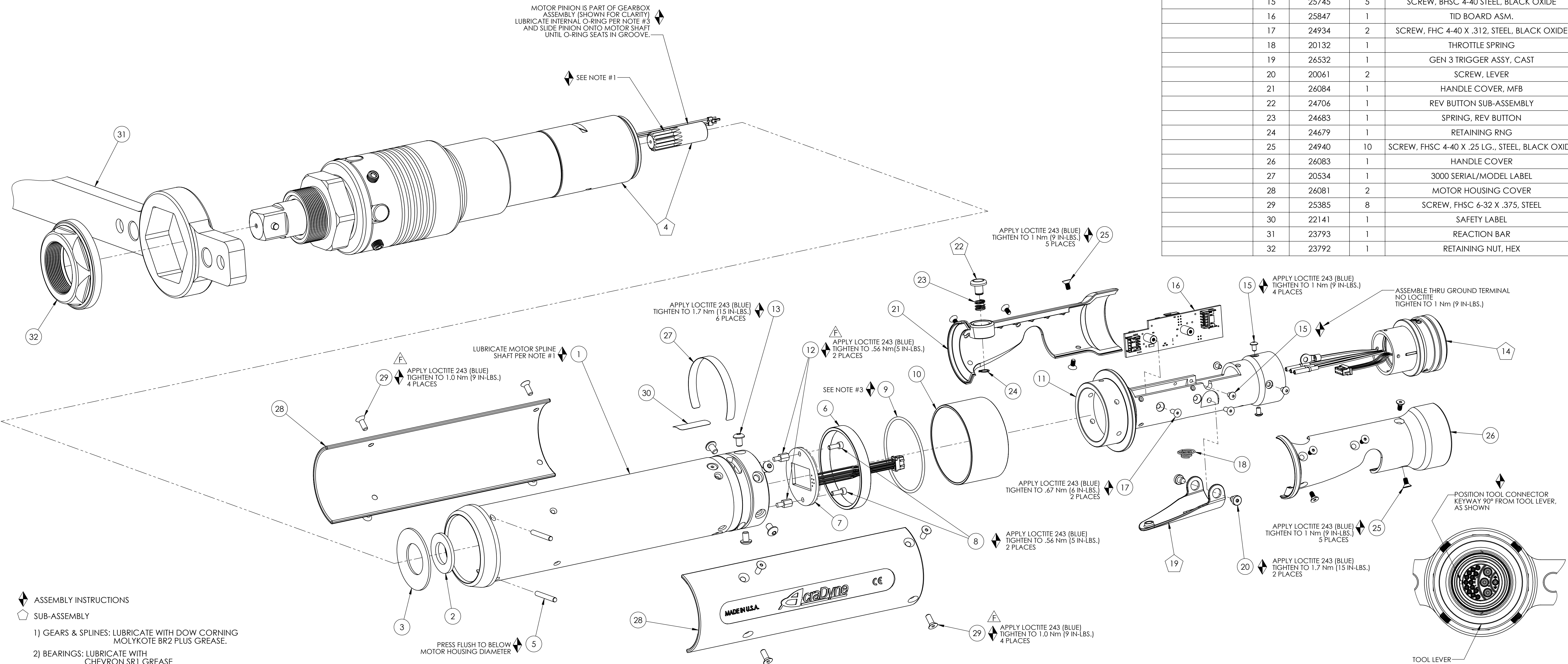

- ◆ ASSEMBLY INSTRUCTIONS
- ◊ SUB-ASSEMBLY
- 1) GEARS & SPLINES: LUBRICATE WITH DOW CORNING MOLYKOTE BR2 PLUS GREASE.
- 2) BEARINGS: LUBRICATE WITH CHEVRON SR1 GREASE
- 3) O-RINGS: LUBRICATE WITH O-RING LUBE

REQUIRED TOOLING
LOCTITE 243 (BLUE)
1/16 HEX WRENCH
5/64 HEX WRENCH
3/32 HEX WRENCH
SNAP RING PLIERS - EXTERNAL TYPE



DOCUMENT CONTROL
 PRINTED COPIES OF THIS DOCUMENT ARE CONSIDERED TO BE UNCONTROLLED DOCUMENTS. HOLDERS ARE RESPONSIBLE FOR VERIFYING THE CURRENT REVISION LEVEL WITH PURCHASING OR ENGINEERING PRIOR TO USE OR FABRICATION. THE CONTROLLED VERSION OF THIS DOCUMENT IS ELECTRONICALLY MAINTAINED.

PROPRIETARY AND CONFIDENTIAL
 THIS DRAWING CONTAINS INFORMATION STRICTLY CONFIDENTIAL TO ACRADYNE/AIMCO. IN THE ABSENCE OF EXPRESSED WRITTEN PERMISSION, ACRADYNE/AIMCO HAS LOANED THIS COPY WITH THE MUTUAL UNDERSTANDING THAT (A) IT WILL NOT BE USED FOR ANY PURPOSE OTHER THAN FOR THAT IN WHICH IT WAS PROVIDED, (B) THE DATA CONTAINED HEREIN WILL NOT BE DISCLOSED TO OTHERS, (C) IT WILL NOT BE REPRODUCED, AND (D) IT WILL BE RETURNED TO ACRADYNE/AIMCO IMMEDIATELY UPON DEMAND.

REVISION LEVEL	REVISION RELEASE DATE	DESCRIPTION OF CHANGES MADE TO PART	ECN #	AUTHOR/ APPROVAL
REVISION BLOCK				

UNLESS OTHERWISE SPECIFIED, DIMENSIONS ARE IN INCHES
 DIMENSIONS AND TOLERANCING PER ANSI Y14.5
 SURFACE ROUGHNESS PER ANSI Y14.36

BLOCK TOLERANCING PER DECIMAL:
 X = ±.030 XX = ±.010 XXX = ±.005 XXXX = ±.0005
 ANGLE = ±.0°

REMOVE BURRS AND SHARP EDGES: R.015 MAX
 MACHINE SURFACE FINISH: 125 RMS OR BETTER

DRAWINGS AND TECHNICAL DOCUMENTS CONTROLLED BY:
ACRADYNE MECHANICAL ENGINEERING

AES35__A INLINE NUTRUNNER 5000 SERIES, GEN III		
SIZE D	PART / DRAWING NUMBER AES35__A	REVISION F
SCALE 3:4	DO NOT SCALE DRAWING	SHEET 2 OF 4

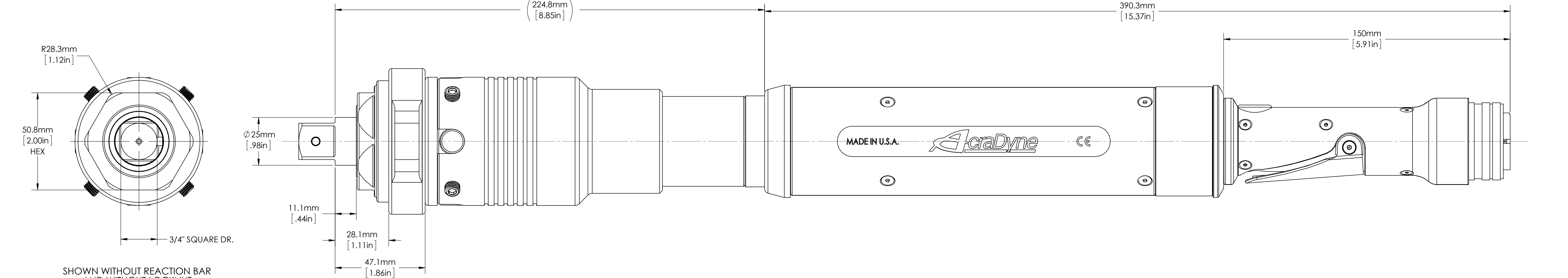
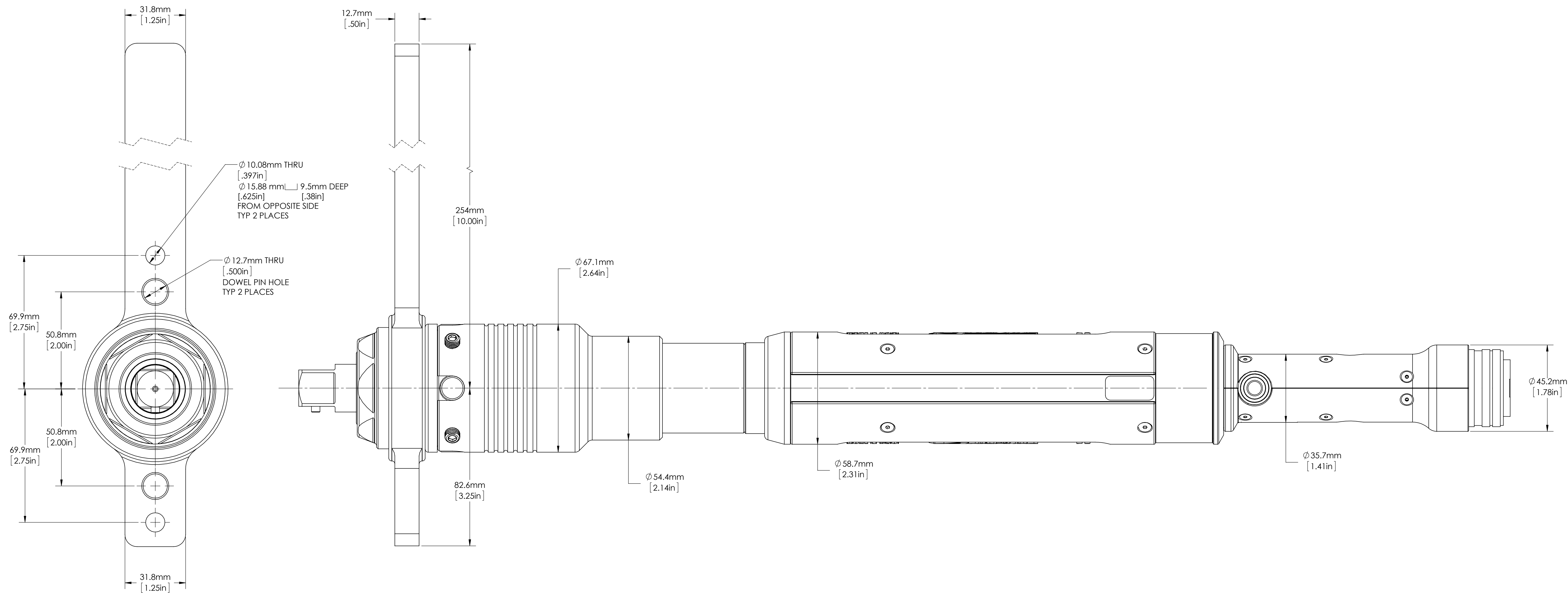

CATALOG MODELS	MODEL NO.
	AES35280A
	AES35350A
	AES35420A
	AES35515A
	AES35635A



DOCUMENT CONTROL
 PRINTED COPIES OF THIS DOCUMENT ARE CONSIDERED TO BE UNCONTROLLED DOCUMENTS. HOLDERS ARE RESPONSIBLE FOR VERIFYING THE CURRENT REVISION LEVEL WITH PURCHASING OR ENGINEERING PRIOR TO USE OR FABRICATION. THE CONTROLLED VERSION OF THIS DOCUMENT IS ELECTRONICALLY MAINTAINED.

PROPRIETARY AND CONFIDENTIAL
 THIS DRAWING CONTAINS INFORMATION STRICTLY CONFIDENTIAL TO ACRADYNE/AIMCO. IN THE ABSENCE OF EXPRESSED WRITTEN PERMISSION, ACRADYNE/AIMCO HAS LOANED THIS COPY WITH THE MUTUAL UNDERSTANDING THAT (A) IT WILL NOT BE USED FOR ANY PURPOSE OTHER THAN FOR THAT IN WHICH IT WAS PROVIDED, (B) THE DATA CONTAINED HEREIN WILL NOT BE DISCLOSED TO OTHERS, (C) IT WILL NOT BE REPRODUCED, AND (D) IT WILL BE RETURNED TO ACRADYNE/AIMCO IMMEDIATELY UPON DEMAND.

REVISION LEVEL	REVISION RELEASE DATE	DESCRIPTION OF CHANGES MADE TO PART	ECN #	AUTHOR/ APPROVAL
REVISION BLOCK				

UNLESS OTHERWISE SPECIFIED, DIMENSIONS ARE IN INCHES
 DIMENSIONS AND TOLERANCING PER ANSI Y14.5
 SURFACE ROUGHNESS PER ANSI Y14.36

BLOCK TOLERANCING PER DECIMAL:
 .X = ±.030 .XX = ±.010 .XXX = ±.005 .XXXX = ±.0005
 ANGLE = ±0° 30'

REMOVE BURRS AND SHARP EDGES: R.015 MAX
 MACHINE SURFACE FINISH: 125 RMS OR BETTER

DRAWINGS AND TECHNICAL DOCUMENTS CONTROLLED BY:
ACRADYNE MECHANICAL ENGINEERING

AES35...A TOOL OUTLINE 5000 SERIES, GEN III		
SIZE	PART / DRAWING NUMBER	REVISION
D	AES35...A	C
SCALE: 1:1	DO NOT SCALE DRAWING	SHEET 4 OF 4