

TOOL MODEL	GEAR CASE SUB-ASM.	TRANSDUCER SUB-ASM.
AES4A22020CR	24709	31048.005
AES4A22030CR	24710	31045.004
AES4A22040CR	24781	31045.006

COMMENTS	ITEM NO.	PART NUMBER	QTY.	DESCRIPTION
	1	28766	1	MOTOR ASSEMBLY
	2	SEE CHART	1	GEAR CASE SUB-ASM.
	3	27023	1	SPRING, RIV-NUT SHAFT
	3	27026	1	ADAPTOR ASM., RIV-NUT
	5	28754	1	LEVER HANDLE
	6	29186	1	COVER, LEVER HANDLE
	7	25763	1	TRANSDUCER ADAPTOR
	8	24780	1	MOTOR COUPLER SUB-ASM.
	9	SEE CHART	1	TRANSDUCER SUB-ASM.
	10	29202	1	TRIGGER CABLE ASM., 6 PIN - 6 PIN
	11	29191	1	TRIGGER/MFG BOARD ASM., 2000-SERIES, GEN 4
	12	28767	1	TOOL CONN. ASM.
	13	30966	1	LED BOARD ASM, i2C
	14	24679	1	RETAINING RNG
	15	24683	1	SPRING, REV BUTTON
	16	25557	1	REV BUTTON SUB-ASSEMBLY
	17	29189	1	TRIGGER SUB-ASM.
	18	28760	1	LED COVER
	19	28753	2	MOTOR COVER, SMALL MOTOR O.D.
	20	20534	1	2000 SERIAL/MODEL LABEL
	21	22141	1	SAFETY LABEL
	22	20132	1	THROTTLE SPRING
	23	31051	1	DOWEL PIN, Ø.094 X .75, GROOVED, STEEL, ZINC PLATED
	24	31061	2	DOWEL PIN, Ø3/32 X 1/4, STEEL
	25	23753	8	SCREW, FHSC 6-32x5/16, 18-8 SS
	26	25745	5	SCREW, BHSC 4-40 STEEL, BLACK OXIDE
	27	26078	4	SCREW, SHC 4-40 X 5/16, BLK OXIDE
	28	27235	2	O-RING, BUNA-N, #28
	29	24935	2	SCREW, SHC 4-40 X .25, STEEL, BLACK OXIDE
	30	23741	1	SHIM, OUTPUT, .002 IN, 40 NM
	31	21022	1	SHIM, BLANK OUTPUT SHAFT, 0.005 THK
	32	21021	1	SHIM, BLANK OUTPUT SHAFT, 0.010 THK
	NOT SHOWN	28257	A/R	CABLE TIE, 1.65mm X 71mm
	NOT SHOWN	25471	1	LABEL, SN# COVER, .25 X 4"
	CHOOSE THREAD SIZE	35	SEE SHEET #3	NOSE PIECE ASM., RIV-NUT

- ◆ ASSEMBLY INSTRUCTIONS
- ◡ SUB-ASSEMBLY

- 1) GEARS & SPLINES: LUBRICATE WITH DOW CORNING MOLYKOTE BR2 PLUS GREASE.
- 2) BEARINGS: LUBRICATE WITH CHEVRON SR1 GREASE
- 3) O-RINGS: LUBRICATE WITH O-RING LUBE
- 4) TIGHTEN TO 1.0 Nm (9 IN-LBS.) LOCTITE 222 (PURPLE)



DOCUMENT CONTROL
 PRINTED COPIES OF THIS DOCUMENT ARE CONSIDERED TO BE UNCONTROLLED DOCUMENTS. HOLDERS ARE RESPONSIBLE FOR VERIFYING THE CURRENT REVISION LEVEL WITH PURCHASING OR ENGINEERING PRIOR TO USE OR FABRICATION. THE CONTROLLED VERSION OF THIS DOCUMENT IS ELECTRONICALLY MAINTAINED.

PROPRIETARY AND CONFIDENTIAL
 THIS DRAWING CONTAINS INFORMATION STRICTLY CONFIDENTIAL TO ACRADYNE/AMCO. IN THE ABSENCE OF EXPRESSED WRITTEN PERMISSION, ACRADYNE/AMCO HAS LOANED THIS COPY WITH THE MUTUAL UNDERSTANDING THAT (A) IT WILL NOT BE USED FOR ANY PURPOSE OTHER THAN FOR THAT IN WHICH IT WAS PROVIDED, (B) THE DATA CONTAINED HEREIN WILL NOT BE DISCLOSED TO OTHERS, (C) IT WILL NOT BE REPRODUCED, AND (D) IT WILL BE RETURNED TO ACRADYNE/AMCO IMMEDIATELY UPON DEMAND.

REVISION LEVEL	REVISION RELEASE DATE	DESCRIPTION OF CHANGES MADE TO PART	ECN #	AUTHOR/ APPROVAL

UNLESS OTHERWISE SPECIFIED, DIMENSIONS ARE IN INCHES
 DIMENSIONS AND TOLERANCING PER ANSI Y14.5 SURFACE ROUGHNESS PER ANSI Y14.36

BLOCK TOLERANCING PER DECIMAL:
 X = ±.030 XX = ±.010 XXX = ±.005 .XXXX = ±.0005
 ANGLE = ±.30°

REMOVE BURRS AND SHARP EDGES: R.015 MAX MACHINE SURFACE FINISH: 125 RMS OR BETTER

DRAWINGS AND TECHNICAL DOCUMENTS CONTROLLED BY:
ACRADYNE MECHANICAL ENGINEERING

**INLINE NUTRUNNER
RIV-NUT
GEN 4 2000 SERIES**

SIZE D	PART / DRAWING NUMBER AES4A220 CR	REVISION A
SCALE 1:1	DO NOT SCALE DRAWING	SHEET 1 OF 3

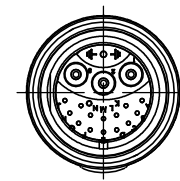
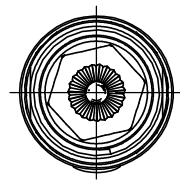
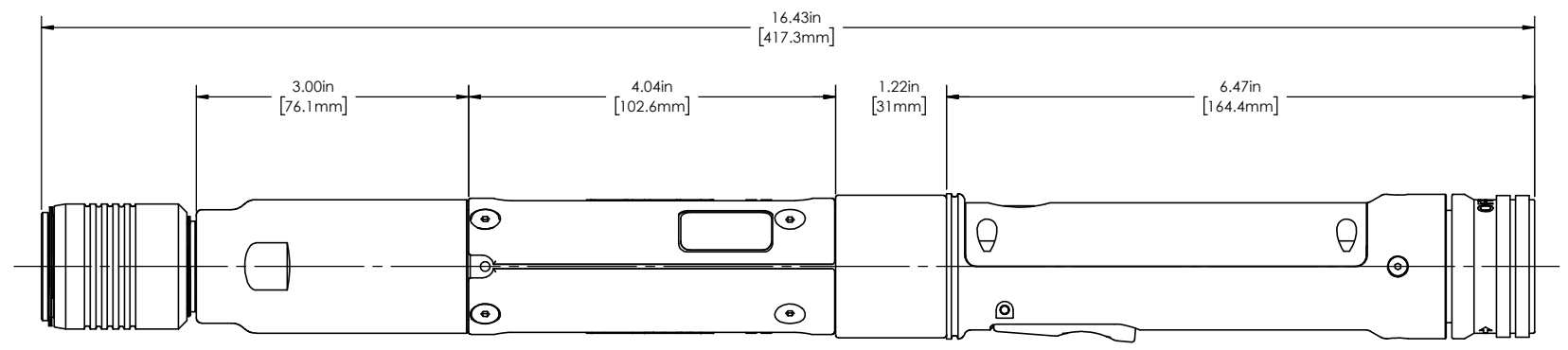
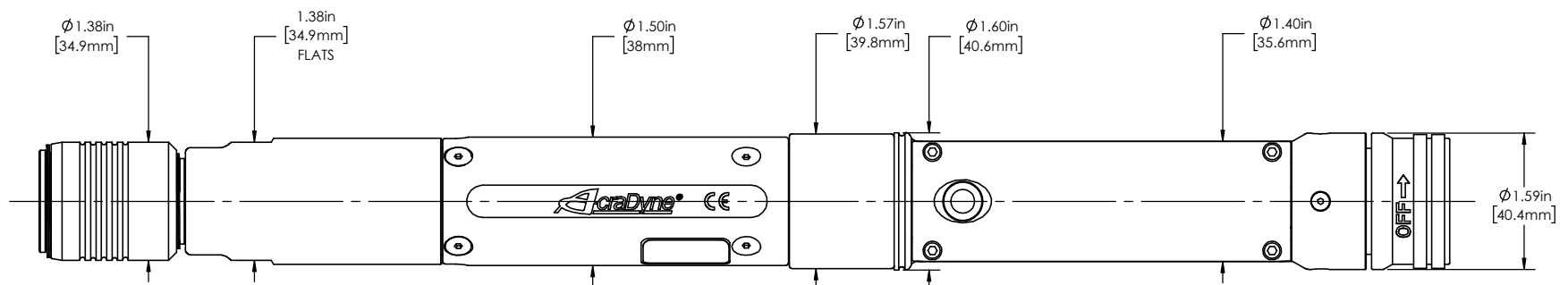

DOCUMENT CONTROL
 PRINTED COPIES OF THIS DOCUMENT ARE CONSIDERED TO BE UNCONTROLLED DOCUMENTS. HOLDERS ARE RESPONSIBLE FOR VERIFYING THE CURRENT REVISION LEVEL WITH PURCHASING OR ENGINEERING PRIOR TO USE OR FABRICATION. THE CONTROLLED VERSION OF THIS DOCUMENT IS ELECTRONICALLY MAINTAINED.

PROPRIETARY AND CONFIDENTIAL
 THIS DRAWING CONTAINS INFORMATION STRICTLY CONFIDENTIAL TO ACRADYNE/AIMCO. IN THE ABSENCE OF EXPRESSED WRITTEN PERMISSION, ACRADYNE/AIMCO HAS LOANED THIS COPY WITH THE MUTUAL UNDERSTANDING THAT (A) IT WILL NOT BE USED FOR ANY PURPOSE OTHER THAN FOR THAT IN WHICH IT WAS PROVIDED, (B) THE DATA CONTAINED HEREIN WILL NOT BE DISCLOSED TO OTHERS, (C) IT WILL NOT BE REPRODUCED, AND (D) IT WILL BE RETURNED TO ACRADYNE/AIMCO IMMEDIATELY UPON DEMAND.

REVISION LEVEL	REVISION RELEASE DATE	DESCRIPTION OF CHANGES MADE TO PART	ECN #	AUTHOR/ APPROVAL
		PRODUCTION RELEASE		

UNLESS OTHERWISE SPECIFIED, DIMENSIONS ARE IN INCHES
 DIMENSIONS AND TOLERANCING PER ANSI Y14.5
 SURFACE ROUGHNESS PER ANSI Y14.36

BLOCK TOLERANCING PER DECIMAL:
 .X = ±.030 .XX = ±.010 .XXX = ±.005 .XXXX = ±.0005
 ANGLE = ±0° 30'

REMOVE BURRS AND SHARP EDGES: R.015 MAX
 MACHINE SURFACE FINISH: 125 RMS OR BETTER

ACRADYNE MECHANICAL ENGINEERING

INLINE NUTRUNNER RIV-NUT GEN 4 2000 SERIES

SIZE	PART / DRAWING NUMBER	REVISION
D	AES4A220 CR	A

SCALE 1:1 DO NOT SCALE DRAWING SHEET 2 OF 3

D

C

B

A

D

C

B

A

SIZE CODE CHART			
METRIC		INCH	
THREAD SIZE	NOSE PIECE ASM.	THREAD SIZE	NOSE PIECE ASM.
M4 x 0.7mm	27051	8-32 UNC	27055
M5 x 0.8mm	27034	10-24 UNC	27056
M6 x 1.0mm	27052	10-32 UNF	27057
M8 x 1.25mm	27053	1/4-20 UNC	27058
M10 x 1.5mm	27054	5/16-18 UNC	27059
		3/8-16 UNC	27060

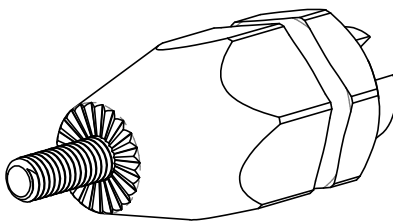

10000 SE PINE STREET
 PORTLAND, OREGON 97216
 503.254.6600

DOCUMENT CONTROL

PRINTED COPIES OF THIS DOCUMENT ARE CONSIDERED TO BE UNCONTROLLED DOCUMENTS. HOLDERS ARE RESPONSIBLE FOR VERIFYING THE CURRENT REVISION LEVEL WITH PURCHASING OR ENGINEERING PRIOR TO USE OR FABRICATION. THE CONTROLLED VERSION OF THIS DOCUMENT IS ELECTRONICALLY MAINTAINED.

PROPRIETARY AND CONFIDENTIAL

THIS DRAWING CONTAINS INFORMATION STRICTLY CONFIDENTIAL TO ACRADYNE/AIMCO. IN THE ABSENCE OF EXPRESSED WRITTEN PERMISSION, ACRADYNE/AIMCO HAS LOANED THIS COPY WITH THE MUTUAL UNDERSTANDING THAT (A) IT WILL NOT BE USED FOR ANY PURPOSE OTHER THAN FOR THAT IN WHICH IT WAS PROVIDED, (B) THE DATA CONTAINED HEREIN WILL NOT BE DISCLOSED TO OTHERS, (C) IT WILL NOT BE REPRODUCED, AND (D) IT WILL BE RETURNED TO ACRADYNE/AIMCO IMMEDIATELY UPON DEMAND.

REVISION LEVEL	REVISION RELEASE DATE	DESCRIPTION OF CHANGES MADE TO PART	ECN #	AUTHOR/ APPROVAL

REVISION BLOCK

UNLESS OTHERWISE SPECIFIED, DIMENSIONS ARE IN INCHES
 DIMENSIONS AND TOLERANCING PER ANSI Y14.5
 SURFACE ROUGHNESS PER ANSI Y14.36

BLOCK TOLERANCING PER DECIMAL:
 .X = ±.030 .XX = ±.010 .XXX = ±.005 .XXXX = ±.0005
 ANGLE = ±0° 30'

REMOVE BURRS AND SHARP EDGES: R.015 MAX
 MACHINE SURFACE FINISH: 125 RMS OR BETTER

DRAWINGS AND TECHNICAL DOCUMENTS CONTROLLED BY:
ACRADYNE MECHANICAL ENGINEERING

INLINE NUTRUNNER RIV-NUT
GEN 4 2000-SERIES

SIZE	PART / DRAWING NUMBER	REVISION
B	AES4A220__CR	A
SCALE 1:1	DO NOT SCALE DRAWING	SHEET 3 OF 3