

MODEL NUMBER	TUBENUT HEAD ASM
AET32020CDL	235-023-0
AET32025CDL	235-023-4
AET32035CDL	236-023-0
AET32050CDL	236-023-6

ITEM NO.	PART NUMBER	QTY.	DESCRIPTION
1	27624	1	HOUSING MOTOR/HANDLE, DUAL LEVER, 2000-SERIES, GEN 3C
2	25425	1	MOTOR ASM.
3	25063	1	LED BOARD ASM.
4	25075	2	SCREW, SHC 4-40X.375, STEEL, BLACK OXIDE
5	25429	2	STAND-OFF, LED, 2000 SERIES
6	25993	1	O-RING, RING GEAR TO MOTOR, GEN 3B 2000 SERIES
7	25859	1	TUBENUT ADAPTOR ASSEMBLY
8	24272	2	ADAPTOR INSERT
9	24324	2	DOWEL PIN 3/32 Dia x 7/8 LONG
10	25441	1	HALL SWITCH ASM., DUAL LEVER TOOL
11	25743	2	SCREW, BHSC 2-56X.188, STEEL, BLACK OXIDE
12	25102	1	SCREW, BHC 4-40X.188, STEEL, BLACK OXIDE
13	25847	1	TID BOARD ASM.
14	24934	2	SCREW, FHC 4-40 X .312, STEEL, BLACK OXIDE
15	20132	1	THROTTLE SPRING
16	20061	2	SCREW, LEVER
17	25103	1	PIN RETAINER RING
18	25104	1	RETAINING RING
19	25072	1	O-RING, LED LIGHT RING COVER
20	20534	1	3000 SERIAL/MODEL LABEL
21	25058	1	LIGHT RING COVER, LED
22	24679	1	RETAINING RING
23	24683	1	SPRING, REV BUTTON
24	24706	1	REV BUTTON SUB-ASSEMBLY
25	SEE CHART	1	TUBENUT HEAD ASM.
26	22141	1	SAFETY LABEL
27	26733	1	SPRING, DUAL LEVER, TAPERED
28	26731	1	DUAL TRIGGER ASSY, 2000 SERIES
29	25440	2	SCREW, LEVER, DUAL LEVER TOOL
30	233-073-0	1	LOCK NUT
31	26102	1	TOOL CONNECTOR ASM., LEVER
32	25745	4	SCREW, BHSC 4-40 STEEL, BLACK OXIDE
33	26532	1	GEN 3 TRIGGER ASSY, CAST
34	25073	1	SCREW, SET 4-40X.375, STEEL, BLACK OXIDE
35	26084	1	HANDLE COVER, MFB
36	26083	1	HANDLE COVER
37	24940	10	SCREW, FHSC 4-40 X .25 LG., STEEL, BLACK OXIDE

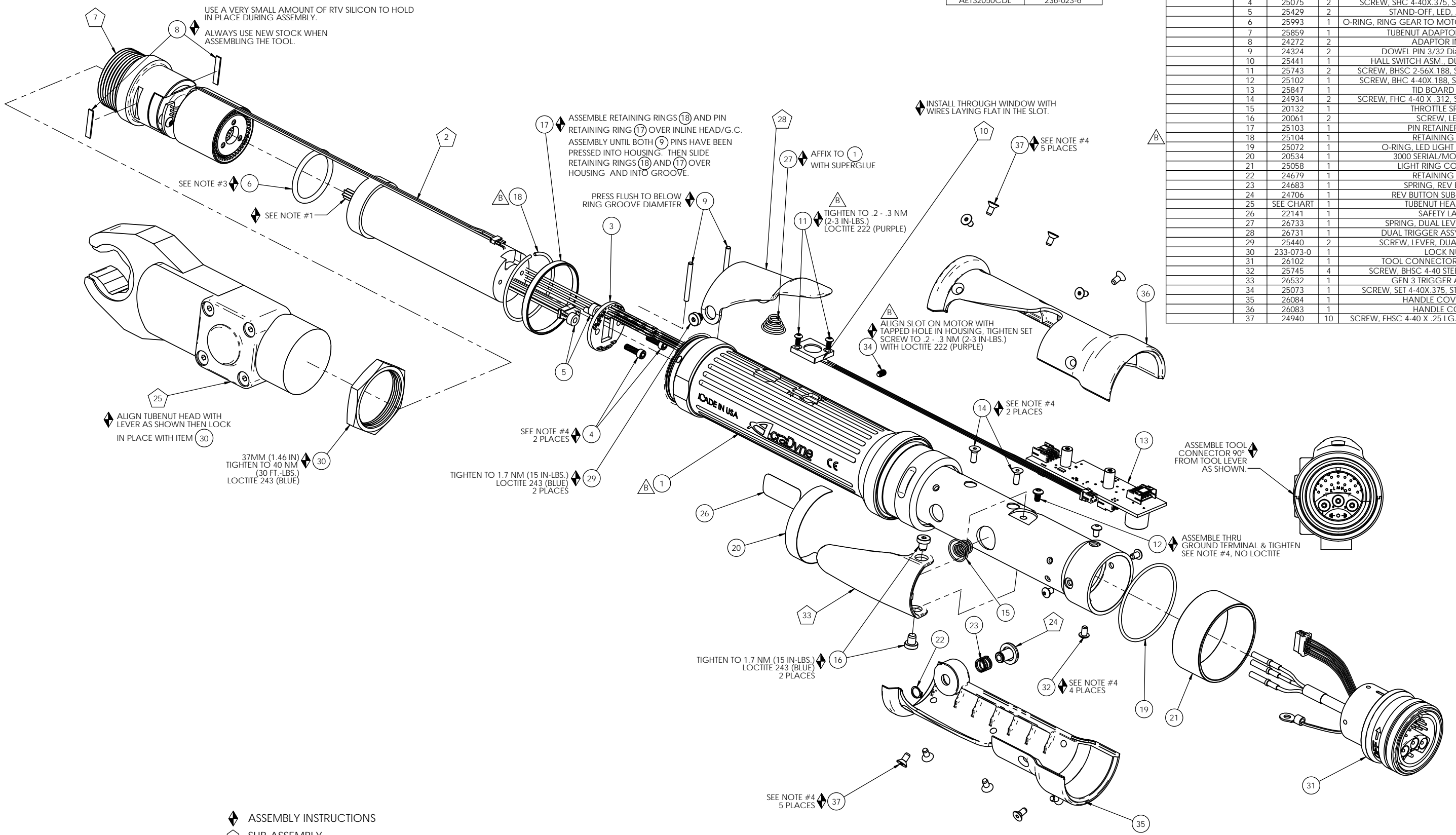

- ◆ ASSEMBLY INSTRUCTIONS
 - ◻ SUB-ASSEMBLY
- 1) GEARS & SPLINES: LUBRICATE WITH DOW CORNING MOLYKOTE BR2 PLUS GREASE.
 - 2) BEARINGS: LUBRICATE WITH CHEVRON SR1 GREASE
 - 3) O-RINGS: LUBRICATE WITH O-RING LUBE
 - △ 4) TIGHTEN TO 1.0 Nm (9 IN-LBS) LOCTITE 222 (PURPLE)

REQUIRED TOOLING
LOCTITE 243 (BLUE)
FLAT BLADE SCREW DRIVER
TORQUE SCREW DRIVERS
.050 HEX BIT
1/16 HEX BIT
5/64 HEX BIT
3/32 HEX BIT
SNAP RING PLIERS - EXTERNAL TYPE
37mm OPEN END CROWFOOT



DOCUMENT CONTROL
 PRINTED COPIES OF THIS DOCUMENT ARE CONSIDERED TO BE UNCONTROLLED DOCUMENTS. HOLDERS ARE RESPONSIBLE FOR VERIFYING THE CURRENT REVISION LEVEL WITH PURCHASING OR ENGINEERING PRIOR TO USE OR FABRICATION. THE CONTROLLED VERSION OF THIS DOCUMENT IS ELECTRONICALLY MAINTAINED.

PROPRIETARY AND CONFIDENTIAL
 THIS DRAWING CONTAINS INFORMATION STRICTLY CONFIDENTIAL TO ACRADYNE/AIMCO. IN THE ABSENCE OF EXPRESSED WRITTEN PERMISSION, ACRADYNE/AIMCO HAS LOANED THIS COPY WITH THE MUTUAL UNDERSTANDING THAT (A) IT WILL NOT BE USED FOR ANY PURPOSE OTHER THAN FOR THAT IN WHICH IT WAS PROVIDED, (B) THE DATA CONTAINED HEREIN WILL NOT BE DISCLOSED TO OTHERS, (C) IT WILL NOT BE REPRODUCED, AND (D) IT WILL BE RETURNED TO ACRADYNE/AIMCO IMMEDIATELY UPON DEMAND.

REVISION LEVEL	REVISION RELEASE DATE	DESCRIPTION OF CHANGES MADE TO PART	ECN #	AUTHOR/ APPROVAL
B	03/31/16	RETAINING RING 25104 QTY: 1 WAS QTY: 2. MOTOR HOUSING 27624 GEOMETRY UPDATED. LOCTITE 222(PURPLE) WAS LOCTITE 243 (BLUE).	1839	T BURNETT
A	12/18/13	PRODUCTION RELEASE	1062	T BURNETT

UNLESS OTHERWISE SPECIFIED, DIMENSIONS ARE IN INCHES
 DIMENSIONS AND TOLERANCING PER ANSI Y14.5 SURFACE ROUGHNESS PER ANSI Y14.36

BLOCK TOLERANCING PER DECIMAL:
 .X = ±.030 .XX = ±.010 .XXX = ±.005 .XXXX = ±.0005 ANGLE = 90°/30°

REMOVE BURRS AND SHARP EDGES: R.015 MAX MACHINE SURFACE FINISH: 125 RMS OR BETTER

DRAWINGS AND TECHNICAL DOCUMENTS CONTROLLED BY:
ACRADYNE MECHANICAL ENGINEERING

AET320_CD 2000 SERIES, GEN 3C, DUAL LEVER		
SIZE D	PART / DRAWING NUMBER AET320_CD	REVISION B
SCALE 1:1	DO NOT SCALE DRAWING	SHEET 1 OF 2

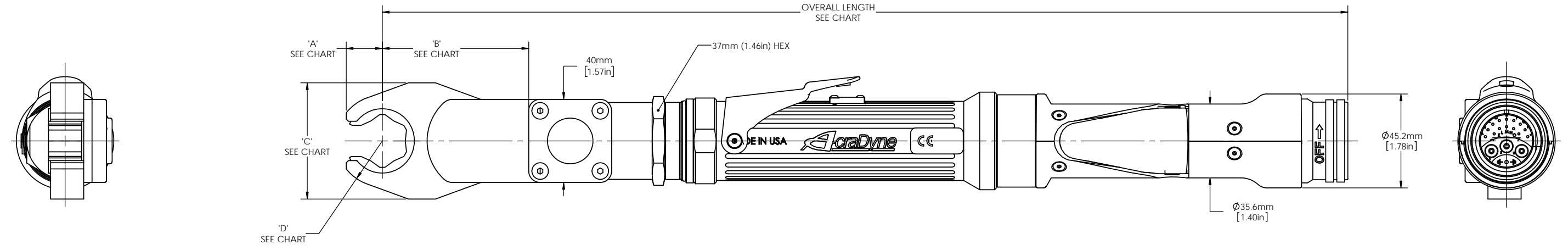
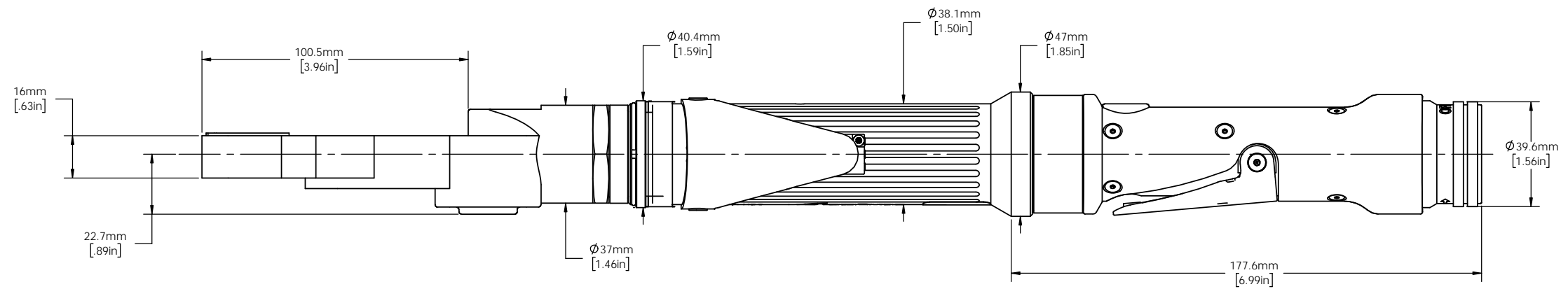

MODEL NUMBER	OVERALL LENGTH	'A'	'B'	'C'	'D'
AET32020CDL	441mm, [17.38in]	10mm, [.41in]	46mm, [1.83in]	37mm, [1.46in]	14mm, [.55in]
AET32025CDL	456mm, [17.95in]	13mm, [.52in]	61mm, [2.40in]	40mm, [1.56in]	17mm, [.67in]
AET32035CDL	466mm, [18.33in]	17mm, [.68in]	71mm, [2.78in]	56mm, [2.20in]	22mm, [.87in]
AET32050CDL	483mm, [19.02in]	22mm, [.88in]	88mm, [3.45in]	68mm, [2.68in]	29mm, [1.14in]



DOCUMENT CONTROL
 PRINTED COPIES OF THIS DOCUMENT ARE CONSIDERED TO BE UNCONTROLLED DOCUMENTS. HOLDERS ARE RESPONSIBLE FOR VERIFYING THE CURRENT REVISION LEVEL WITH PURCHASING OR ENGINEERING PRIOR TO USE OR FABRICATION. THE CONTROLLED VERSION OF THIS DOCUMENT IS ELECTRONICALLY MAINTAINED.

PROPRIETARY AND CONFIDENTIAL
 THIS DRAWING CONTAINS INFORMATION STRICTLY CONFIDENTIAL TO ACRADYNE/AIMCO. IN THE ABSENCE OF EXPRESSED WRITTEN PERMISSION, ACRADYNE/AIMCO HAS LOANED THIS COPY WITH THE MUTUAL UNDERSTANDING THAT (A) IT WILL NOT BE USED FOR ANY PURPOSE OTHER THAN FOR THAT IN WHICH IT WAS PROVIDED, (B) THE DATA CONTAINED HEREIN WILL NOT BE DISCLOSED TO OTHERS, (C) IT WILL NOT BE REPRODUCED, AND (D) IT WILL BE RETURNED TO ACRADYNE/AIMCO IMMEDIATELY UPON DEMAND.

REVISION LEVEL	REVISION RELEASE DATE	DESCRIPTION OF CHANGES MADE TO PART	ECN #	AUTHOR/ APPROVAL
B	03/31/16	RETAINING RING 25104 QTY: 1 WAS QTY: 2. MOTOR HOUSING 27624 GEOMETRY UPDATED. LOCITITE 222 (PURPLE) WAS LOCITITE 243 (BLUE).	1839	T BURNETT
A	12/18/13	PRODUCTION RELEASE	1062	T BURNETT

UNLESS OTHERWISE SPECIFIED, DIMENSIONS ARE IN INCHES
 DIMENSIONS AND TOLERANCING PER ANSI Y14.5
 SURFACE ROUGHNESS PER ANSI Y14.36

BLOCK TOLERANCING PER DECIMAL:
 .X = ±.030 .XX = ±.010 .XXX = ±.005 .XXXX = ±.0005
 ANGLE = 30°

REMOVE BURRS AND SHARP EDGES: R.015 MAX
 MACHINE SURFACE FINISH: 125 RMS OR BETTER

DRAWINGS AND TECHNICAL DOCUMENTS CONTROLLED BY:
ACRADYNE MECHANICAL ENGINEERING

AET320_CD 2000 SERIES, GEN 3C, DUAL LEVER		
SIZE	PART / DRAWING NUMBER	REVISION
D	AET320_CD	B
SCALE 1:1	DO NOT SCALE DRAWING	SHEET 2 OF 2