

TOOL MODEL NO.	TUBENUT HEAD ASM.
AET4AA22016C	235-023-0
AET4AB22021C	235-023-4
AET4AC22028C	236-023-0
AET4AD22038C	236-023-6

COMMENTS	ITEM NO.	PART NUMBER	QTY.	DESCRIPTION
	1	28766	1	MOTOR ASSEMBLY
	2	24860	1	GEAR CASE SUB-ASM 6T
	3	SEE CHART	1	TUBENUT HEAD ASM.
	4	25729	1	TUBENUT ADAPTOR ASM.
	5	233-073-0	1	LOCK NUT, GEAR CASE, OHO, S2 INTERFACE
	6	28754	1	LEVER HANDLE
	7	29186	1	COVER, LEVER HANDLE
	8	31048.002	1	TRANSDUCER SUB-ASM.
	9	25763	1	TRANSDUCER ADAPTOR
	10	24780	1	MOTOR COUPLER SUB-ASM.
	11	28767	1	TOOL CONN. ASM.
	12	30966	1	LED BOARD ASM, i2C
	13	29191	1	TRIGGER/MFG BOARD ASM., 2000-SERIES, GEN 4
	14	28753	2	MOTOR COVER, SMALL MOTOR O.D.
	15	29202	1	TRIGGER CABLE ASM., 6 PIN - 6 PIN
	16	25557	1	REV BUTTON SUB-ASSEMBLY
	17	24683	1	SPRING, REV BUTTON
	18	24679	1	RETAINING RNG
	19	29189	1	TRIGGER SUB-ASM.
	20	28760	1	LED COVER
	21	27235	2	O-RING, BUNA-N, #28
	22	22141	1	SAFETY LABEL
	23	20132	1	THROTTLE SPRING
	24	31051	1	DOWEL PIN, Ø.094 X .75, GROOVED, STEEL, ZINC PLATED
	25	23753	8	SCREW, FHSC 6-32x5/16, 18-8 SS
	26	20534	1	2000 SERIAL/MODEL LABEL
	27	23741	1	SHIM, OUTPUT, .002 IN, 40 NM
	28	21022	1	SHIM, BLANK OUTPUT SHAFT, 0.005 THK
	29	21021	1	SHIM, BLANK OUTPUT SHAFT, 0.010 THK
	30	24935	2	SCREW, SHC 4-40 X .25, STEEL, BLACK OXIDE
	31	25745	5	SCREW, BHSC 4-40 STEEL, BLACK OXIDE
	32	29184	2	DOWEL PIN, Ø.094 X .25, PLASTIC
	33	31061	2	DOWEL PIN, Ø3/32 X 1/4, STEEL
	34	26078	4	SCREW, SHC 4-40 X 5/16, BLK OXIDE
NOT SHOWN	35	28257	A/R	CABLE TIE, 1.65mm X 71mm
	36	25471	1	LABEL SN# Cover, .25 X 4"

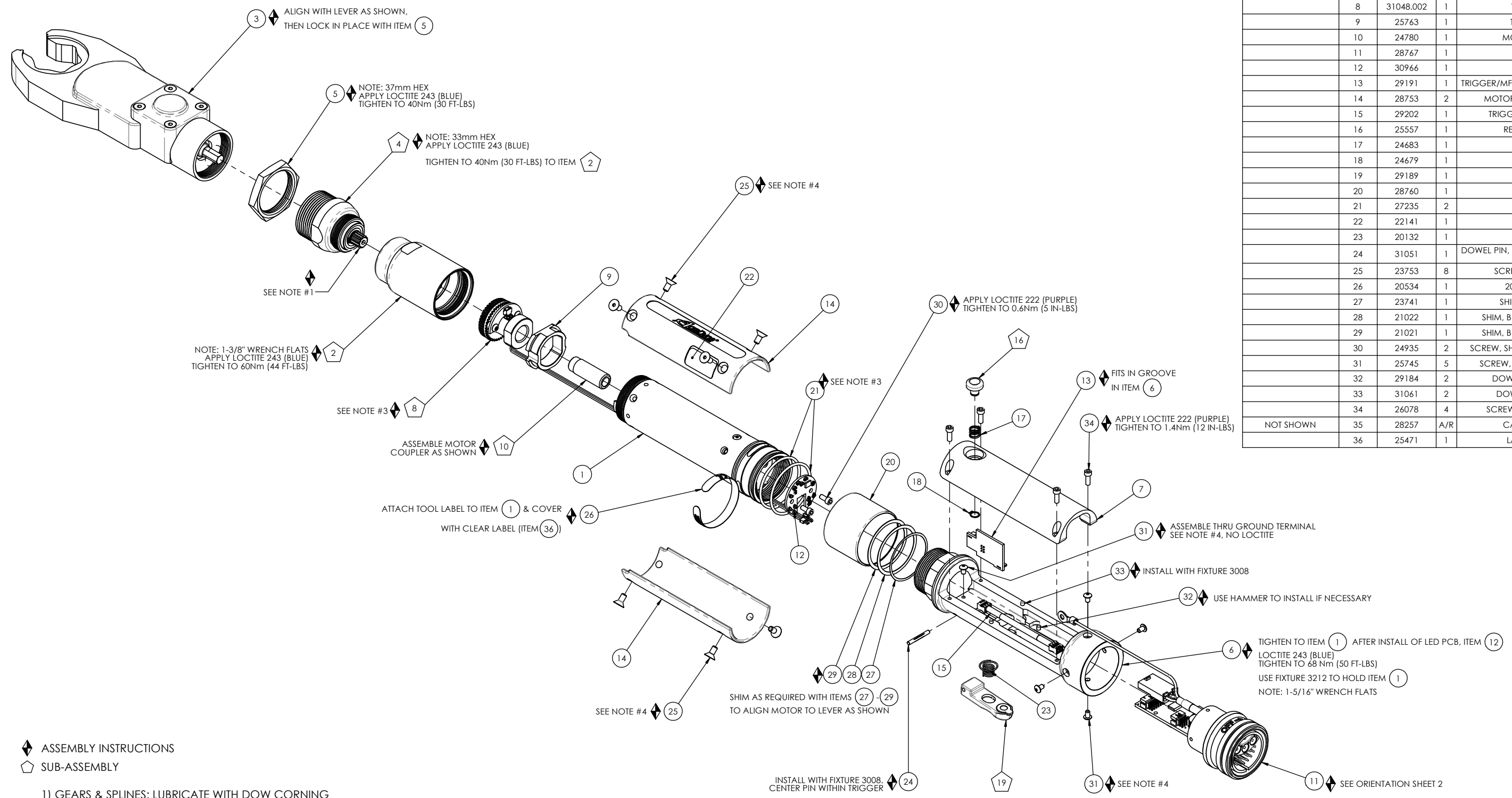

- ◆ ASSEMBLY INSTRUCTIONS
- ◊ SUB-ASSEMBLY

- 1) GEARS & SPLINES: LUBRICATE WITH DOW CORNING MOLYKOTE BR2 PLUS GREASE.
- 2) BEARINGS: LUBRICATE WITH CHEVRON SR1 GREASE
- 3) O-RINGS: LUBRICATE WITH O-RING LUBE
- 4) TIGHTEN TO 1.0 Nm (9 IN-LBS.) LOCTITE 222 (PURPLE)



DOCUMENT CONTROL
 PRINTED COPIES OF THIS DOCUMENT ARE CONSIDERED TO BE UNCONTROLLED DOCUMENTS. HOLDERS ARE RESPONSIBLE FOR VERIFYING THE CURRENT REVISION LEVEL WITH PURCHASING OR ENGINEERING PRIOR TO USE OR FABRICATION. THE CONTROLLED VERSION OF THIS DOCUMENT IS ELECTRONICALLY MAINTAINED.

PROPRIETARY AND CONFIDENTIAL
 THIS DRAWING CONTAINS INFORMATION STRICTLY CONFIDENTIAL TO ACRADYNE/AIMCO. IN THE ABSENCE OF EXPRESSED WRITTEN PERMISSION, ACRADYNE/AIMCO HAS LOANED THIS COPY WITH THE MUTUAL UNDERSTANDING THAT (A) IT WILL NOT BE USED FOR ANY PURPOSE OTHER THAN FOR THAT IN WHICH IT WAS PROVIDED, (B) THE DATA CONTAINED HEREIN WILL NOT BE DISCLOSED TO OTHERS, (C) IT WILL NOT BE REPRODUCED, AND (D) IT WILL BE RETURNED TO ACRADYNE/AIMCO IMMEDIATELY UPON DEMAND.

REVISION LEVEL	REVISION RELEASE DATE	ECN #	AUTHOR/ APPROVAL

UNLESS OTHERWISE SPECIFIED, DIMENSIONS ARE IN INCHES
 DIMENSIONS AND TOLERANCING PER ANSI Y14.5 SURFACE ROUGHNESS PER ANSI Y14.36

BLOCK TOLERANCING PER DECIMAL:
 .X = ±.030 .XX = ±.010 .XXX = ±.005 .XXXX = ±.0005
 ANGLE = ±0° 30'

REMOVE BURRS AND SHARP EDGES: R.015 MAX MACHINE SURFACE FINISH: 125 RMS OR BETTER

DRAWINGS AND TECHNICAL DOCUMENTS CONTROLLED BY:
ACRADYNE MECHANICAL ENGINEERING

TUBENUT NUTRUNNER

GEN 4 2000 SERIES

SIZE	PART / DRAWING NUMBER	REVISION
D	AET4A 220 C	A

SCALE: 1:1 DO NOT SCALE DRAWING SHEET 1 OF 2

REVISION BLOCK

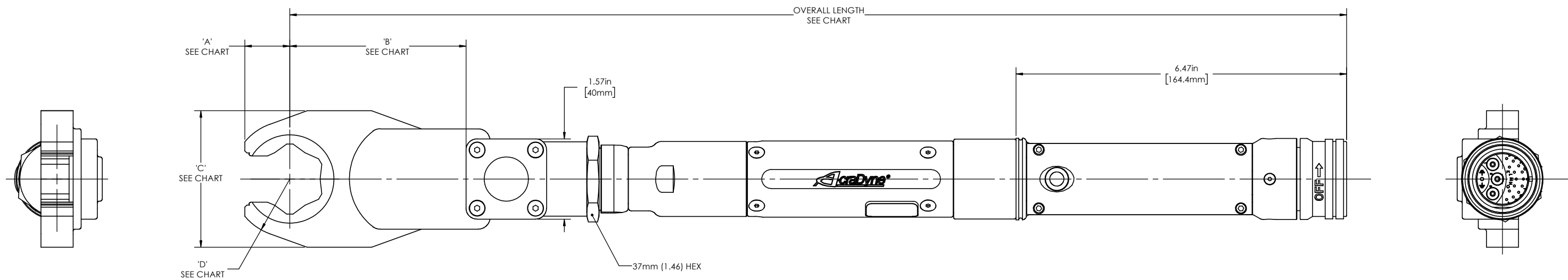
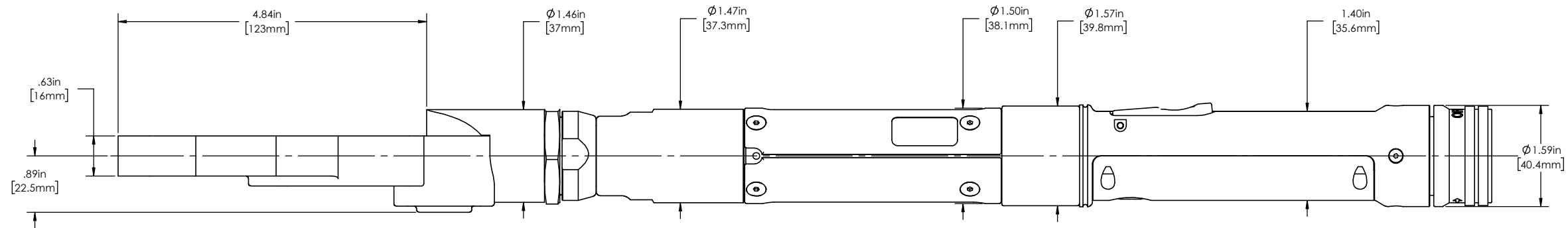

TOOL MODEL NO.	OVERALL LENGTH	'A'	'B'	'C'	'D'
AET4AA22016C	484.25mm, [19.07in]	10mm, [.41in]	46mm, [1.83in]	37mm, [1.46in]	14mm, [.55in]
AET4AB22021C	498.73mm, [19.64in]	13mm, [.52in]	61mm, [2.40in]	40mm, [1.56in]	17mm, [.67in]
AET4AC22028C	508.38mm, [20.02in]	17mm, [.68in]	71mm, [2.78in]	56mm, [2.20in]	22mm, [.87in]
AET4AD22038C	525.91mm, [20.71in]	22mm, [.88in]	88mm, [3.45in]	68mm, [2.68in]	29mm, [1.14in]



DOCUMENT CONTROL
 PRINTED COPIES OF THIS DOCUMENT ARE CONSIDERED TO BE UNCONTROLLED DOCUMENTS. HOLDERS ARE RESPONSIBLE FOR VERIFYING THE CURRENT REVISION LEVEL WITH PURCHASING OR ENGINEERING PRIOR TO USE OR FABRICATION. THE CONTROLLED VERSION OF THIS DOCUMENT IS ELECTRONICALLY MAINTAINED.

PROPRIETARY AND CONFIDENTIAL
 THIS DRAWING CONTAINS INFORMATION STRICTLY CONFIDENTIAL TO ACRADYNE/AIMCO. IN THE ABSENCE OF EXPRESSED WRITTEN PERMISSION, ACRADYNE/AIMCO HAS LOANED THIS COPY WITH THE MUTUAL UNDERSTANDING THAT (A) IT WILL NOT BE USED FOR ANY PURPOSE OTHER THAN FOR THAT IN WHICH IT WAS PROVIDED, (B) THE DATA CONTAINED HEREIN WILL NOT BE DISCLOSED TO OTHERS, (C) IT WILL NOT BE REPRODUCED, AND (D) IT WILL BE RETURNED TO ACRADYNE/AIMCO IMMEDIATELY UPON DEMAND.

REVISION LEVEL	REVISION RELEASE DATE	DESCRIPTION OF CHANGES MADE TO PART	ECN #	APPROVAL

UNLESS OTHERWISE SPECIFIED, DIMENSIONS ARE IN INCHES
 DIMENSIONS AND TOLERANCING PER ANSI Y14.5
 SURFACE ROUGHNESS PER ANSI Y14.36

BLOCK TOLERANCING PER DECIMAL:
 .X = ±.030 .XX = ±.010 .XXX = ±.005 .XXXX = ±.0005
 ANGLE = ±0° 30'

REMOVE BURRS AND SHARP EDGES: R.015 MAX
 MACHINE SURFACE FINISH: 125 RMS OR BETTER

DRAWINGS AND TECHNICAL DOCUMENTS CONTROLLED BY:
ACRADYNE MECHANICAL ENGINEERING

TUBENUT NUTRUNNER

GEN 4 2000 SERIES

SIZE	PART / DRAWING NUMBER	REVISION
D	AET4A 220 C	A

SCALE: 1:1 DO NOT SCALE DRAWING SHEET 2 OF 2