

COMMENTS	ITEM NO.	PART NUMBER	QTY.	DESCRIPTION
	1	UXR-1820(124T5)	1	HANDLE & MOTOR ASSY.
	2	195-867-9	1	GASKET
	3	27752	1	CLUTCH PINION ADAPTER, HT AIR TOOLS
	4	BB69032RS	1	BALL BEARING, DBL. SEAL, ABEC-1
	5	28300	1	CLUTCH ADAPTER HT AIR TOOLS
	6	28454	4	SCREW, BHSC, M6 X 20mm, STEEL
	7	28291	1	CLUTCH PLATE ASSY, HT AIR TOOLS
	8	28174	4	SPRING, COMPRESSION
	9	20105	4	DETENT BALL
	10	26488	1	O-RING, MOTOR HOUSING
	11	27744	1	CLUTCH DETENT PLATE
	12	26162	4	SCREW, SHC, 6-32 X 9/16, STEEL
	13	26299	1	O-RING, PINION
	14	28198	1	GEARBOX ASSY, 1.55.018:1, HT AIR TOOLS
	15	26460	6	SCREW, BHSC 8-32x.38, 316 SS
	16	26495	1	GEAR CASE COVER
	17	26319	3	SCREW, BHSC 6-32 X .188, 18-8 SS
	18	27913	1	LABEL, 950Nm, HT AIR TOOLS
	19	26896	1	CHOOSE REACTION BAR
	20	26514	1	RETAINING RING, SPIRAL, Ø2.441 X Ø2.105 X .078

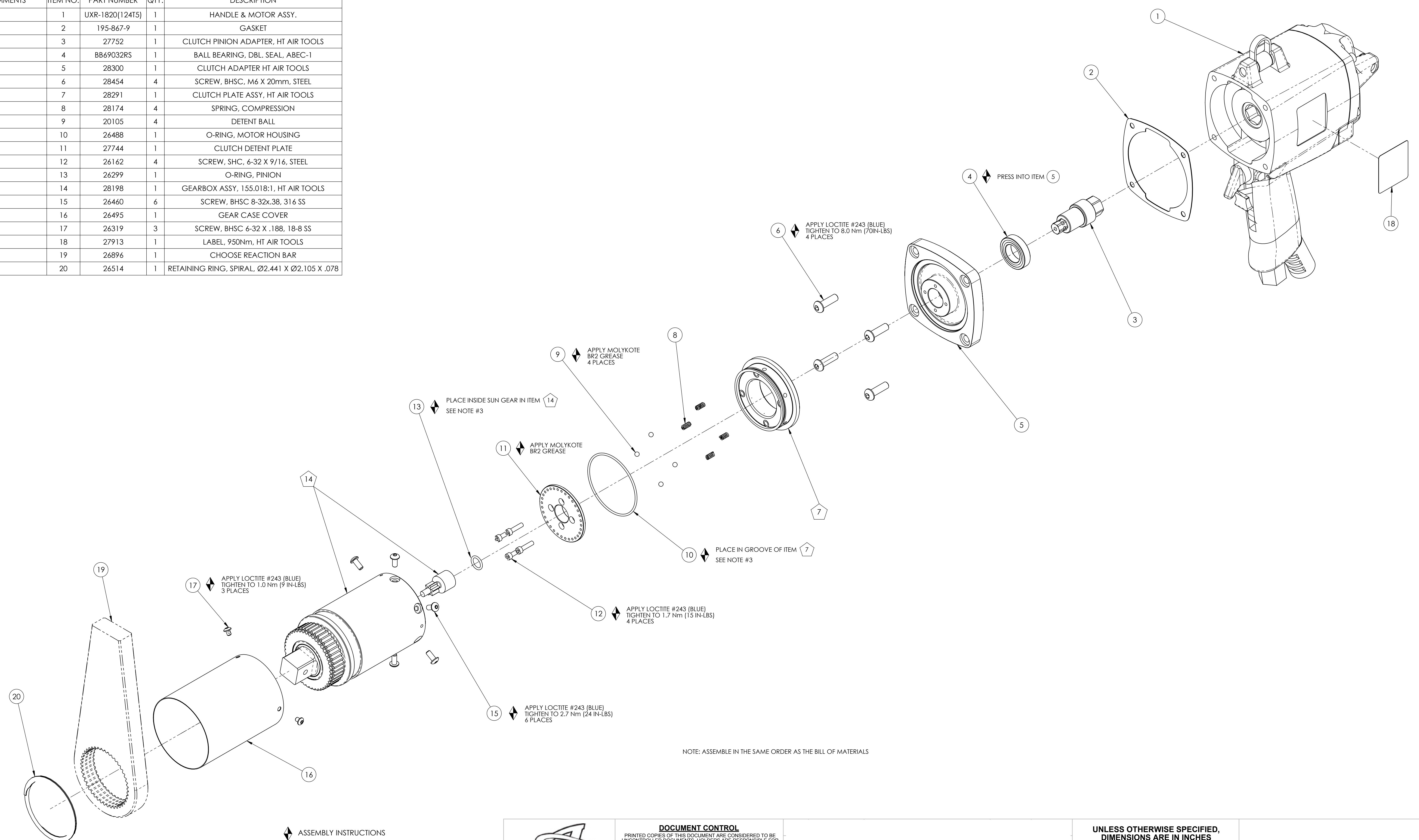

NOTE: ASSEMBLE IN THE SAME ORDER AS THE BILL OF MATERIALS

- ◆ ASSEMBLY INSTRUCTIONS
- ◊ SUB-ASSEMBLY
- 1) GEARS & SPLINES: LUBRICATE WITH DOW CORNING MOLYKOTE BR2 PLUS GREASE.
- 2) BEARINGS: LUBRICATE WITH CHEVRON SR1 GREASE
- 3) O-RINGS: LUBRICATE WITH O-RING LUBE



**DOCUMENT CONTROL**  
 PRINTED COPIES OF THIS DOCUMENT ARE CONSIDERED TO BE UNCONTROLLED DOCUMENTS. HOLDERS ARE RESPONSIBLE FOR VERIFYING THE CURRENT REVISION LEVEL WITH PURCHASING OR ENGINEERING PRIOR TO USE OR FABRICATION. THE CONTROLLED VERSION OF THIS DOCUMENT IS ELECTRONICALLY MAINTAINED.

**PROPRIETARY AND CONFIDENTIAL**  
 THIS DRAWING CONTAINS INFORMATION STRICTLY CONFIDENTIAL TO ACRADYNE/AIMCO. IN THE ABSENCE OF EXPRESSED WRITTEN PERMISSION, ACRADYNE/AIMCO HAS LOANED THIS COPY WITH THE MUTUAL UNDERSTANDING THAT (A) IT WILL NOT BE USED FOR ANY PURPOSE OTHER THAN FOR THAT IN WHICH IT WAS PROVIDED, (B) THE DATA CONTAINED HEREIN WILL NOT BE DISCLOSED TO OTHERS, (C) IT WILL NOT BE REPRODUCED, AND (D) IT WILL BE RETURNED TO ACRADYNE/AIMCO IMMEDIATELY UPON DEMAND.

REVISION LEVEL	REVISION RELEASE DATE	DESCRIPTION OF CHANGES MADE TO PART	ECN #	AUTHOR/ APPROVAL
<b>REVISION BLOCK</b>				

**UNLESS OTHERWISE SPECIFIED, DIMENSIONS ARE IN INCHES**  
 DIMENSIONS AND TOLERANCING PER ANSI Y14.5  
 SURFACE ROUGHNESS PER ANSI Y14.36

**BLOCK TOLERANCING PER DECIMAL:**  
 X = ±.030 XX = ±.010 XXX = ±.005 XXXX = ±.0005  
 ANGLE = ±0° 30'

REMOVE BURRS AND SHARP EDGES: R.015 MAX  
 MACHINE SURFACE FINISH: 125 RMS OR BETTER

DRAWINGS AND TECHNICAL DOCUMENTS CONTROLLED BY:  
**ACRADYNE MECHANICAL ENGINEERING**

HT AIR PISTOL NUTRUNNER		
PRODUCT INFORMATION		
SIZE	PART / DRAWING NUMBER	REVISION
D	AAP1B76950A	A
SCALE 2:3	DO NOT SCALE DRAWING	SHEET 1 OF 2

8 7 6 5 4 3 2 1

F E D C B A

**NOTE:  
REACTION BAR GEOMETRY  
TO CHANGE DEPENDING  
ON REACTION BAR CHOSEN**

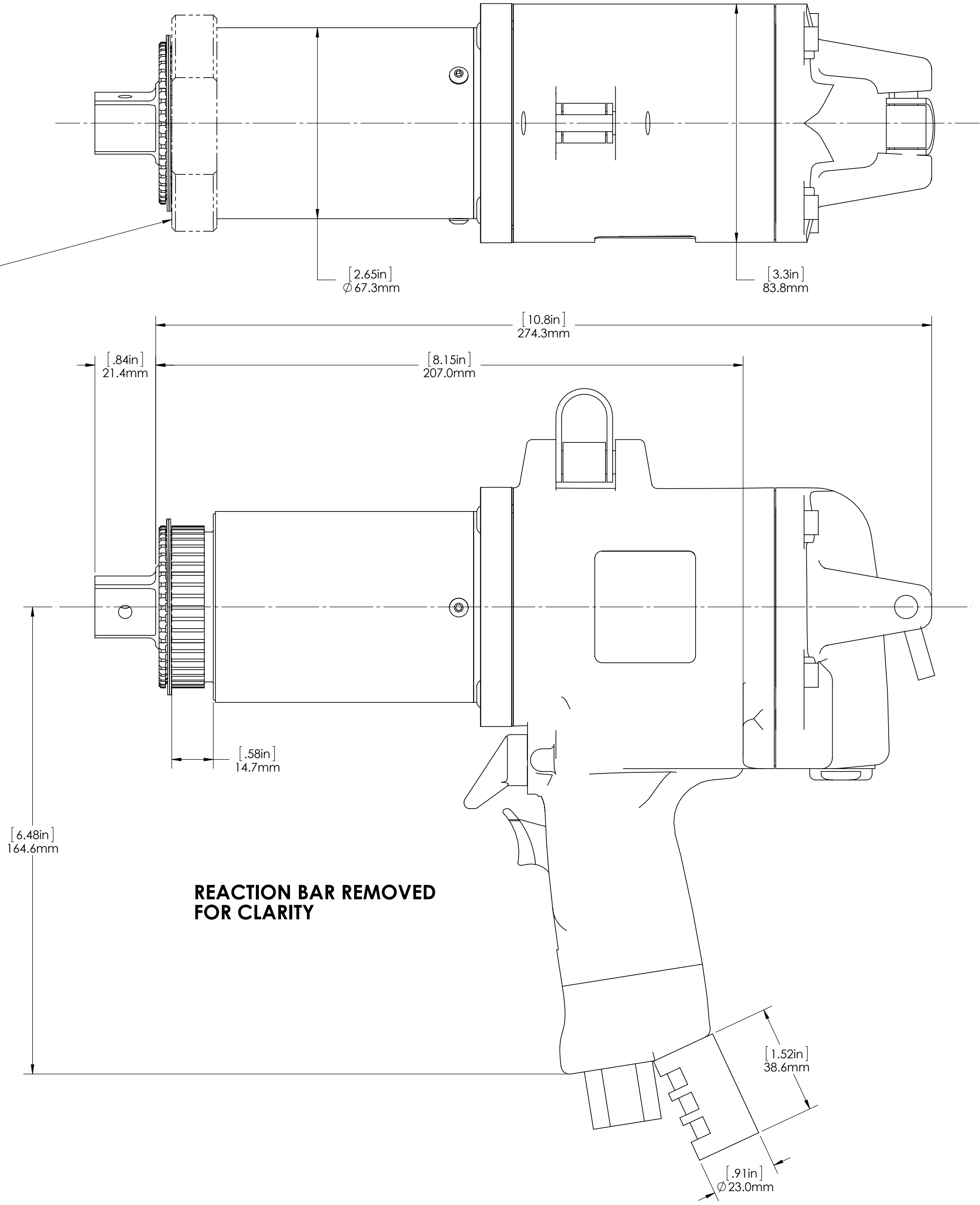
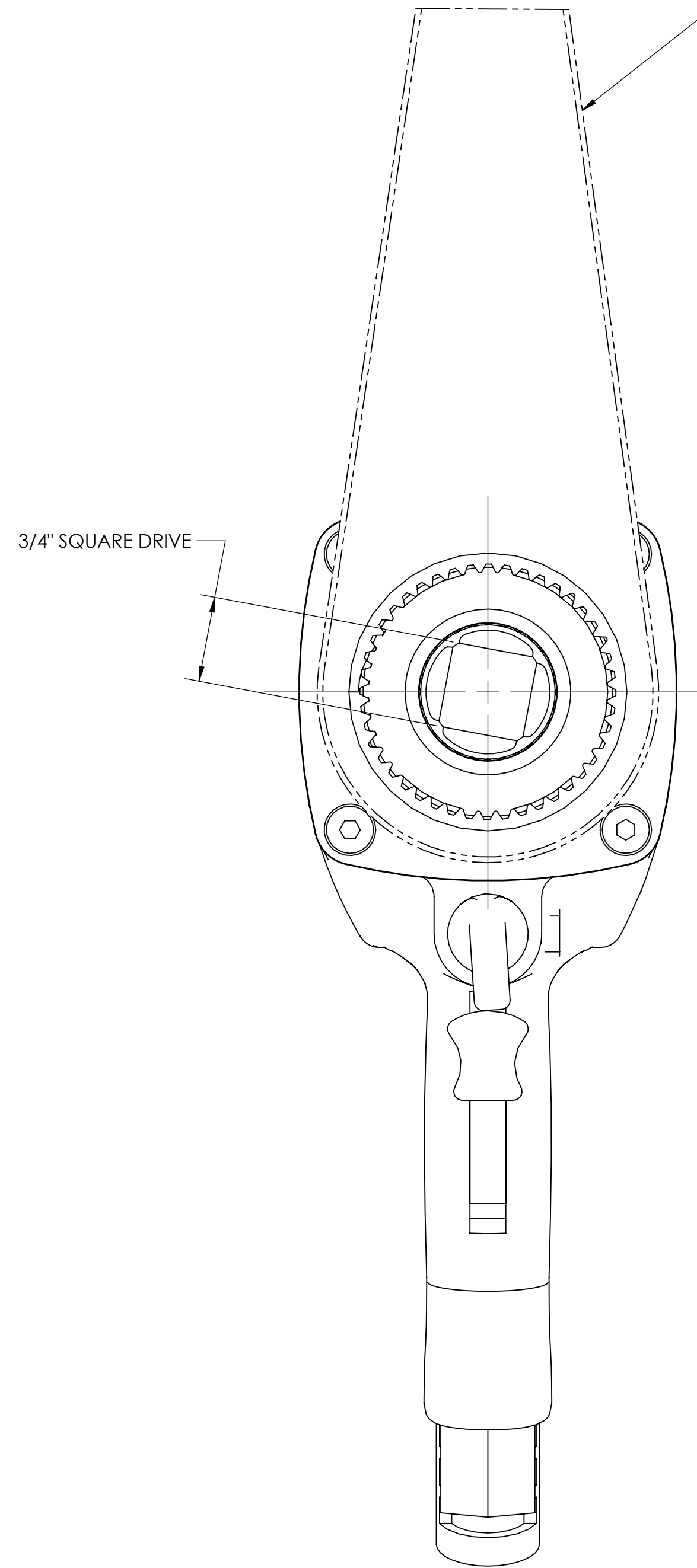

**DOCUMENT CONTROL**  
PRINTED COPIES OF THIS DOCUMENT ARE CONSIDERED TO BE UNCONTROLLED DOCUMENTS. HOLDERS ARE RESPONSIBLE FOR VERIFYING THE CURRENT REVISION LEVEL WITH PURCHASING OR ENGINEERING PRIOR TO USE OR FABRICATION. THE CONTROLLED VERSION OF THIS DOCUMENT IS ELECTRONICALLY MAINTAINED.

**PROPRIETARY AND CONFIDENTIAL**  
THIS DRAWING CONTAINS INFORMATION STRICTLY CONFIDENTIAL TO ACRADYNE/AIMCO. IN THE ABSENCE OF EXPRESSED WRITTEN PERMISSION, ACRADYNE/AIMCO HAS LOANED THIS COPY WITH THE MUTUAL UNDERSTANDING THAT (A) IT WILL NOT BE USED FOR ANY PURPOSE OTHER THAN FOR THAT IN WHICH IT WAS PROVIDED, (B) THE DATA CONTAINED HEREIN WILL NOT BE DISCLOSED TO OTHERS, (C) IT WILL NOT BE REPRODUCED, AND (D) IT WILL BE RETURNED TO ACRADYNE/AIMCO IMMEDIATELY UPON DEMAND.

REVISION LEVEL	REVISION RELEASE DATE	DESCRIPTION OF CHANGES MADE TO PART	ECN #	AUTHOR/ APPROVAL
<b>REVISION BLOCK</b>				

**UNLESS OTHERWISE SPECIFIED,  
DIMENSIONS ARE IN INCHES**  
DIMENSIONS AND TOLERANCING PER ANSI Y14.5  
SURFACE ROUGHNESS PER ANSI Y14.36

**BLOCK TOLERANCING PER DECIMAL:**  
X = ±.030 XX = ±.010 XXX = ±.005 XXXX = ±.0005  
ANGLE = ±0° 30'

REMOVE BURRS AND SHARP EDGES: R.015 MAX  
MACHINE SURFACE FINISH: 125 RMS OR BETTER

**DRAWINGS AND TECHNICAL DOCUMENTS CONTROLLED BY:  
ACRADYNE MECHANICAL ENGINEERING**

<b>HT AIR PISTOL NUTRUNNER</b>		
<b>7000 SERIES</b>		
SIZE	PART / DRAWING NUMBER	REVISION
<b>D</b>	<b>AAP1B76950A</b>	<b>A</b>
SCALE 1:1	DO NOT SCALE DRAWING	SHEET 2 OF 2

8 7 6 5 4 3 2 1